

LIBER 21028 577
M. Ford

LAND CORNER RECORDATION CERTIFICATE
Filing Requirement of Act 74, Mich. P.A. 1970

25902

For corners in

Oakland
(County)

Located in:

Corner Code #

LIBER 21028 PAGE 577
\$9.00 MISC RECORDING
\$2.00 REMONUMENTATION
01/27/2000 08:21:22 A.M. RECEIPT# 6667
PAID RECORDED - OAKLAND COUNTY
G. WILLIAM CABELL, CLERK/REGISTER OF DEEDS

1. Public Land Survey

T2N R 7E I-7

T R

T R

T R

2. Property Controlling in Section

S T R

S T R

3. Miscellaneous Property in Sec.

S T R

S T R

SURVEY &
REMONUMENTATION

MAR 21 2000

Compliance with
ACT 345, P.A. 1990

APPROVED ON: 7-14-99 JK
OAKLAND COUNTY REMONUMENTATION
PEER GROUP COMMITTEE
Register of Deeds Stamp & File Number

4. Lot No. _____, Recorded Plat _____ SECTION _____

5. Private Claims _____

I, Grant J. Ward, R.L.S., in a field survey on June 15, 1998 do hereby state that under requirements of P.A. 74, Michigan P.A. of 1970, the corner points mentioned in lines 1 and 2 above were in conformance with regulations and rules therefore as required in the current manual of survey instructions of the United States Department of the Interior, Bureau of Land Management or by a decree of a Court of Law and/or that the corner points mentioned in lines 3, 4 and 5 above were in conformance with the rules of the Michigan Board of Land Surveyors or by a Decree of a Court of Law; established, re-established, monumented, recovered, found as expressed below:

NOTE: Not more than 2 corners, all in the same town and range, may be recorded on this certificate.

	A	B	C	D	E	F	G	H	I	J	K	L
1												
2	6			5			4		3			2
3												
4	7			8			9		10			11
5												
6	18			17			16		15			14
7												
8	19			20			21		22			23
9												
10	30			29			28		27			26
11												
12	31			32			33		34			35
13												

A. Description of original monument and accessories and/or subsequent restoration:

I-7 Post, per G.L.O. Notes.

2P
R

B. Description of corner evidence found and/or method applied in restoring or reestablishing corner:

I-7 Northeast Corner of Section 22, T. 2 N., R. 7 E. Found 1/2" Iron Rod 4' East of Centerline of South Hill Road and in Centerline of Dawson Road.

Previously Recorded in L. 6060 P. 012 (3) of Oakland County Records.

(n) Indicates the number of references that confirms this corner by dimensional tie.

This corner location is accepted by the contractor and is generally accepted by professional surveyors as the best available evidence of the position of the original corner.

C. Description of monument for corner and accessories established to perpetuate locating the position of the corner:

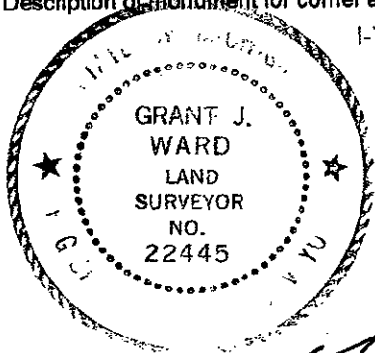

- I-7 Set 5/8" Iron Rod & Remonumentation Cap.
- N 50° E 35.29' Set PK Nail & Remonumentation Disc in Northwest face of Utility Pole.
- S 35° E 51.50' Set PK Nail & Remonumentation Disc in Southwest face of 12" Walnut.
- S 50° W 50.96' Set PK Nail & Remonumentation Disc in Northwest face of Utility Pole.
- N 35° W 46.39' Set PK Nail & Remonumentation Disc in Northeast face of Utility Pole.

Signed by _____
Surveyor's Michigan License No. 22445

Date July 12, 1999

JULY 3, 1999

Corner Code: I-7

DOSSIER FOR: THE SOUTHEAST CORNER OF SECTION 15, MILFORD TOWNSHIP, T 2 N, R 7 E, OAKLAND COUNTY, MICHIGAN. Prepared under contract with the County of Oakland Under Act 345 of the Public Acts of 1990.

HISTORY:

This Corner has been accepted and used since before 1973 as witnessed by Bernard Feldhauser, surveyor, as recorded in Liber 6060, Page 12 under Act 74 of the Public Acts of 1970.

COLLATERAL EVIDENCE:

This Corner lies 4 feet East of the Centerline of South Hill Road and Dawson Road. We set a 5/8" iron rod and remonumentation cap in place of the 1/2" iron rod we found. We measured 0.18 feet less than the recorded distance to the South 1/4 Corner and 0.07 feet less than the recorded distance to the West 1/4 Corner of Section 14.

SURVEYOR'S RECOMMENDATIONS:

This corner location is accepted by the Contractor and is generally accepted by Professional Surveyors as the best available evidence of the position of the original Corner. Therefore, I recommend that the Peer Review Group accept this Corner as monumented, with the references as shown on the enclosed form prepared according to Act 74 of the Public Acts of 1970.

Grant J. Ward, R.L.S.
License No. 22445

SURVEY &
REMONUMENTATION

MAR 21 2000

SECTION