

COPY

SURVEY & REMONUMENTATION

LIBER 15397 PAGE 585

MAY 11 1995 084076

MAY 16 1996

COMMISSION LAND CORNER RECORDATION CERTIFICATE

Filing Requirement of Act 74, Mich. P.A. 1970 7.00 MISCELLANEOUS RECORDING

For corners in Oakland Commerce Twp. Located In: Corner Code #/

\$ 2.00 REMONUMENTATION 11 MAY 95 9:04 A.M. RECEIPT# 12B PAID RECORDED - OAKLAND COUNTY LYNN D. ALLEN, CLERK/REGISTER OF DEEDS

Compliance with ACT 345, P.A. 1990 APPROVED ON: 1-23-95 OAKLAND COUNTY REMONUMENTATION PEER GROUP COMMITTEE Register of Deeds Stamp & File Number

- 1. Public Land Survey T 2N R 8E A-13
2. Property Controlling in Section S T R
3. Miscellaneous Property in Sec. S T R
4. Lot No. , Recorded Plat
5. Private Claims

Grid table with columns A-M and rows 2-13. Numbers 1-36 are placed in the grid cells.

I, David Pawlaczyk, in a field survey on December 5, 1994, do hereby certify that under requirements of P.A. 74, Michigan P.A. of 1970, the corner points mentioned in lines 1 and 2 above were in conformance with regulations and rules therefore as required in the current manual of survey instructions of the United States Department of the Interior, Bureau of Land Management or by a decree of a Court of Law and/or that the corner points mentioned in lines 3, 4 and 5 above were in conformance with the rules of the Michigan Board of Land Surveyors or by a Decree of a Court of Law; established, re-established, monumented, re-monumented, recovered, found as expressed below:

NOTE: Not more than 4 corners, all in the same town and range, may be recorded on this certificate.

A. Description of original monument and accessories and/or subsequent restoration:

Table with columns: Date, Monument Type, G.L.O., Surveyor, Notes. Includes entries for 1816 Post, 1948 Iron pin, 1978 N/A, 1988 1/2" iron, 1989 3/4" Pipe, 1992 1/2" Re-rod.

Handwritten signature/initials.

B. Description of corner evidence found and/or method applied in restoring or reestablishing corner:

A 1/2" iron rod in an existing monument box in asphalt pavement currently occupies this corner. The following ties were used to recover and verify its position: 2 ties from L.C.R.C. L10682 P568 3 ties from L.C.R.C. L13232 P210

NOTE: A wire fence line extends due north from this corner.

Field measurements were made between the following corners:

Table with columns: Corner pair, Distance, meas., G.L.O., Notes. Includes entries for A-13 to A-12, 2593.92, 2640.00, 2594.01.

C. Description of monument for corner and accessories established to perpetuate locating the position of the corner:

I placed a 2" diameter brass cap stamped "Oakland County Remonumentation P.S. #17632" on the existing 1/2" iron rod in an existing monument box in asphalt pavement. N.59° E. 64.12' P.K. nail and O.C.R. tag in N.W. face D.E. pole S.55° E. 65.35' P.K. Nail and O.C.R. tag in N.E. face D.E. pole S.41° W. 50.37' P.K. nail and O.C.R. tag in N.W. face D.E. pole Due West 32.98' 3/4" Iron pipe in monument box N.38° W. 115.16' S.W. corner foundation house #51424

The selected location is accepted by me and generally accepted by Professional Surveyors as the best available evidence of the position of the original corner.

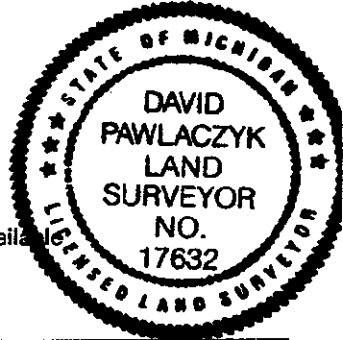

Signed by [Signature] Surveyor's Michigan License No. 17632

Date 2-16-95

OK - T. SMITH