

**SURVEY & REMONUMENTATION**

LIBER 15288 PG 523

MAR 10 95 040437

MAY - 1 1995

**LAND CORNER RECORDATION CERTIFICATE**

Filing Requirement of Act 74, Mich. P.A. 1970

Commerce Twp.

\$ 7.00 MISC RECORDING CHG - IN HOUSE  
 2.00 REMON CHG - IN HOUSE  
 MAR 95 4:04 P.M. RECEIPT# 1778  
 PAID RECORDED - OAKLAND COUNTY  
 LYNN D. ALLEN, CLERK/REGISTER OF DEEDS

For corners in **COMMISSION**  
 Oakland

(County) Located In: Corner Code #

1. Public Land Survey	T <u>2N</u> R <u>8E</u>	<u>B-1</u>
	T _____ R _____	_____
	T _____ R _____	_____
	T _____ R _____	_____
2. Property Controlling in Section	S _____ T _____ R _____	_____
	S _____ T _____ R _____	_____
3. Miscellaneous Property in Sec.	S _____ T _____ R _____	_____
	S _____ T _____ R _____	_____

4. Lot No. \_\_\_\_\_, Recorded Plat \_\_\_\_\_

5. Private Claims \_\_\_\_\_

Compliance with ACT 345, P.A. 1990  
 12-27-94  
 APPROVED ON: \_\_\_\_\_  
**OAKLAND COUNTY REMONUMENTATION PEER GROUP COMMITTEE**  
**OK - T. SMITH**  
 Register of Deeds Stamp & File Number

I, David Pawlaczyk, in a field survey on December 15, 1994, do hereby certify that under requirements of P.A. 74, Michigan P.A. of 1970, the corner points mentioned in lines 1 and 2 above were in conformance with regulations and rules therefore as required in the current manual of survey instructions of the United States Department of the Interior, Bureau of Land Management or by a decree of a Court of Law and/or that the corner points mentioned in lines 3, 4 and 5 above were in conformance with the rules of the Michigan Board of Land Surveyors or by a Decree of a Court of Law; established, re-established, monumented, re-monumented, recovered, found as expressed below:

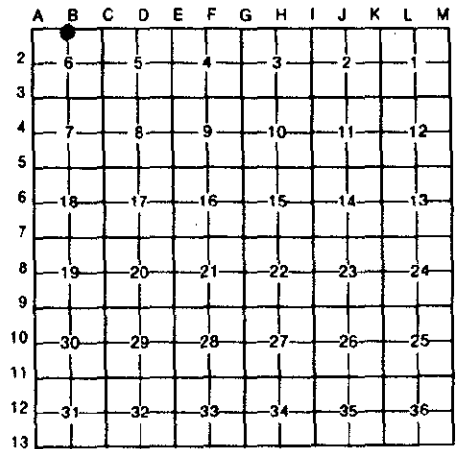

**NOTE: Not more than 4 corners, all in the same town and range, may be recorded on this certificate.**

A. Description of original monument and accessories and/or subsequent restoration:

1973 Iron re-rod	Survey	R. Kostecke	#12584	L6203 P618
1974 1/2" iron	L.C.R.C.	G. Stonerock	#13601	L6335 P74
1974 1/2" iron	Survey	G. Stonerock	#13601	L6335 P64
1978 3/8" Re-rod	L.C.R.C.	A. Leach	#7236	L7298 P130
1984 Iron re-rod	Survey	R. Kostecke	#12584	L8672 P292

B. Description of corner evidence found and/or method applied in restoring or reestablishing corner:

A 1/2" iron rod in a gravel road at the intersection of Cooley Lake and Ford Roads currently occupies this corner. The following witness ties were used to recover and verify its current position:  
 1 tie matches witness from L.C.R.C. L6335 P74

Field measurements were made between the following corners:

A-1 to B-1	2865.83	meas.		
	2970.00	rec.	G.L.O.	Notes
	2866.09	rec.	Prop. Desc.	Oakland County Planning
B-1 to C-1	2660.96	meas.		
	2662.50	rec.	Prop. desc.	Oakland County Planning
B-1 to B-13	281.34	meas.		
	281.46	rec.	Prop. desc.	Oakland County Planning

C. Description of monument for corner and accessories established to perpetuate locating the position of the corner:

I placed a 2" diameter brass cap stamped "Oakland County Remonumentation P.S. #17632" on an existing 1/2" iron rod in a gravel road.

East	281.34'	Found 1/2" iron rod
S.53° E.	61.47'	P.K. nail and O.C.R. tag S.W. face D.E. pole
S.49° W.	59.79'	P.K. nail and O.C.R. tag N.W. face utility pole
N.81° W.	84.31'	P.K. nail and O.C.R. tag S. face 30" Oak
N.48° W.	55.36'	P.K. nail and O.C.R. tag S.W. face 38" Oak
N.30° W.	21.34'	P.K. nail and O.C.R. tag S.W. face 16" Cherry

The selected location is accepted by me and generally accepted by Professional Surveyors as the best available evidence of the position of the original corner.

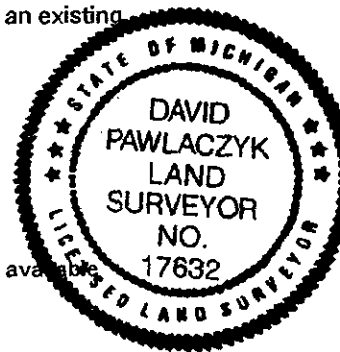

Signed by [Signature] Date 2-16-95  
 Surveyor's Michigan License No. 17632