

LAND CORNER RECORDATION CERTIFICATE
 Filing Requirement of Act 74, Mich. P.A. 1970

For corners in

<u>Oakland</u> (county)	Located In:	Corner Code #
1. Public Land Survey	T 2N R 8E	B-11
	T R	
	T R	
	T R	
2. Property Controlling in Section	S T R	
	S T R	
3. Miscellaneous Property in Sec.	S T R	
	S T R	

\$ 7.00 MISCELLANEOUS RECORDING
 \$ 2.00 REMONUMENTATION
 26 DEC 96 9:23 A.M. RECEIPT# 7B
 PAID RECORDED - OAKLAND COUNTY
 LYNN D. ALLEN, CLERK/REGISTER OF DEEDS

Compliance with
 ACT 345, P.A. 1990
 APPROVED ON: 11-25-96 JS
 OAKLAND COUNTY REMONUMENTATION
 PEER GROUP COMMITTEE
 Register of Deeds Stamp & File Number

4. Lot No. _____, Recorded Plat _____

5. Private Claims _____

I, James E. Kovas, in a field survey on November 19, 1996, do hereby certify that under requirements of P.A. 74, Michigan P.A. of 1970, the corner points mentioned in lines 1 and 2 above were in conformance with regulations and rules therefore as required in the current manual of survey instructions of the United States Department of the Interior, Bureau of Land Management or by a decree of a Court of Law and/or that the corner points mentioned in lines 3, 4 and 5 above were in conformance with the rules of the Michigan Board of Land Surveyors or by a Decree of a Court of Law; established, re-established, monumented, re-monumented, recovered, found as expressed below:

	A	B	C	D	E	F	G	H	I	J	K	L	M
2	6	5	4	3	2	1							
3													
4	7	8	9	10	11	12							
5													
6	10	17	16	15	14	13							
7													
8	10	20	21	22	23	24							
9													
10	30	29	28	27	26	25							
11													
12	31	32	33	34	35	36							
13													

NOTE: Not more than 4 corners, all in the same town and range, may be recorded on this certificate.

A. Description of original monument and accessories and/or subsequent restoration:
 B-11 - 1816 - G.L.O. Set 1/4 Post WIT: S30°W 14 Lks. Tamarack; N41°W 12 Lks. Tamarack.

1990 - Ambit Land Surveyors, 1" Iron Pipe WIT: N15°E 29.80' 2-16d Nails 4" Aspen; N45°E 12.15' P.K. Nail 2" Poplar; S75°E 32.60' 60d Nail 12" Dead Poplar; South 21.50' 2-16d Nails 14" Cherry; S80°W 53.00' 2-16d Nails 14" Cherry; West 21.92' 60d Nail N.Face Stump.

1992 - P.P. Palczynski, PS# 30096, LCRC (Liber 12756, Page 429) 1" Iron Pipe WIT: N15°E 29.80' 2-16d Nails 4" Aspen; N45°E 12.15' P.K. Nail 2" Poplar; S75°E 32.60' 60d Nail 12" Dead Poplar; South 21.50' 2-16d Nails Tamarack; S80°W 53.00' 2-16d Nails 14" Cherry; West 21.92' 60d Nail N. Face stump.

Distances: B-11 to C-11 = 2640.00' (GLO); 2651.65' (Ambit); 2651.92' (Wade-Trim)
 B-11 to A-11 = 2985.84' (GLO); 2985.84' (Wade-Trim)

B. Description of corner evidence found and/or method applied in restoring or reestablishing corner:

B-11 Found 1" Iron Pipe w/ Cap# 33140 in Swamp

WIT: N15°E 29.85' Fnd 2-16d Nails 4" Aspen
 N45°E 12.13' Fnd P.K. Nail 2" Poplar
 South 21.56' Fnd 2-16d Nails Tamarack
 S80°W 53.12' Fnd 2-16d Nails 14" Aspen
 West 22.0' Fnd Stump

The 1" Iron Pipe w/ Cap# 33140 found was ratified by the Peer Review Committee on November 25, 1996, as the accepted corner.

C. Description of monument for corner and accessories established to perpetuate locating the position of the corner:

B-11 Set Concrete Monument with Brass Oakland Co. Remon Cap# 33138

WIT: North 3.0' Set yellow Carsonite Post "Survey Mark"
 S65°W 21.49' Set 60d Nail/ Oakland Remon Brass Tag# 33138 SW Face 4" Red Cedar
 N25°W 69.24' Set 60d Nail/ Oakland Remon Brass Tag# 33138 NE Face 9" Tamarack
 S20°W 52.95' Set 60d Nail/ Oakland Remon Brass Tag# 33138 W. Face 6" Tamarack
 N65°E 12.23' Set 60d Nail/ Oakland Remon Brass Tag# 33138 NW Face 4" Elm

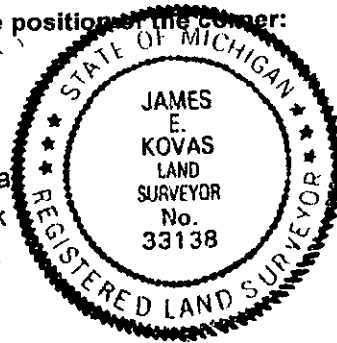

Signed by James E. Kovas Date December 20, 1996

Surveyor's Michigan License No. 33138