

**SURVEY & REMONUMENTATION**

**COPY**

MAY 11 95 084077

MAY 16 1996

LIBER 15397 PAG 586

**COMMISSION LAND CORNER RECORDATION CERTIFICATE**

Filing Requirement of Act 74, Mich. P.A. 1970

For corners in

Oakland

Commerce Twp.

(County)

Located In:

Corner Code #

1. Public Land Survey	T	2N	R	8E	C-8
	T		R		
	T		R		
	T		R		
2. Property Controlling in Section	S		T	R	
	S		T	R	
3. Miscellaneous Property in Sec.	S		T	R	
	S		T	R	

\$ 7.00 MISCELLANEOUS RECORDING  
 \$ 2.00 REMONUMENTATION  
 11 MAY 95 9:04 A.M. RECEIPT# 12B  
 PAID RECORDED - OAKLAND COUNTY  
 LYNN D. ALLEN, CLERK/REGISTER OF DEEDS

Compliance with ACT 345, P.A. 1990

APPROVED ON: 1-23-95  
 OAKLAND COUNTY REMONUMENTATION  
 PEER GROUP COMMITTEE  
 Register of Deeds Stamp & File Number

4. Lot No. \_\_\_\_\_, Recorded Plat \_\_\_\_\_  
 5. Private Claims \_\_\_\_\_

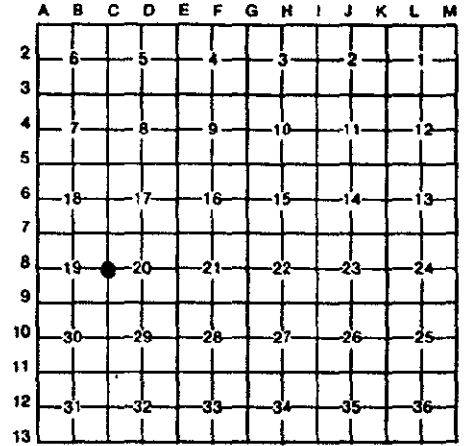

I, David Pawlaczyk, in a field survey on December 22, 1994, do hereby certify that under requirements of P.A. 74, Michigan P.A. of 1970, the corner points mentioned in lines 1 and 2 above were in conformance with regulations and rules therefore as required in the current manual of survey instructions of the United States Department of the Interior, Bureau of Land Management or by a decree of a Court of Law and/or that the corner points mentioned in lines 3, 4 and 5 above were in conformance with the rules of the Michigan Board of Land Surveyors or by a Decree of a Court of Law, established, re-established, monumented, re-monumented, recovered, found as expressed below:

**NOTE: Not more than 4 corners, all in the same town and range, may be recorded on this certificate.**

A. Description of original monument and accessories and/or subsequent restoration:

Date	Description	Surveyor	License No.	Notes
1816	Post	G.L.O. A. Holmes	N/A	
1979	1/2" R.R.	Survey D. Pawlaczyk	#17632	L7718 P26
1980	1/2" R.R.	L.C.R.C. R. Kohn	#26459	L7718 P29

*Handwritten signature/initials*

B. Description of corner evidence found and/or method applied in restoring or reestablishing corner:

A 1/2" iron rod in an existing monument box in asphalt pavement currently occupies this corner. The following ties were used to recover and verify its position:  
 2 ties from Survey L7718 P26 and L.C.R.C. L7718 P29

Field measurements were made between the following corners:

Corner Pair	Distance	Measurement	Surveyor	License No.
C-8 to C-9	2643.24	meas.		
	2640.00	rec.	G.L.O.	Notes
	2643.25	rec.	Condo	L14007 P 98
C-8 to D-8	2682.79	meas.		
	2682.82	rec.	Survey	L7718 P26
	2682.76	rec.	Plats & Prop Desc	L80 P11

C. Description of monument for corner and accessories established to perpetuate locating the position of the corner:

I placed a 2" diameter brass cap stamped "Oakland County Remonumentation P.S. #17632" on the existing 1/2" iron rod in an existing monument box in asphalt pavement.  
 N.56° E. 56.64' P.K. nail and O.C.R. tag in S.E. face D.E. pole  
 Due North 47.15' P.K. nail and O.C.R. tag in E. face D.E. pole  
 N.50° W. 104.35' S.E. corner house  
 N.54° W. 37.26' P.K. nail and O.C.R. tag in S.W. face 54" Maple  
 S.37° W. 66.77' P.K. nail and O.C.R. tag in S.E. face D.E. pole

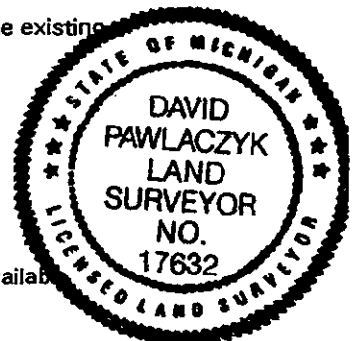

The selected location is accepted by me and generally accepted by Professional Surveyors as the best available evidence of the position of the original corner.

Signed by [Signature]

Date 2-16-95

Surveyor's Michigan License No. 17632

OK - T. SMITH