

MAY 16 1996

LIBER 15397 PAGE 589

COPY

COMMISSION

LAND CORNER RECORDATION CERTIFICATE

Filing Requirement of Act 74, Mich. P.A. 1970 1.00 MISCELLANEOUS RECORDING

For corners in Oakland

Commerce Twp.

\$ 2.00 REMONUMENTATION

11 MAY 95 9:04 A.M. RECEIPT# 12B PAID RECORDED - OAKLAND COUNTY LYNN D. ALLEN, CLERK/REGISTER OF DEEDS

Table with columns: (County), Located In, Corner Code #. Rows include Public Land Survey, Property Controlling in Section, Miscellaneous Property in Sec., Lot No., Private Claims.

Compliance with ACT 345, P.A. 1990

APPROVED ON: 1-23-95 OAKLAND COUNTY REMONUMENTATION PEER GROUP COMMITTEE Register of Deeds Stamp & File Number

I, David Pawlaczyk in a field survey on January 3, 1995 do hereby certify that under requirements of P.A. 74, Michigan P.A. of 1970, the corner points mentioned in lines 1 and 2 above were in conformance with regulations and rules therefore as required in the current manual of survey instructions of the United States Department of the Interior, Bureau of Land Management or by a decree of a Court of Law and/or that the corner points mentioned in lines 3, 4 and 5 above were in conformance with the rules of the Michigan Board of Land Surveyors or by a Decree of a Court of Law; established, re-established, monumented, re-monumented, recovered, found as expressed below:

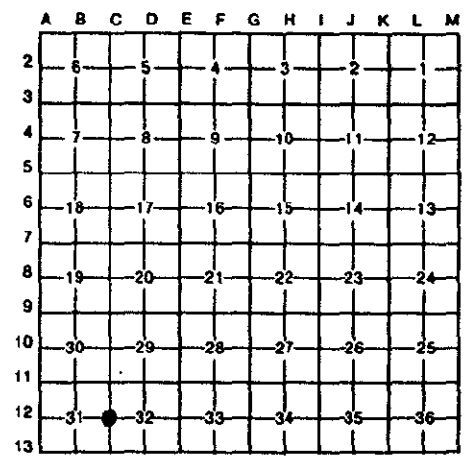

NOTE: Not more than 4 corners, all in the same town and range, may be recorded on this certificate.

A. Description of original monument and accessories and/or subsequent restoration:

Table with columns: Year, Description, G.L.O., Name, Notes. Rows include 1816 Post, 1987 Iron, 1991 3/4" steel bar, 1992 3/4" Bolt spike.

Handwritten signature/initials.

B. Description of corner evidence found and/or method applied in restoring or reestablishing corner:

A 3/4" iron rod in an existing monument box in asphalt pavement currently occupies this corner. The following ties were used to recover and verify its position: 3 ties from L.C.R.C. L10233 P391, 4 ties from L.C.R.C. L12756 P428, 3 ties from Survey Unrecorded (P.S. #17623)

Field measurements were made between the following corners:

Table with columns: Corner pair, Distance, Method, G.L.O., Notes. Rows include C-12 to C-11, 2649.53 meas., 2640.00 rec., 2649.74 rec.

Note: Matches M. Baldwin tie to cemetery fence corner (40.7R, 40.6M)

C. Description of monument for corner and accessories established to perpetuate locating the position of the corner:

I placed a 2" diameter brass cap stamped "Oakland County Remonumentation P.S. #17632" on the existing 3/4" iron rod in an existing monument box. N.45° W. 38.75' P.K. nail and O.C.R. tag in S.W. face D.E. pole, N.50° E. 51.36' S.E. Corner sign post (historical marker), S.60° E. 59.13' P.K. nail and O.C.R. tag in N.E. face D.E. pole, S.40° W. 42.30' P.K. nail and O.C.R. tag in S.E. face D.E. pole

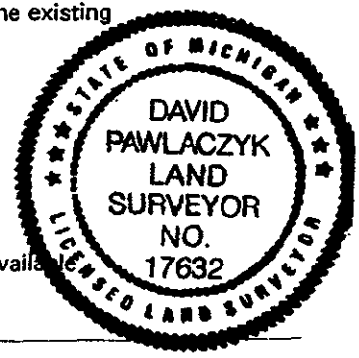

The selected location is accepted by me and generally accepted by Professional Surveyors as the best available evidence of the position of the original corner.

Signed by [Signature]

Date 2-16-95

Surveyor's Michigan License No. 17632

OK - T. SMITH