

SURVEY & REMONUMENTATION

MAR 10 95 040402

LIBER 15288 pg 488

MAY - 1 1995

LAND CORNER RECORDATION CERTIFICATE

Filing Requirement of Act 74, Mich. P.A. 1970

\$ 7.00 MISC RECORDING CHG - IN HOUSE
 \$ 2.00 REMON CHG - IN HOUSE
 MAR 95 3:58 P.M. RECEIPT# 1778
 PAID RECORDED - OAKLAND COUNTY
 LYNN D. ALLEN, CLERK/REGISTER OF DEEDS

For corners in **COMMISSION**

Oakland
 (County)

Located in: Commerce Twp. Corner Code =#

1. Public Land Survey	T <u>2N</u>	R <u>8E</u>	<u>D-3</u>
	T _____	R _____	_____
	T _____	R _____	_____
	T _____	R _____	_____
2. Property Controlling in Section	S _____	T _____	R _____
	S _____	T _____	R _____
3. Miscellaneous Property in Sec.	S _____	T _____	R _____
	S _____	T _____	R _____

Compliance with ACT 345, P.A. 1990
 APPROVED ON: 12-13-94
 OAKLAND COUNTY REMONUMENTATION PEER GROUP COMMITTEE
OK - T. SMITH
 Register of Deeds Stamp & File Number

4. Lot No. _____, Recorded Plat _____
 5. Private Claims _____

I, David Pawlaczyk, in a field survey on December 1, 1994, do hereby certify that under requirements of P.A. 74, Michigan P.A. of 1970, the corner points mentioned in lines 1 and 2 above were in conformance with regulations and rules therefore as required in the current manual of survey instructions of the United States Department of the Interior, Bureau of Land Management or by a decree of a Court of Law and/or that the corner points mentioned in lines 3, 4 and 5 above were in conformance with the rules of the Michigan Board of Land Surveyors or by a Decree of a Court of Law; established, re-established, monumented, re-monumented, recovered, found as expressed below:

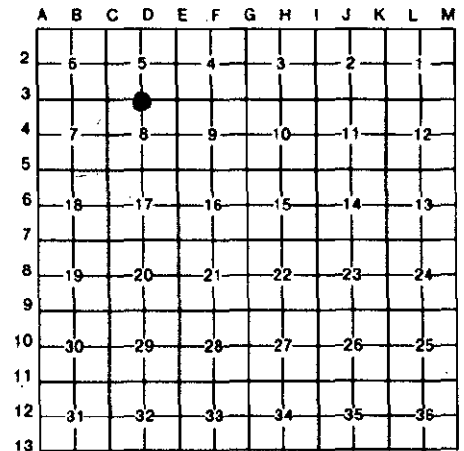

NOTE: Not more than 4 corners, all in the same town and range, may be recorded on this certificate.

A. Description of original monument and accessories and/or subsequent restoration:

Date	Description	Surveyor	Accessories	Notes
1815	Post	G.L.O.	A. Holmes	N/A
1978	Boat spike	L.C.R.C.	D. Lippincott	#25855
1980	1/2" Iron in monument box	Survey	D. Finney	#15536
1983	1/2" Re-rod in monument box	Survey	D. Finney	#15536
1985	1/2" Re-rod in monument box	Survey	D. Finney	#15536

B. Description of corner evidence found and/or method applied in restoring or reestablishing corner:

A 1/2" iron rod in a monument box in asphalt pavement currently occupies this corner. The following witness ties were used to recover and verify its position:

- 2 ties from L 7321 P11 L.C.R.C.
- 2 ties from L 8772 P408 Survey
- 2 ties from L 9270 P183 Survey

Field measurements were made between the following corners:

From	To	Distance	Method	Notes
D-3 to C-3	2644.94	meas.		
		rec.	G.L.O.	Notes
		rec.	Survey	L7854 P688
		rec.	Plats	L136 P21, 22 & L128 P40
D-3 to E-3	2666.01	meas.		
		rec.	G.L.O.	Notes

C. Description of monument for corner and accessories established to perpetuate locating the position of the corner:

I placed a 2" diameter brass cap stamped "Oakland County Remonumentation PS #17632" on the existing 1/2" iron rod in an existing monument box.

- N.06° W. 50.15' P.K. nail and O.C.R. tag in W. face utility pole
- S.42° E. 83.17' P.K. nail and O.C.R. tag in N.E. face 40" Oak
- S.18° E. 63.87' P.K. nail and O.C.R.C tag in W. face 30" Elm
- S.10° W. 57.25' P.K. nail and O.C.R. tag in N.W. face 18" Oak

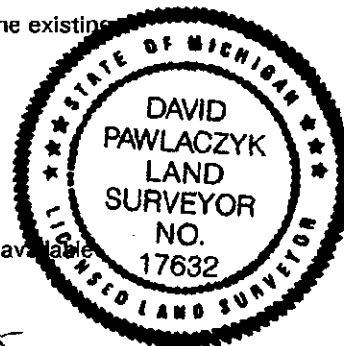

The selected location is accepted by me and generally accepted by Professional Surveyors as the best available evidence of the position of the original corner.

Signed by [Signature] Date 2-16-95
 Surveyor's Michigan License No. 17632