

SURVEY & REMONUMENTATION

LIBER 15397 PAGE 590

COPY

MAY 11 1995 084081

MAY 16 1996

COMMISSION

LAND CORNER RECORDATION CERTIFICATE

Filing Requirement of Act 74, Mich. P.A. 1970 1.00

For corners in Oakland
(County)

Commerce Twp.

Located in:

Corner Code #

1. Public Land Survey	T	<u>2N</u>	R	<u>8E</u>	<u>D-11</u>
	T	_____	R	_____	_____
	T	_____	R	_____	_____
	T	_____	R	_____	_____
2. Property Controlling in Section	S	_____	T	_____	R
	S	_____	T	_____	R
3. Miscellaneous Property in Sec.	S	_____	T	_____	R
	S	_____	T	_____	R

MISCELLANEOUS RECORDING

\$ 2.00 REMONUMENTATION

11 MAY 95 9:04 A.M. RECEIPT# 12B
PAID RECORDED - OAKLAND COUNTY
LYNN D. ALLEN, CLERK/REGISTER OF DEEDS

Compliance with ACT 345, P.A. 1990

APPROVED ON: 1-23-95
OAKLAND COUNTY REMONUMENTATION
PEER GROUP COMMITTEE
Register of Deeds Stamp & File Number

4. Lot No. _____, Recorded Plat _____
5. Private Claims _____

I, David Pawlaczyk in a field survey on January 3, 1995, do hereby certify that under requirements of P.A. 74, Michigan P.A. of 1970, the corner points mentioned in lines 1 and 2 above were in conformance with regulations and rules therefore as required in the current manual of survey instructions of the United States Department of the Interior, Bureau of Land Management or by a decree of a Court of Law and/or that the corner points mentioned in lines 3, 4 and 5 above were in conformance with the rules of the Michigan Board of Land Surveyors or by a Decree of a Court of Law, established, re-established, monumented, re-monumented, recovered, found as expressed below:

NOTE: Not more than 4 corners, all in the same town and range, may be recorded on this certificate.

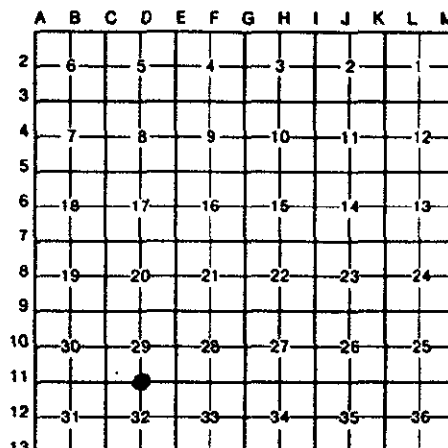

A. Description of original monument and accessories and/or subsequent restoration:

1816 Post	G.L.O.	A. Holmes	N/A	Notes
1976 P.K. nail	Survey	R. Kostecke	#12584	L6674 P386
1987 P.K. nail	Survey	D. Ross	#19005	Unrecorded
1988 16D. Nail	Survey	B. Thompson	#23828	L10786 P052
1989 3/8" Iron	Survey	C. Newman	#24607	Unrecorded
1989 16D. Nail	L.C.R.C.	B. Thompson	#23828	L10771 P198
1990 3/8" Iron	Survey	B. Thompson	#23828	Unrecorded
1990 16D. Nail	L.C.R.C.	B. Thompson	#23828	L11923 P8
1990 3/8" Iron	L.C.R.C.	B. Thompson	#23828	L11355 P395
1993 3/8" Iron	L.C.R.C.	B. Thompson	#23828	L13950 P648

Handwritten signature/initials

B. Description of corner evidence found and/or method applied in restoring or reestablishing corner:

A 3/8" iron rod in asphalt pavement currently occupies this corner. The following witness ties were used to verify and recover its position:

- 4 ties match survey witness ties L10786 P052
- 2 ties match survey witness ties unrecorded (P.S. #24607)
- 4 ties match L.C.R.C. witness ties L10771 P198
- 3 ties match survey witness ties unrecorded (P.S. #23828)
- 3 ties match L.C.R.C. L11923 P8, L11355 P395, L13950 P648

Field measurements were made between the following corners:

D-11 to C-11	2661.38	meas.		
	2652.21	rec.	G.L.O.	Notes
	2661.18	rec.	Survey	Unrecorded (P.S. #19005)
D-11 to E-11	2649.35	meas.		
	2652.21	rec.	G.L.O.	Notes
	2649.34	rec.	Survey	L10786 P52

C. Description of monument for corner and accessories established to perpetuate locating the position of the corner:

I replaced the existing 3/8" iron rod in asphalt pavement with a 5/8" x 24" iron rod with a 2" diameter brass cap stamped "Oakland County Remonumentation P.S. #17632" with a new monument box in asphalt pavement.

S.30° E.	28.03'	P.K. nail and O.C.R. tag in W. face 10" Oak
Due South	33.00'	Found 1/2" iron rod
S.25° W.	27.83'	P.K. nail and O.C.R. tag in S.E. face 30" Oak
S.40° W.	33.02'	P.K. nail and O.C.R. tag in S.E. face 24" Oak

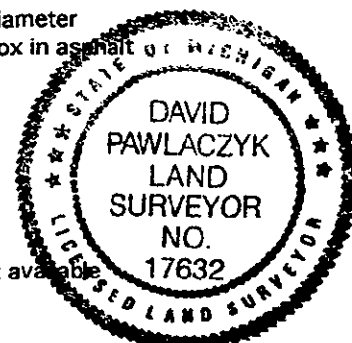

The selected location is accepted by me and generally accepted by Professional Surveyors as the best available evidence of the position of the original corner.

Signed by [Signature] Date 2-16-95
Surveyor's Michigan License No. 17632

OK - T. SMITH