

SURVEY & REMONUMENTATION

LIBER 15907 PG 734

DEC 27 95 257024

MAY 16 1996

COMMISSION

LAND CORNER RECORDATION CERTIFICATE
Filing Requirement of Act 74, Mich. P.A. 1970

For corners in Oakland (County) Located In: Commerce Twp. Corner Code # _____

1. Public Land Survey	T	<u>2N</u>	R	<u>8E</u>	<u>E-4</u>
	T	_____	R	_____	_____
	T	_____	R	_____	_____
	T	_____	R	_____	_____
2. Property Controlling in Section	S	_____	T	_____	R
	S	_____	T	_____	R
3. Miscellaneous Property in Section	S	_____	T	_____	R
	S	_____	T	_____	R

Compliance with ACT 345, P.A. 1990
APPROVED ON: 12-07-95 T.S.
OAKLAND COUNTY REMONUMENTATION PEER GROUP COMMITTEE
Register of Deeds Stamp & File Number

4. Lot No. _____, Recorded Plat _____
5. Private Claims _____

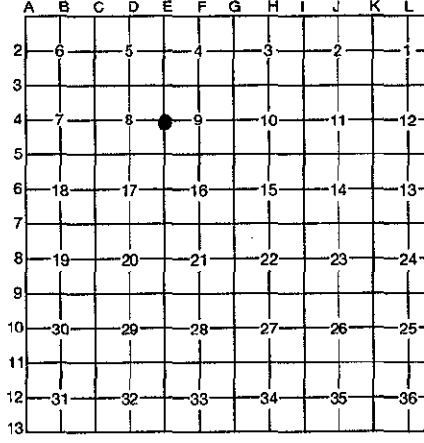

I, David Pawlaczyk, in a field survey on October 11, 1995, do hereby certify that under requirements of P.A. 74, Michigan P.A. of 1970, the corner points mentioned in lines 1 and 2 above were in conformance with regulations and rules therefore as required in the current manual of survey instructions of the United States Department of the Interior, Bureau of Land Management or by a decree of a Court of Law and/or that the corner points mentioned in lines 3, 4 and 5 above were in conformance with the rules of the Michigan Board of Professional Surveyors or by a Decree of a Court of Law; established, re-established, monumented, re-monumented, recovered, found as expressed below:

NOTE: Not more than 4 corners, all in the same town and range, may be recorded on this certificate.

A. Description of original monument and accessories and/or subsequent restoration:

1823 Post	G.L.O.	A. Holmes	N/A	Notes
1992 1/2" iron pipe	Survey	J. Scharl	#19843	L13212 P409-412
1992 1/2" iron pipe	L.C.R.C.	J. Scharl	#19843	L13127 P396
1993 1/2" iron pipe	L.C.R.C.	M. Milletics	#29249	L13401 P614

\$ 7.00 MISCELLANEOUS RECORDING
\$ 2.00 REMONUMENTATION
27 DEC 95 9:55 A.M. RECEIPT# 54B
PAID RECORDED - OAKLAND COUNTY
LYNN D. ALLEN, CLERK/REGISTER OF DEEDS

B. Description of corner evidence found and/or method applied in restoring or reestablishing corner:

A 1/2" iron pipe in an existing wetland fringe currently occupies this corner. The following witness ties were used to recover and verify its position:

4 ties match	Survey	L13127 P396
	L.C.R.C.	L13212 P411
4 ties match	L.C.R.C.	L13401 P614

Field measurements were made between the following corners:
E-3 to E-4 2620.24 meas. G.L.O.
E-4 to E-5 2640.00 Meas. G.L.O.
2640.00 G.L.O.
2658.52 Record Survey L13212 P409-411

C. Description of monument for corner and accessories established to perpetuate locating the position of the corner:

I replaced the found 1/2" iron pipe with a 4" x 36" concrete monument with a 2" diameter brass cap stamped "Oakland County Remonumentation PS 17632"

S 20° W.	12.08'	P.K. Nail & O.C.R. tag in 15" W. Oak
Due South	33.99'	P.K. Nail & O.C.R. tag in 20" W. Oak
S. 70° E.	27.50'	P.K. Nail & O.C.R. tag in 6" R. Maple
N. 20° E.	39.55'	P.K. Nail & O.C.R. tag in 6" R. Maple

The selected location is accepted by me and generally accepted by Professional Surveyors as the best available evidence of the position of the original corner.

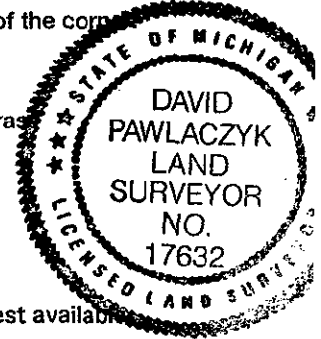

Signed by [Signature]
Surveyor's Michigan License No. 17632

Date 12-20-95