

MAY 16 1996

LIBER 15907 PG 738

DEC 27 95 257028

COMMISSION LAND CORNER RECORDATION CERTIFICATE

Filing Requirement of Act 74, Mich. P.A. 1970

For corners in Oakland (County)

Located In: Commerce Twp. Corner Code #

- 1. Public Land Survey T 2N R 8E E-8
2. Property Controlling in Section S T R
3. Miscellaneous Property in Section S T R

Compliance with ACT 345, P.A. 1990
APPROVED ON: 12-07-95-T.S.
OAKLAND COUNTY REMONUMENTATION PEER GROUP COMMITTEE

Register of Deeds Stamp & File Number

- 4. Lot No.
5. Private Claims

Grid table with columns A-L and rows 1-12. A dot is marked at the intersection of column E and row 8.

I, David Pawlaczyk, in a field survey on October 16, 1995, do hereby certify that under requirements of P.A. 74, Michigan P.A. of 1970, the corner points mentioned in lines 1 and 2 above were in conformance with regulations and rules therefore as required in the current manual of survey instructions of the United States Department of the Interior, Bureau of Land Management or by a decree of a Court of Law and/or that the corner points mentioned in lines 3, 4 and 5 above were in conformance with the rules of the Michigan Board of Professional Surveyors or by a Decree of a Court of Law; established, re-established, monumented, re-monumented, recovered, found as expressed below:

NOTE: Not more than 4 corners, all in the same town and range, may be recorded on this certificate.

A. Description of original monument and accessories and/or subsequent restoration:

Table with columns: Description, G.L.O., A. Holmes, M. Baldwin, Surveyor, Notes. Includes entries for 1823 Post and 1942 Iron pipe.

\$ 7.00 MISCELLANEOUS RECORDING
\$ 2.00 REMONUMENTATION
27 DEC 95 9:56 A.M. RECEIPT# 548
PAID RECORDED - OAKLAND COUNTY
LYNN D. ALLEN, CLERK/REGISTER OF DEEDS

B. Description of corner evidence found and/or method applied in restoring or reestablishing corner:

No stake currently occupies this corner. I re-established its location by extending the E-W 1/4 line easterly 1331.00 feet from found pipes at the center of Section 20 and 1/8 corner as confirmed from M. Baldwin witness ties to aforementioned corners. After establishing said E 1/4 corner 2 witness ties match M. Baldwin field note witnesses, the following field measurements were made:

Table with columns: Measurement (D-8 to E-8, E-8 to E-9), Distance (2658.25, 2635.79, 2640.00), Method (meas., Rec. M. Baldwin Survey Bk 17A P62, Rec. G.L.O.)

C. Description of monument for corner and accessories established to perpetuate locating the position of the corner:

I further set a 4" x 36" concrete monument with a 2" diameter brass cap stamped "Oakland County Remonumentation PS 17632"

- N. 67° E. 38.11' P.K. Nail & O.C.R. tag S. face 8" Elm
N. 40° N. 25.04' P.K. Nail & O.C.R. tag S.W. face 18" Cherry
S. 20° W. 42.65' P.K. Nail & O.C.R. tag N.W. face U Pole
S. 29° E. 49.00' P.K. Nail & O.C.R. tag N.E. face 36" Oak

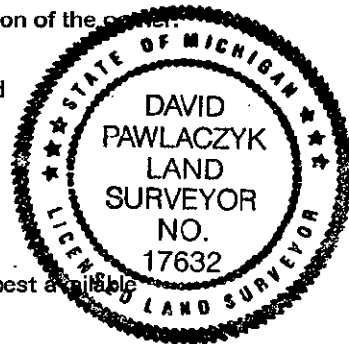

The selected location is accepted by me and generally accepted by Professional Surveyors as the best available evidence of the position of the original corner.

Signed by [Signature]

Date 12-20-95

Surveyor's Michigan License No. 17632