

MAY 16 1996

LIBER 15907 PG 739

COMMISSION LAND CORNER RECORDATION CERTIFICATE
Filing Requirement of Act 74, Mich. P.A. 1970

For corners in

(County) Oakland

Located In:

Commerce Twp.

Corner Code #

- 1. Public Land Survey T2N R8E F-7
2. Property Controlling in Section S T R
3. Miscellaneous Property in Section S T R

Compliance with ACT 345, P.A. 1990
APPROVED ON: 12-07-95 T.E.
OAKLAND COUNTY REMONUMENTATION PEER GROUP COMMITTEE

Register of Deeds Stamp & File Number

- 4. Lot No. , Recorded Plat
5. Private Claims

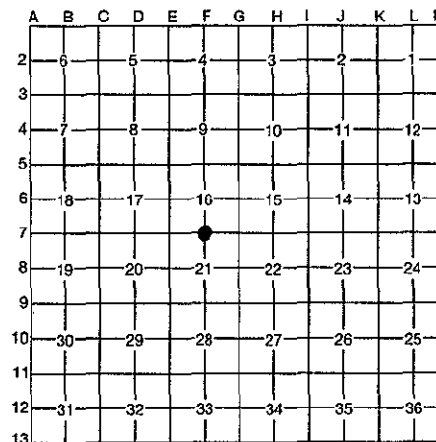

I, David Pawlaczyk, in a field survey on October 18, 1995, do hereby certify that under requirements of P.A. 74, Michigan P.A. of 1970, the corner points mentioned in lines 1 and 2 above were in conformance with regulations and rules therefore as required in the current manual of survey instructions of the United States Department of the Interior, Bureau of Land Management or by a decree of a Court of Law and/or that the corner points mentioned in lines 3, 4 and 5 above were in conformance with the rules of the Michigan Board of Professional Surveyors or by a Decree of a Court of Law; established, re-established, monumented, re-monumented, recovered, found as expressed below:

NOTE: Not more than 4 corners, all in the same town and range, may be recorded on this certificate.

A. Description of original monument and accessories and/or subsequent restoration:

Table with 4 columns: Year, Description, Surveyor, and Notes. Rows include 1823 Post, 1977 N/A, and 1985 N/A.

\$ 7.00 MISCELLANEOUS RECORDING
\$ 2.00 REMONUMENTATION
DEC 95 9:56 A.M. RECEIPT# 54B
PAID RECORDED - OAKLAND COUNTY
LYNN D. ALLEN, CLERK/REGISTER OF DEEDS

B. Description of corner evidence found and/or method applied in restoring or reestablishing corner:

A 5/8" iron rod in a field currently occupies this corner. The following witness ties were used to recover and verify its position:

1 tie matched survey witness ties from survey L10357 P739

Field measurements were made between the following corners:

Table with 3 columns: Corner pair, Distance, and Method. Rows include F-7 to G-7 (2705.66 meas.) and another pair (2679.60 G.L.O.).

C. Description of monument for corner and accessories established to perpetuate locating the position of the corner:

I replaced the found 5/8" iron rod with a 4" x 36" concrete monument with a 2" diameter brass cap stamped "Oakland County Remonumentation PS 17632"

- N. 75° W. 9.82' P.K. Nail & O.C.R. tag S. face 4" Maple
N. 30° E. 44.26' P.K. Nail & O.C.R. tag N.W. face 4" Elm
S. 75° E. 2.53' P.K. Nail & O.C.R. tag S.W. face 6" Elm
S. 10° E. 35.94' P.K. Nail & O.C.R. tag W. face 6" Elm

The selected location is accepted by me and generally accepted by Professional Surveyors as the best available evidence of the position of the original corner.

Signed by [Signature]

Date 12-20-95

Surveyor's Michigan License No. 17632

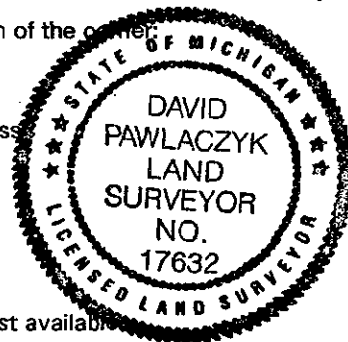

Handwritten note: 7.00 2.00 fil