

MAY 16 1996

COMMISSION LAND CORNER RECORDATION CERTIFICATE
Filing Requirement of Act 74, Mich. P.A. 1970

For corners in Oakland Located In: Commerce Twp. Corner Code #
(County)

- 1. Public Land Survey T 2N R 8E G-6
T _____ R _____
T _____ R _____
T _____ R _____
- 2. Property Controlling S _____ T _____ R _____
in Section S _____ T _____ R _____
- 3. Miscellaneous S _____ T _____ R _____
Property in Section S _____ T _____ R _____

Compliance with ACT 345, P.A. 1990
APPROVED ON: 12-07-95 T.S.
OAKLAND COUNTY REMONUMENTATION
PEER GROUP COMMITTEE

Register of Deeds Stamp & File Number

- 4. Lot No. _____, Recorded Plat _____
- 5. Private Claims _____

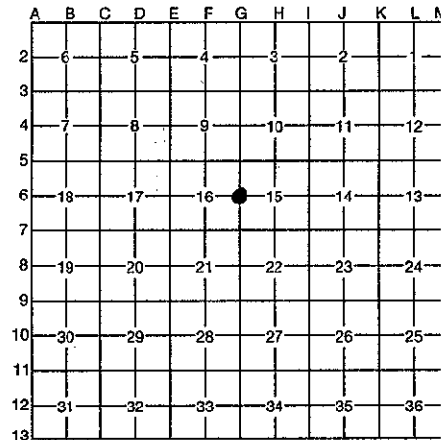

I, David Pawlaczyk, in a field survey on October 5, 19 95, do hereby certify that under requirements of P.A. 74, Michigan P.A. of 1970, the corner points mentioned in lines 1 and 2 above were in conformance with regulations and rules therefore as required in the current manual of survey instructions of the United States Department of the Interior, Bureau of Land Management or by a decree of a Court of Law and/or that the corner points mentioned in lines 3, 4 and 5 above were in conformance with the rules of the Michigan Board of Professional Surveyors or by a Decree of a Court of Law; established, re-established, monumented, re-monumented, recovered, found as expressed below:

NOTE: Not more than 4 corners, all in the same town and range, may be recorded on this certificate.

A. Description of original monument and accessories and/or subsequent restoration:

Date	Description	Surveyor	Notes	File No.
1823	Post	G.L.O. A. Holmes	N/A	
1983	P.K. nail	L.C.R.C. D. Finney	#15536	L8468 P186
1991	Found pipe in lawn	Survey D. Smith	#33140	L11444 P541
1991	Found pipe	Witness Notes J.C.K. & Assoc.	N/A	N/A

B. Description of corner evidence found and/or method applied in restoring or reestablishing corner:

A found 1/2" iron pipe in lawn area best fits the existing monumentation of Commerce Lake Highlands. The following witness ties were used to verify and recover its position:

- 3 ties match Survey Witnesses D. Smith #33140 L11444 P541
- 3 ties match Witness notes JCK & Assoc N/A N/A

Field measurements were made between the following corners:

G-5 to G-6	2669.59	meas.
	2640.00	G.L.O.
G-6 to G-7	2604.09	meas.
	2640.00	G.L.O.

\$ 7.00 MISCELLANEOUS RECORDING
\$ 2.00 REMONUMENTATION
27 DEC 95 9:59 A.M. RECEIPT# 54B
PAID RECORDED - OAKLAND COUNTY
LYNN D. ALLEN, CLERK/REGISTER OF DEEDS

C. Description of monument for corner and accessories established to perpetuate locating the position of the corner:

I replaced the found 1/2" pipe in lawn area with a 4" x 36" concrete monument with a 2" diameter brass cap stamped "Oakland County Remonumentation PS 17632"

S.62° W.	25.70'	N.E. corner of house
Due W.	2.64'	S.E. corner of house #1330 Vanstone St.
S.80° E.	31.17'	P.K. Nail and O.C.R. tag W. face 18" Oak
S.20° E.	44.09'	P.K. Nail and O.C.R. tag W. face Twin 12" Cherry

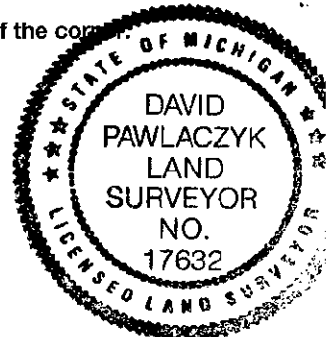

The selected location is accepted by me and generally accepted by Professional Surveyors as the best available evidence of the position of the original corner.

Signed by [Signature] Date 12-20-95

Surveyor's Michigan License No. 17632