

MAY 16 1996

COMMISSION LAND CORNER RECORDATION CERTIFICATE

Filing Requirement of Act 74, Mich. P.A. 1970

For corners in Oakland (County)

Located In: Commerce Twp. Corner Code #

- 1. Public Land Survey T2N R8E G-8
2. Property Controlling in Section S T R
3. Miscellaneous Property in Section S T R
4. Lot No. , Recorded Plat
5. Private Claims

Compliance with ACT 345, P.A. 1990
APPROVED ON: 12-07-95 T.S.
OAKLAND COUNTY REMONUMENTATION PEER GROUP COMMITTEE

Register of Deeds Stamp & File Number

Grid table with columns A-L and rows 1-13. A dot is marked at the intersection of column H and row 8.

I, David Pawlaczyk, in a field survey on October 4, 1995, do hereby certify that under requirements of P.A. 74, Michigan P.A. of 1970, the corner points mentioned in lines 1 and 2 above were in conformance with regulations and rules therefore as required in the current manual of survey instructions of the United States Department of the Interior, Bureau of Land Management or by a decree of a Court of Law and/or that the corner points mentioned in lines 3, 4 and 5 above were in conformance with the rules of the Michigan Board of Professional Surveyors or by a Decree of a Court of Law; established, re-established, monumented, re-monumented, recovered, found as expressed below:

NOTE: Not more than 4 corners, all in the same town and range, may be recorded on this certificate.

A. Description of original monument and accessories and/or subsequent restoration:

Table with columns: Year, Description, G.L.O., Survey, Witness, #, Notes. Includes entries for 1823 Post, 1972 Found 1/2" iron, 1976 Found iron, 1977 Found P.K., 1983 Found 1/2" iron, 1985 Found P.K. nail, 1989 Found P.K. nail, 1992 Found P.K. nail.

B. Description of corner evidence found and/or method applied in restoring or reestablishing corner:

A 1/2" iron rod in asphalt pavement currently occupies this corner; the following witness ties were used to verify and recover its position:

Table with columns: Ties match, Witness, #. Includes entries for 3 ties match Survey, 3 ties match L.C.R.C., 4 ties match L.C.R.C., 3 ties match L.C.R.C.

Field measurements were made between the following corners:

Table with columns: Corner pair, Distance, Method. Includes entries for G-7 to G-8 (2645.38 meas., 2640.00 G.L.O., 2642.38 Summation of plat dimensions).

\$ 7.00 MISCELLANEOUS RECORDING
\$ 2.00 REMONUMENTATION
27 DEC 95 9:55 A.M. RECEIPT# 548
PAID RECORDED - OAKLAND COUNTY
LYNN D. ALLEN, CLERK/REGISTER OF DEEDS

C. Description of monument for corner and accessories established to perpetuate locating the position of the corner:

I replaced the found 1/2" iron rod in asphalt pavement with a 3/4" X 24" iron rod with a 2" diameter brass cap stamped "Oakland County Remonumentation PS #17632" with a new monument box.

Table with columns: Direction, Distance, Description. Includes entries for Due N. (28.62' P.K. nail and O.C.R. tag E. face 30" Oak), N.50° E. (45.38 P.K. nail and O.C.R. tag S.E. face twin 16" Oak), Due south (32.24 P.K. nail and O.C.R. tag E. face U-pole), S.60° W. (54.85' P.K. Nail and O.C.R. tag N.W. face 26" Oak).

The selected location is accepted by me and generally accepted by Professional Surveyors as the best available evidence of the position of the original corner.

Signed by [Signature]

Date 12-20-95

Surveyor's Michigan License No. 17632

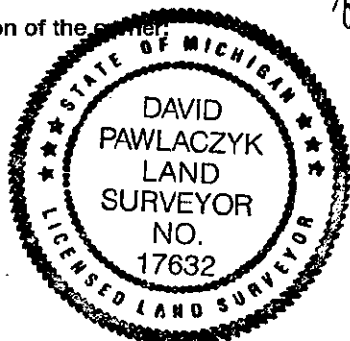

Handwritten notes: 7.00, 2.00, [Signature]