

COPY SURVEY & REMONUMENTATION

LIBER 16860PG101

Dec 26 96 309630

Dec 26 96 309630

MAY 22 1997

LAND CORNER RECORDATION CERTIFICATE
Filing Requirement of Act 74, Mich. P.A. 1970

COMMISSION
For corners in

Oakland Located In: Corner Code #
(county)

- 1. Public Land Survey T 2N R 8E G-12
T R
T R
T R
- 2. Property Controlling S T R
in Section S T R
- 3. Miscellaneous S T R
Property in Sec. S T R

\$ 7.00 MISCELLANEOUS RECORDING
\$ 2.00 REMONUMENTATION
26 DEC 96 9:26 A.M. RECEIPT# 78
PAID RECORDED - OAKLAND COUNTY
LYNN D. ALLEN, CLERK/REGISTER OF DEEDS

Compliance with
ACT 345, P.A. 1990
APPROVED ON: 10-21-96 TS
OAKLAND COUNTY REMONUMENTATION
PEER GROUP COMMITTEE
Register of Deeds Stamp & File Number

4. Lot No. _____, Recorded Plat _____

5. Private Claims _____

I, James E. Kovas, in a field survey on November 25, 1996, do hereby certify that under requirements of P.A. 74, Michigan P.A. of 1970, the corner points mentioned in lines 1 and 2 above were in conformance with regulations and rules therefore as required in the current manual of survey instructions of the United States Department of the Interior, Bureau of Land Management or by a decree of a Court of Law and/or that the corner points mentioned in lines 3, 4 and 5 above were in conformance with the rules of the Michigan Board of Land Surveyors or by a Decree of a Court of Law; established, re-established, monumented, re-monumented, recovered, found as expressed below:

A	B	C	D	E	F	G	H	I	J	K	L	M
2	6	5	4	3	2	1						
3												
4	7	8	9	10	11	12						
5												
6	16	17	18	15	14	13						
7												
8	19	20	21	22	23	24						
9												
10	30	29	28	27	26	25						
11												
12	31	32	33	34	35	36						
13												

NOTE: Not more than 4 corners, all in the same town and range, may be recorded on this certificate.

A. Description of original monument and accessories and/or subsequent restoration:
G-12

1816 - G.L.O. Set 1/4 Post WIT: N73°E 40 Lks B.Oak; S37°E 11 Lks. B.Oak;
1985 - McCoy Land Surveying, Survey WIT: S10°W 36.05' P.K. Nail D.E. Pole; N05°W 18.43' P.K. Nail D.E. Pole; S60°E 83.46' P.K. Nail D.E. Pole; 1989 - Grant Ward, PS# 22445, LCRC (Liber 11176, Page 317) Set Iron Rod & Cap#22445 WIT: N05°W 21.54' P.K. Nail W.Face U.Pole; S25°W 32.68' P.K. Nail E.Face U.Pole; S65°E 82.72' P.K. Nail N.Face U.Pole; N70°E 92.56' Top/ Center Fire Hydrant; (3.29 N & 0.71' E) Fnd P.K. Nail in Road; (0.06' S & 0.63' E) Fnd P.K. Nail in Road; 1989 - Kostecke, Iron w/Cap# 22445 WIT: N05W 21.55' P.K. Nail W.Face U.Pole; S45°W 32.73' P.K. Nail E.Face U.Pole; S45°E 82.75' P.K. Nail N.Face U.Pole; 1990 - Spaulding, DeDecker & Assoc., LCRC (Liber 11645, Page 213 & Liber 11645, Page 217) Set P.K. Nail w/ SDA Tag in Bituminous Road WIT: N02°W 21.53' P.K. Nail W.Face U.Pole; S26°W 32.78' P.K. Nail E.Face U.Pole; S65°E 82.70' P.K. Nail N.Face U.Pole; N75°E 92.57' Centerline of Hydrant.
Distances: G-12 to G-11 = 2640.00' (GLO); 2632.42' (Wade-Trim)
G-12 to G-13 = 2640.00' (GLO); 2651.89' (Wade-Trim)

B. Description of corner evidence found and/or method applied in restoring or reestablishing corner:

G-12 Found P.K. Nail w/ SDA Tag at bituminous road surface
Found 3/4" Iron Rod w/Cap #22445, 0.3' below bituminous surface, at same location as P.K. Nail w/SDA Tag.

WIT: N02°W 21.53' Fnd P.K. Nail W.Face U.Pole
S26°W 32.78' Fnd P.K. Nail E.Face U.Pole
S65°E 82.70' Fnd P.K. Nail N.Face U.Pole
N75°E 92.57' Fnd Top/ Centerline of Fire Hydrant

The location shared by the P.K. Nail w/ SDA Tag, and the 3/4" Iron Rod w/ Cap# 22445, was ratified by the Peer Review Committee on November 25, 1996, as the accepted corner.

C. Description of monument for corner and accessories established to perpetuate locating the position of the corner:

G-12 Removed Cap #22445 from 3/4" Iron Rod found, and Set Brass Oakland Co. Remonumentation Cap #33138 on existing 3/4" Iron Rod, in New Monument Box.

WIT: S05°E 42.69' Set 60d Nail/ Oakland Co. Remon Tag# 33138 E.Face 8" Cherry
N50°E 65.00' Set 60d Nail/ Oakland Co. Remon Tag# 33138 SE Face 12' Apple
N65°W 73.66' Set 60d Nail/ Oakland Co. Remon Tag# 33138 SW Face 4" Wood Fence Post
S60°W 69.81' Set 60d Nail/ Oakland Co. Remon Tag# 33138 NW Face 7" Pine
South 32.99' Fnd 1/2" Iron Rod (Prop. Cor.)

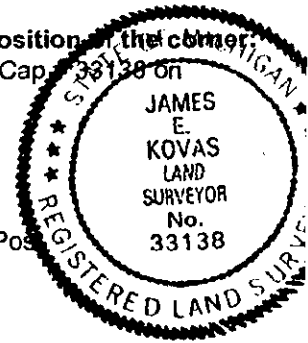

Signed by James E. Kovas Date December 20, 1996

Surveyor's Michigan License No. 33138