

SURVEY & REMONUMENTATION

MAR 10 95 040410

LIBER 15288 PC 496

MAY - 1 1995

LAND CORNER RECORDATION CERTIFICATE 2.00 RECON CHG - IN HOUSE
 Filing Requirement of Act 74, Mich. P.A. 1970

COMMISSION
 For corners in Oakland

Commerce Twp.

\$ 7.00 NISC RECORDING CHG - IN HOUSE
 PAID MAR 95 4:00 P.M. RECEIPT# 177B
 LYNN D. ALLEN, CLERK/REGISTER OF DEEDS

(County)	Located in:	Corner Code #
1. Public Land Survey	T 2N R 8E	K-9
	T R	
	T R	
	T R	
2. Property Controlling in Section	S T R	
	S T R	
3. Miscellaneous Property in Sec.	S T R	
	S T R	
4. Lot No. _____, Recorded Plat _____		
5. Private Claims _____		

Compliance with ACT 345, P.A. 1990
 APPROVED ON: 12-05-94
 OAKLAND COUNTY REMONUMENTATION PEER GROUP COMMITTEE

OK - T. SMITH
 Register of Deeds Stamp & File Number

I, David Pawlaczyk, in a field survey on October 25, 1994, do hereby certify that under requirements of P.A. 74, Michigan P.A. of 1970, the corner points mentioned in lines 1 and 2 above were in conformance with regulations and rules therefore as required in the current manual of survey instructions of the United States Department of the Interior, Bureau of Land Management or by a decree of a Court of Law and/or that the corner points mentioned in lines 3, 4 and 5 above were in conformance with the rules of the Michigan Board of Land Surveyors or by a Decree of a Court of Law, established, re-established, monumented, re-monumented, recovered, found as expressed below:

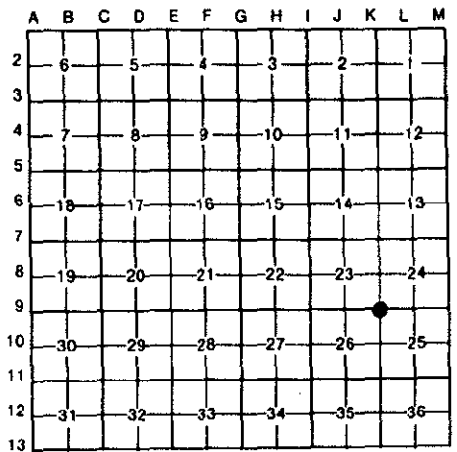

NOTE: Not more than 4 corners, all in the same town and range, may be recorded on this certificate.

A. Description of original monument and accessories and/or subsequent restoration:

		G.L.O.	A. Holmes	N/A	Notes
1815	Post				
1981	1/2" Iron in a mon. box	Survey	D. Finney	#15536	L8071 P04
1992	1/2" Iron in a mon.	L.C.R.C.	B. Thompson	#23828	L13688 P627

B. Description of corner evidence found and/or method applied in restoring or reestablishing corner:

A 1/2" iron rod in a monument box in asphalt pavement currently occupies this corner. The following witness ties were used to recover and verify its position:

- 4 ties from L.C.R.C. L13688 P627
- 1 tie from L.C.R.C. L8071 P004

Field measurements were made between the following corners:

K-9 to K-8	2630.78	meas.		
	2640.00	rec.	G.L.O.	Notes
	2640.00	rec.	Plats	L33 P3
	2630.90	rec.	Survey	Not recorded J. Kapelczak #24598
K-9 to K-10	2643.71	meas.		
	2640.00	rec.	G.L.O.	Notes
	2643.88	rec.	Plats	L91 P32 & L69 P31

7.00
2.00

C. Description of monument for corner and accessories established to perpetuate locating the position of the corner:

I placed a 2" diameter brass cap stamped "Oakland County Remonumentation PS #17632" on a 1/2" iron rod in a monument box in asphalt pavement.

S.87° W.	59.88'	P.K. nail and O.C.R. tag in N. face 30" Cherry
S.37° W.	49.99'	P.K. nail and O.C.R. tag in N.W. face 8" Oak
S.48° E.	41.65'	P.K. nail and O.C.R. tag in S.W. face 30" Oak
N.48° E.	41.37'	P.K. nail and O.C.R. tag in N.W. face 12" Oak

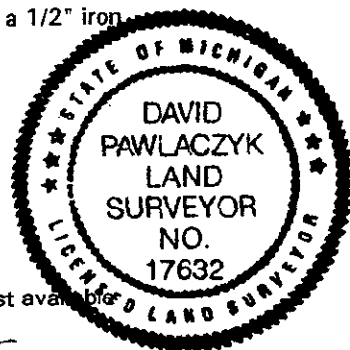

The selected location is accepted by me and generally accepted by Professional Surveyors as the best available evidence of the position of the original corner.

Signed by [Signature] Date 2-16-95

Surveyor's Michigan License No. 17632