

SURVEY & REMONUMENTATION

Mar 10 95 040417

MAY - 1 1995

LIBER 15288 PG 503

OK - T. SMITH

COMMISSION

LAND CORNER RECORDATION CERTIFICATE

Filing Requirement of Act 74, Mich. P.A. 1970
Commerce Twp.

7.00 MISC RECORDING CHG - IN HOUSE
2.00 REMON CHG - IN HOUSE
10 MAR 95 4:01 P.M. RECEIPT# 177B
PAID RECORDED - OAKLAND COUNTY
LYNN D. ALLEN, CLERK/REGISTER OF DEEDS

Compliance with
ACT 345, P.A. 1990

APPROVED ON: 12-13-94
OAKLAND COUNTY REMONUMENTATION
PEER GROUP COMMITTEE

Register of Deeds Stamp & File Number

For corners in Oakland

(County)

Located In:

Corner Code #

1. Public Land Survey	T <u>2N</u> R <u>8E</u>	<u>M-7</u>
	T _____ R _____	_____
	T _____ R _____	_____
	T _____ R _____	_____
2. Property Controlling in Section	S _____ T _____ R _____	_____
	S _____ T _____ R _____	_____
3. Miscellaneous Property in Sec.	S _____ T _____ R _____	_____
	S _____ T _____ R _____	_____

4. Lot No. _____, Recorded Plat _____
5. Private Claims _____

I, David Pawlaczyk, in a field survey on October 25, 1994, do hereby certify that under requirements of P.A. 74, Michigan P.A. of 1970, the corner points mentioned in lines 1 and 2 above were in conformance with regulations and rules therefore as required in the current manual of survey instructions of the United States Department of the Interior, Bureau of Land Management or by a decree of a Court of Law and/or that the corner points mentioned in lines 3, 4 and 5 above were in conformance with the rules of the Michigan Board of Land Surveyors or by a Decree of a Court of Law, established, re-established, monumented, re-monumented, recovered, found as expressed below.

NOTE: Not more than 4 corners, all in the same town and range, may be recorded on this certificate.

A	B	C	D	E	F	G	H	I	J	K	L	M
2	6	5	4	3	2	1						
3												
4	7	8	9	10	11	12						
5												
6	18	17	16	15	14	13						
7												
8	19	20	21	22	23	24						
9												
10	30	29	28	27	26	25						
11												
12	31	32	33	34	35	36						
13												

A. Description of original monument and accessories and/or subsequent restoration:

1815 Post	G.L.O.	A. Holmes	N/A	Notes
1973 1/2" Iron in a mon. box	Survey	R. Kostecke	#12584	L6257 P550
1978 1/2" Iron in a mon. box	L.C.R.C.	D. Finney	#15536	L7737 P446
1979 1/2" Iron in a mon. box	Survey	D. Finney	#15536	L7669 P453

B. Description of corner evidence found and/or method applied in restoring or reestablishing corner:

A 1/2" iron in a monument box in asphalt pavement currently occupies this corner. No witness ties were found from L.C.R.C. or recorded survey witnesses.

Field measurements were made between the following corners:

M-7 to L-7	2712.14	meas.		
	2692.80	rec.	G.L.O.	Notes
	2712.36	rec.	Survey	L7669 P453
M-7 to M-8	2664.01	meas.		
	2640.00	rec.	G.L.O.	Notes
	2664.24	rec.	Survey	L7669 P453

1700
2-12

C. Description of monument for corner and accessories established to perpetuate locating the position of the corner:

I placed a 2" diameter brass cap stamped "Oakland County Remonumentation PS #17632" on the existing 1/2" iron rod in a monument box in asphalt pavement.

N.33° W.	124.74'	P.K. nail and O.C.R. tag in N.E. face D.E. pole
N.52° E.	43.72'	Nail and MDOT washer S.E. face light pole
S.22° E.	87.26'	Nail and MDOT washer S.W. face M.B.T. pole
S.42° W.	60.63'	Nail and MDOT washer S.E. face traffic pole
Due south	380.11'	Found 1/2" iron rod in monument box

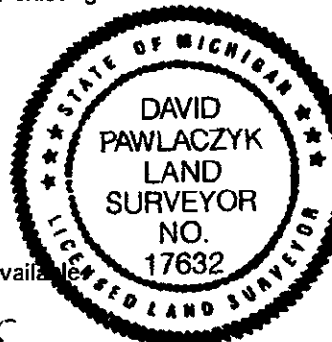

The selected location is accepted by me and generally accepted by Professional Surveyors as the best available evidence of the position of the original corner.

Signed by [Signature] Date 2-16-95
Surveyor's Michigan License No. 17632