

SURVEY & REMONUMENTATION

LIBER 14992 PG 090

94 254973

MAY - 1 1995

COMMISSION LAND CORNER RECORDATION CERTIFICATE
Filing Requirement of Act 74, Mich. P.A. 1970

OK - T. SMITH

For corners in

OAKLAND
(County)

Located In: AYON
TOWNSHIP

Corner Code #

- | | | | | | |
|------------------------------------|---|-----------|---|------------|-------------|
| 1. Public Land Survey | T | <u>3N</u> | R | <u>11E</u> | <u>I-12</u> |
| | T | --- | R | --- | --- |
| | T | --- | R | --- | --- |
| | T | --- | R | --- | --- |
| 2. Property Controlling in Section | S | --- | T | --- | --- |
| | S | --- | T | --- | --- |
| 3. Miscellaneous Property in Sec. | S | --- | T | --- | --- |
| | S | --- | T | --- | --- |

\$ 7.00 MISCELLANEOUS RECORDING
\$ 2.00 REMONUMENTATION
22 SEP 94 8:41 A.M. RECEIPT# 33B
PAID RECORDED - OAKLAND COUNTY
LYNN D. ALLEN, CLERK REGISTER OF DEEDS
ACT 74, P.A. 1970

APPROVED ON: 1-12-94
OAKLAND COUNTY REMONUMENTATION
PEER GROUP COMMITTEE

Register of Deeds Stamp & File Number

4. Lot No. _____, Recorded Plat _____
5. Private Claims _____

	A	B	C	D	E	F	G	H	I	J	K	L	M
2	6	5	4	3	2	1							
3													
4	7	8	9	10	11	12							
5													
6	18	17	16	15	14	13							
7													
8	19	20	21	22	23	24							
9													
10	30	29	28	27	26	25							
11													
12	31	32	33	34	35	36							
13													

I, DAVID PAWLACZYK, in a field survey on 12-4-93, 19_____, do hereby certify that under requirements of P.A. 74, Michigan P.A. of 1970, the corner points mentioned in lines 1 and 2 above were in conformance with regulations and rules therelore as required in the current manual of survey instructions of the United States Department of the Interior, Bureau of Land Management or by a decree of a Court of Law and/or that the corner points mentioned in lines 3, 4 and 5 above were in conformance with the rules of the Michigan Board of Land Surveyors or by a Decree of a Court of Law; established, re-established, monumented, re-monumented, recovered, found as expressed below:

NOTE: Not more than 4 corners, all in the same town and range, may be recorded on this certificate.

A. Description of original monument and accessories and/or subsequent restoration:

POST KIAS SET PER G.L.O. RECORDS
N76°W 11 LINKS 21" RED OAK
N21°E 23 LINKS 8" ASH

B. Description of corner evidence found and/or method applied in restoring or reestablishing corner:

FOUND CROSS IN PAVEMENT
PREVIOUS LAND CORNER RECORDATION CERTIFICATE
L13157, P563, O.C.R.

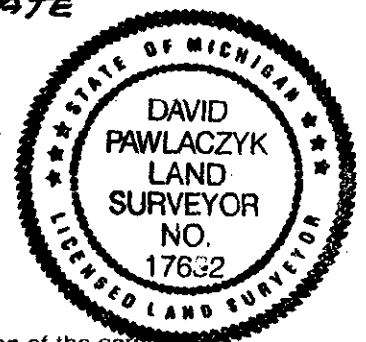

C. Description of monument for corner and accessories established to perpetuate locating the position of the corner:

REPLACED THE CROSS WITH A P.A. 345 BRASS CAP
STAMPED #17632 ON A 24" X 3/4" IRON ROD
ACCESSORIES ESTABLISHED

NORTHEAST 216.13' WITNESS TAG NORTHWEST FACE WILLOW TREE
SOUTHEAST 121.78' " " NORTH FACE OF POWER POLE
SOUTHWEST 96.57' " " NORTHWEST " OF POWER POLE
NORTHWEST 198.08' " " NORTHEAST FACE OF POWER POLE

Signed by: [Signature]

Date: 1-11-94

Surveyor's Michigan License No. 17632