

MAY - 1 1995

COMMISSION

LAND CORNER RECORDATION CERTIFICATE
Filing Requirement of Act 74, Mich. P.A. 1970

OK - T. SMITH

For corners in

OAKLAND
(County)

Located In: AVON TOWNSHIP Corner Code #

- 1. Public Land Survey T-3-N R-11-E M-12
T R
T R
T R
- 2. Property Controlling S T R
in Section S T R
- 3. Miscellaneous S T R
Property in Sec. S T R

\$ 7.00 MISCELLANEOUS RECORDING
\$ 2.00 REMONUMENTATION
22 SEP 94 8:46 A.M. RECEIPT# 338
PAID RECORDED - OAKLAND COUNTY
LYNN D. ALLEN, CLERK/REGISTER OF DEEDS

Compliance with
ACT 345, P.A. 1990

APPROVED ON: 1-11-94
OAKLAND COUNTY REMONUMENTATION
DEED GROUP COMMITTEE
Register of Deeds Stamp & File Number

- 4. Lot No. _____, Recorded Plat _____
- 5. Private Claims _____

	A	B	C	D	E	F	G	H	I	J	K	L	M
2	6	5	4	3	2	1							
3													
4	7	8	9	10	11	12							
5													
6	18	17	16	15	14	13							
7													
8	19	20	21	22	23	24							
9													
10	30	29	28	27	26	25							
11													
12	31	32	33	34	35	36							
13													

I, DAVID PAWLACZYK, in a field survey on DECEMBER 1, 1993, do hereby certify that under requirements of P.A. 74, Michigan P.A. of 1970, the corner points mentioned in lines 1 and 2 above were in conformance with regulations and rules therefore as required in the current manual of survey instructions of the United States Department of the Interior, Bureau of Land Management or by a decree of a Court of Law and/or that the corner points mentioned in lines 3, 4 and 5 above were in conformance with the rules of the Michigan Board of Land Surveyors or by a Decree of a Court of Law; established, re-established, monumented, re-monumented, recovered, found as expressed below:

NOTE: Not more than 4 corners, all in the same town and range, may be recorded on this certificate.

A. Description of original monument and accessories and/or subsequent restoration:

POST WAS SET PER GOVERNMENT LAND OFFICE NOTES
N. 86° E. 34 LINKS 18" BLACK OAK
S. 77 1/2° E. 42 LINKS 11" WHITE OAK

1/10
1/16

B. Description of corner evidence found and/or method applied in restoring or reestablishing corner:

FOUND 1/2" RE-ROD IN MONUMENT BOX
PREVIOUS LAND CORNER RECORDATION CERTIFICATES
LIBER 10168 PAGE 651

C. Description of monument for corner and accessories established to perpetuate locating the position of the corner:

REPLACED THE 1/2" RE-ROD WITH P.A. 345 BRASS
CAP STAMPED # 17632 ON 3/4" x 24" IRON ROD.
ACCESSORIES ESTABLISHED
N. 60° E., 49.70' CUT CROSS NORTH RIM OF SANITARY MANHOLE
DUE EAST, 54.50' WITNESS TAG ON SOUTH FACE UTILITY POLE
S. 45° W., 55.35' CUT CROSS & BEEHIVE CATCH BASIN
N. 45° W., 82.96' & TOP NUT OF FIRE HYDRANT

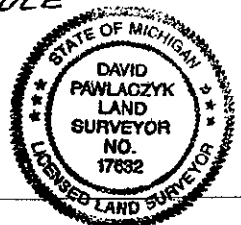

Signed by [Signature]

Date 1-11-94

Surveyor's Michigan License No. 17632