

MAY 16 1996

LIBER 15907 pg 730

DEC 27 95 257020

COMMISSION

LAND CORNER RECORDATION CERTIFICATE
Filing Requirement of Act 74, Mich. P.A. 1970

For corners in

OAKLAND
(County)

Located In: AVON TOWNSHIP Corner Code #

- 1. Public Land Survey T-3-N R-11-E M-13
T _____ R _____
T _____ R _____
T _____ R _____
- 2. Property Controlling in Section S _____ T _____ R _____
S _____ T _____ R _____
- 3. Miscellaneous Property in Sec. S _____ T _____ R _____
S _____ T _____ R _____

Compliance with ACT 345, P.A. 1990
APPROVED ON: 12-13-94 [Signature]
OAKLAND COUNTY REMONUMENTATION PERPETUOUS COMMITTEE

Register of Deeds Stamp & File Number

- 4. Lot No. _____, Recorded Plat _____
- 5. Private Claims _____

| | A | B | C | D | E | F | G | H | I | J | K | L | M |
|----|----|----|----|----|----|----|---|---|---|---|---|---|---|
| 2 | 6 | 5 | 4 | 3 | 2 | 1 | | | | | | | |
| 3 | | | | | | | | | | | | | |
| 4 | 7 | 8 | 9 | 10 | 11 | 12 | | | | | | | |
| 5 | | | | | | | | | | | | | |
| 6 | 18 | 17 | 16 | 15 | 14 | 13 | | | | | | | |
| 7 | | | | | | | | | | | | | |
| 8 | 19 | 20 | 21 | 22 | 23 | 24 | | | | | | | |
| 9 | | | | | | | | | | | | | |
| 10 | 30 | 29 | 28 | 27 | 26 | 25 | | | | | | | |
| 11 | | | | | | | | | | | | | |
| 12 | 31 | 32 | 33 | 34 | 35 | 36 | | | | | | | |
| 13 | | | | | | | | | | | | | |

I, DAVID PAWLACZYK, in a field survey on DECEMBER 1, 19 93, do hereby certify that under requirements of P.A. 74, Michigan P.A. of 1970, the corner points mentioned in lines 1 and 2 above were in conformance with regulations and rules therefore as required in the current manual of survey instructions of the United States Department of the Interior, Bureau of Land Management or by a decree of a Court of Law and/or that the corner points mentioned in lines 3, 4 and 5 above were in conformance with the rules of the Michigan Board of Land Surveyors or by a Decree of a Court of Law; established, re-established, monumented, re-monumented, recovered, found as expressed below:

NOTE: Not more than 4 corners, all in the same town and range, may be recorded on this certificate.

A. Description of original monument and accessories and/or subsequent restoration:

POST WAS SET PER GOVERNMENT LAND OFFICE NOTES
S. 38°W. 15 LINKS 9" BLACK OAK
N. 24°E. 111 LINKS 9" BLACK OAK

\$ 7.00 MISCELLANEOUS RECORDING
\$ 2.00 REMONUMENTATION
27 DEC 95 9:55 A.M. RECEIPT# 548
PAID RECORDED - OAKLAND COUNTY
LYNN B. ALLEN, CLERK/REGISTER OF DEEDS

B. Description of corner evidence found and/or method applied in restoring or reestablishing corners:

FOUND 1/2" IRON ROD IN MONUMENT BOX
PREVIOUS LAND CORNER RECORDATION CERTIFICATES
LIBER 10168 PAGE 651

C. Description of monument for corner and accessories established to perpetuate locating the position of the corner:

REPLACED THE 1/2" IRON ROD WITH P.A. 345 BRASS
CAP STAMPED #17632 ON 3/4" X 24" IRON ROD.
ACCESSORIES ESTABLISHED
N. 40°E., 86.60' WITNESS TAG ON SOUTHEAST FACE OF UTILITY POLE
S. 45°E., 88.44' WITNESS TAG ON NORTH FACE UTILITY POLE
S. 45°W., 83.72' WITNESS TAG ON NORTH FACE UTILITY POLE
N. 45°W., 85.91' WITNESS TAG ON NORTH FACE UTILITY POLE

Signed by [Signature]
Surveyor's Michigan License No. 17632

Date 1-11-94

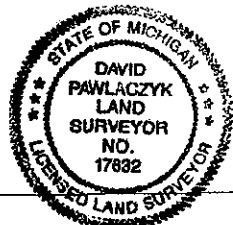

7.00
2.00
file