

**SURVEY & REMONUMENTATION**

MAY 24 2000

LIBER 19843PG651

**LAND CORNER RECORDATION CERTIFICATE**  
Filing Requirement of Act 74, Mich. P.A. 1970

131648

For corners in

Oakland (county)	Located In: Rose Township	Corner Code #
1. Public Land Survey	T4N R7E	D-13
	T___ R___	_____
	T___ R___	_____
	T___ R___	_____
2. Property Controlling in Section	S___ T___ R___	_____
	S___ T___ R___	_____
3. Miscellaneous Property in Sec.	S___ T___ R___	_____
	S___ T___ R___	_____

LIBER 19843 PAGE 651  
\$9.00 MISC RECORDING  
\$2.00 REMONUMENTATION  
04/16/1999 08:59:50 A.M. RECEIPT# 19968  
PAID RECORDED - OAKLAND COUNTY  
G. WILLIAM CADDELL, CLERK/REGISTER OF DEEDS

Compliance with  
ACT 345, P.A. 1990

APPROVED ON: 3-18-98 JS  
OAKLAND COUNTY REMONUMENTATION  
PEER GROUP COMMITTEE

Register of Deeds Stamp & File Number

4. Lot No. \_\_\_\_\_, Recorded Plat \_\_\_\_\_
5. Private Claims \_\_\_\_\_

I, Joseph C. Kapelczak, in a field survey on April 28, 1998, do hereby certify that under requirements of P.A. 74, Michigan P.A. of 1970, the corner points mentioned in lines 1 and 2 above were in conformance with regulations and rules therefore as required in the current manual of survey instructions of the United States Department of the Interior, Bureau of Land Management or by a decree of a Court of Law and/or that the corner points mentioned in lines 3, 4 and 5 above were in conformance with the rules of the Michigan Board of Land Surveyors or by a Decree of a Court of Law; established, re-established, monumented, re-monumented, recovered, found as expressed below:

	A	B	C	D	E	F	G	H	I	J	K	L	N
2	6		5		4		3		2		1		
3													
4	7		8		9		10		11		12		
5													
6	16		17		18		15		14		13		
7													
8	19		20		21		22		23		24		
9													
10	30		29		28		27		26		25		
11													
12	31		32		33		34		35		36		
13													

**NOTE: Not more than 4 corners, all in the same town and range, may be recorded on this certificate.**

A. Description of original monument and accessories and/or subsequent restoration:

Set post in 1816 G.L.O. Survey.  
There are two LCRC's recorded at Oakland County; Albright 1976 and Ward 1984. One witness was recovered from the Albright LCRC and two witnesses were recovered from the Grant Ward LCRC.

B. Description of corner evidence found and/or method applied in restoring or reestablishing corner:

Recovered a 7/8" pipe at this location. Validated location with monumentation recovered along south line of S/P #1.

Recovered Witnesses:

- \*S 50°W 7.06' PK nail with Grant Ward tag east side 18" Oak.
- \*West 32.97' spike and washer #22445 in north side 20" Oak.

C. Description of monument for corner and accessories established to perpetuate locating the position of the corner:

Set Oakland County Remonumentation Brass Cap stamped #24598 with concrete monument.

Set Witnesses:

- N 65°E 11.79' Mag nail with OCRT #24598 northwest side 20" Hickory.
- N 10°E 17.60' Mag nail with OCRT #24598 east side 18" Oak.
- S 50°W 7.06' Mag nail with OCRT #24598 east side 18" Oak.
- West 32.91' Mag nail with OCRT #24598 north side 22" Oak.

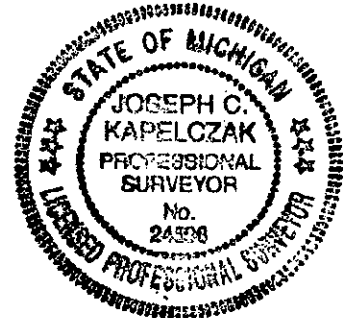

Signed by Joseph C. Kapelczak

Date 3/17/99

Surveyor's Michigan License No. 24598