

MAY 24 2000

SECTION

LAND CORNER RECORDATION CERTIFICATE  
Filing Requirement of Act 74, Mich. P.A. 1970

127810

For corners in

Oakland (county)	Located In: Rose Township	Corner Code #
1. Public Land Survey	T4N R7E	M-2
	T R	
	T R	
	T R	
2. Property Controlling in Section	S T R	
	S T R	
3. Miscellaneous Property in Sec.	S T R	
	S T R	

LIBER 21403 PAGE 399  
 \$9.00 MISC RECORDING  
 \$2.00 REMONUMENTATION  
 05/19/2000 10:35:44 A.M. RECEIPT# 36329  
 PAID RECORDED - OAKLAND COUNTY  
 G. WILLIAM CADDELL, CLERK/REGISTER OF DEEDS

Compliance with  
 ACT 345, P.A. 1990  
 APPROVED ON: 5-4-95 JS  
 OAKLAND COUNTY REMONUMENTATION  
 REFER GROUP COMMITTEE  
 Register of Deeds Stamp & File Number

- 4. Lot No. \_\_\_\_\_, Recorded Plat \_\_\_\_\_
- 5. Private Claims \_\_\_\_\_

I, Joseph C. Kapelczak, in a field survey on August 5, 1998, do hereby certify that under requirements of P.A. 74, Michigan P.A. of 1970, the corner points mentioned in lines 1 and 2 above were in conformance with regulations and rules therefore as required in the current manual of survey instructions of the United States Department of the Interior, Bureau of Land Management or by a decree of a Court of Law and/or that the corner points mentioned in lines 3, 4 and 5 above were in conformance with the rules of the Michigan Board of Land Surveyors or by a Decree of a Court of Law; established, re-established, monumented, re-monumented, recovered, found as expressed below:

	A	B	C	D	E	F	G	H	I	J	K	L	M
2	6	5	4	3	2	1							
3													
4	7	8	9	10	11	12							
5													
6	16	17	18	15	14	13							
7													
8	19	20	21	22	23	24							
9													
10	30	29	28	27	26	25							
11													
12	31	32	33	34	35	36							
13													

A. Description of original monument and accessories and/or subsequent restoration:

Set post in 1816 G.L.O. Survey.  
 There is one LCRC recorded at Oakland County; Ward 1993.

B. Description of corner evidence found and/or method applied in restoring or reestablishing corner:

No monumentation was recovered at this location. This location was re-established in the same manner that Ward's LCRC established the corner in 1993, and that is to set the corner half way between M-1 and M-3 on the line between M-1 and A-2 of Springfield Township. A-2 of Springfield Township is located 171.48' north of M-2 Rose Township.

Recovered Witnesses:

- S 34°E 30.05' nail with tag #22445 north side 16" Hickory.
- N 53°W 24.64' nail with tag #22445 southwest side 16" Oak.
- S 10°E 72.78' nail with tag #22445 west side 16' Oak.

C. Description of monument for corner and accessories established to perpetuate locating the position of the corner:

Found iron with Oakland County Remonumentation Brass Cap stamped #22445 in gravel road.

Set Witnesses:

- S 34°E 30.07' Mag nail with OCRT #24598 north side 18" Hickory.
- S 32°W 35.73' Mag nail with OCRT #24598 southeast side 8" Oak.
- N 53°W 25.56' Mag nail with OCRT #24598 south side 16" Oak.
- S 12°E 72.99' Mag nail with OCRT #24598 west side 16" Oak.

JP  
R

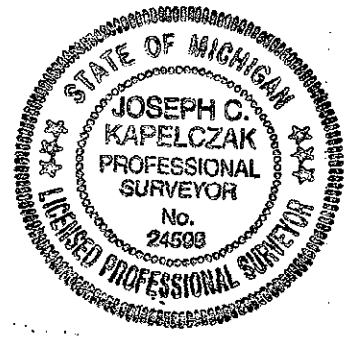

Signed by Joseph C. Kapelczak  
 Surveyor's Michigan License No. 24598

Date 5/15/2000