

LIBER 19012PC350

LAND CORNER RECORDATION CERTIFICATE
Filing Requirement of Act 74, Mich. P.A. 1970

\$ 7.00 MISCELLANEOUS RECORDING
\$ 2.00 REMONUMENTATION
2 OCT 98 8:44 A.M. RECEIPT PAID
RECORDED - OAKLAND COUNTY
LYNN D. ALLEN, CLERK/REGISTER OF DEEDS

For corners in

Table with columns: Oakland (county), Located In, Corner Code #. Rows include Public Land Survey, Property Controlling in Section, and Miscellaneous Property in Sec.

Compliance with ACT 345, P.A. 1990
APPROVED ON: 11-8-97 JS
OAKLAND COUNTY REMONUMENTATION
Register of Deeds Stamp # File Number

SECTION

4. Lot No. , Recorded Plat

5. Private Claims

I, James E. Kovas, in a field survey on September 16, 1997, do hereby certify that under requirements of P.A. 74, Michigan P.A. of 1970, the corner points mentioned in lines 1 and 2 above were in conformance with regulations and rules therefore as required in the current manual of survey instructions of the United States Department of the Interior, Bureau of Land Management or by a decree of a Court of Law and/or that the corner points mentioned in lines 3, 4 and 5 above were in conformance with the rules of the Michigan Board of Land Surveyors or by a Decree of a Court of Law; established, re-established, monumented, re-monumented, recovered, found as expressed below:

Grid table with columns A-M and rows 2-13. Contains numerical values for each cell.

NOTE: Not more than 4 corners, all in the same town and range, may be recorded on this certificate.

A. Description of original monument and accessories and/or subsequent restoration: B-13

- 1815 - Government Land Office Alex Holmes, D.S., Post set at standard corner
1969 - John Albright #10057 (Unrecorded survey) Iron set (By legend)
1973 - John Albright #10057 (LCRC Liber 6716 Page 748) Found 1/2" rerod
1975 - John Albright #10057 (Unrecorded survey) Found 1/2" rerod
1977 - James Smith #21582, found 1/2" pipe
1978 - John Albright #10057 (Unrecorded survey) no monument described
1992 - Brad Thompson #23828 (LCRC Liber 12373 Page 114) Found 1/2" iron
1995 - Tom Smith #31606 (Unrecorded survey) no monument described

Distances table with columns: Distances, B-13 to A-13, B-13 to C-13, B-13 to B-1 (W. Lake), B-13 to B-1 (W. Lake), B-13 to B-1 (W. Lake), B-13 to B-1 (W. Lake). Includes distances and survey references.

B. Description of corner evidence found and/or method applied in restoring or reestablishing corner: B-13 Found 1/2" rerod

700 FILE
200

WITNESS FOUND:

- S 80 W 5.14' Found nail in south side 8" Oak Found 5.15'
East 9.28' Set nail/flasher in south side 4" Maple Found 9.34'
S 15 W 22.17' Set nail/flasher east side 15" Oak Found 22.22'
S 35 W 10.58' Set nail/flasher southeast side 10" Hickory Found 10.64'

C. Description of monument for corner and accessories established to perpetuate locating the position of the corner: B-13 Set concrete monument with remon cap

- WIT: S 20 W 22.18 Set Remon Tag with Mag Nail in East face 12" Oak
West 5.28 Set Remon. Tag with Mag Nail in South face 9" Oak
S 85 E 9.25 Set Remon. Tag with Mag Nail in South face 7" Maple
N 10 E 42.18 Set Remon. Tag with Mag Nail in East face 14" Oak

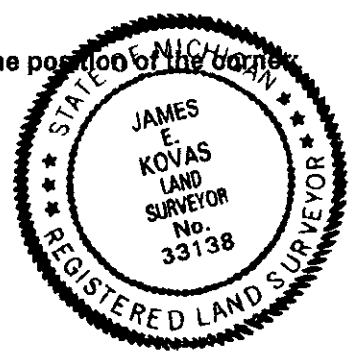

Signed by James E. Kovas Date 7/10/98

Surveyor's Michigan License No. 33138