

LIBER 190120354
LAND CORNER RECORDATION CERTIFICATE
 Filing Requirement of Act 74, Mich. P.A. 1970

For corners in

Oakland Located In: Corner Code #
 (county)

1. Public Land Survey T 4N R 8E E-13
 T ___ R ___
 T ___ R ___
 T ___ R ___ **SURVEY &**

2. Property Controlling S ___ T ___ R RE-ESTABLISHMENT
 in Section S ___ T ___ R ___

3. Miscellaneous S ___ T ___ R ___
 Property in Sec. S ___ T ___ R MAR 21 2000

\$ 7.00 MISCELLANEOUS RECORDING
 \$ 2.00 REMONUMENTATION
 2 OCT 98 8:45 A.M. RECEIPTS 8A
 PAID RECORDED - OAKLAND COUNTY
 LYNN D. ALLEN, CLERK/REGISTER OF DEEDS

Compliance with
 ACT 345, P.A. 1990
 APPROVED ON: 11-8-98 JS
 OAKLAND COUNTY REMONUMENTATION
 REGISTER OF DEEDS STAMP & FILE NUMBER

4. Lot No. _____, Recorded Plat _____ **SECTION**

5. Private Claims _____

I, James E. Kovas, in a field survey on September 15, 1997, do hereby certify that under requirements of P.A. 74, Michigan P.A. of 1970, the corner points mentioned in lines 1 and 2 above were in conformance with regulations and rules therefore as required in the current manual of survey instructions of the United States Department of the Interior, Bureau of Land Management or by a decree of a Court of Law and/or that the corner points mentioned in lines 3, 4 and 5 above were in conformance with the rules of the Michigan Board of Land Surveyors or by a Decree of a Court of Law; established, re-established, monumented, re-monumented, recovered, found as expressed below:

	A	B	C	D	E	F	G	H	I	J	K	L	M
2	6		5		4		3		2		1		
3													
4	7		8		9		10		11		12		
5													
6	13		17		16		15		14		13		
7													
8	19		20		21		22		23		24		
9													
10	30		29		28		27		26		25		
11													
12	31		32		33		34		35		36		
13													

NOTE: Not more than 4 corners, all in the same town and range, may be recorded on this certificate.

A. Description of original monument and accessories and/or subsequent restoration:
 E-13

- 1823- Government Land Office (G.L.O) Wampler, D.S., section standard corner set township line
- 1880- County Surveyors Records, no monument described
- 1972- N.C. Jones #2934 (LCRC Liber 6048 Page 661), found 1" pipe set by local firm
- 1980- Norman Fahrner #17620 (LCRC Liber 8000 Page 816), found 1" iron pipe
- 1981- Norman Fahrner #17620 (Washtenaw Engineering) (Unrecorded survey), found 1" iron pipe
- 1984- Sheldon Brown #17613 (Unrecorded survey), found 2" pipe

Distances:

E-13 to D-13	2662.68'	(Wade-Trim - 1997)
E-13 to E-1 (W.Lake Twp.)	84.48' ? (128 links?)	(Hard to read) - GLO - 1823)
E-13 to E-1 (W.Lake Twp.)	124' +/- east	(Albright - 1987)
E-13 to E-1 (W.Lake Twp.)	126.18' east	(Feldhauser - 1974)
E-13 to E-1 (W.Lake Twp.)	123.39/ east	(Wade-Trim set 1997)
E-13 to F-13	2660.82'	(Wade-Trim - 1997)

B. Description of corner evidence found and/or method applied in restoring or reestablishing corner:

E-13 Found 1" iron pipe

WITNESSES FOUND:

N 65 E 16.23' to 9" Walnut	Found stump	Found	16.23'
South 31.54' to 24" Oak		Found	31.52'
Southerly 31.55' to nail in 22" Oak		Found	31.52'
S 45 W 4.51' to nail in 8" Hickory		Found	4.48'
S 45 W 4.50' to 6" Sassafras		Found	4.48'
N 60 E 16.32' to 10" stump		Found	16.23'

700 feet
200

C. Description of monument for corner and accessories established to perpetuate locating the position of the corner:
 E-13 Set concrete monument with Remon Cap #33138

- WIT: S 80 W 12.05' Set Remon. Tag w/ mag nail in N face 10" Walnut
 S 60 W 4.38' Set Remon. Tag w/ mag nail in SE face 10" Walnut
 S 15 E 16.81' Set Remon. Tag w/ mag nail in W face 9" Walnut
 S 80 E 19.55' Set Remon. Tag w/ mag nail in S face 9" Dogwood

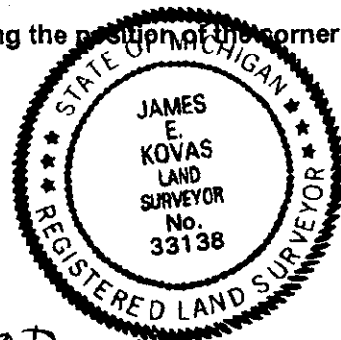

Signed by James E. Kovas Date 9/16/97

Surveyor's Michigan License No. 33138