

LAND CORNER RECORDATION CERTIFICATE  
Filing Requirement of Act 74, Mich. P.A. 1970

1900

For corners in

Oakland Located in: Holly Township Corner Code #  
(county)

1. Public Land Survey T 5N R 7E A-5  
T \_\_\_\_\_ R \_\_\_\_\_  
T \_\_\_\_\_ R \_\_\_\_\_  
T \_\_\_\_\_ R \_\_\_\_\_

2. Property Controlling S \_\_\_\_\_ T \_\_\_\_\_ R \_\_\_\_\_  
in Section S \_\_\_\_\_ T \_\_\_\_\_ R \_\_\_\_\_ **SURVEY &**  
3. Miscellaneous S \_\_\_\_\_ T \_\_\_\_\_ R \_\_\_\_\_ **REMONUMENTATION**  
Property in Sec. S \_\_\_\_\_ T \_\_\_\_\_ R \_\_\_\_\_ **MAR 21 2000**

LIBER 20945 PAGE 495  
\$7.00 MISC RECORDING  
\$2.00 REMONUMENTATION  
01/04/2000 07:37:46 A.M. RECEIPT# 342  
PAID RECORDED - OAKLAND COUNTY  
G. WILLIAM CABELL, CLERK/REGISTER OF DEEDS

Compliance with  
ACT 345, P.A. 1990

APPROVED ON: 8-4-99 JIL  
OAKLAND COUNTY REMONUMENTATION  
PEER GROUP COMMITTEE  
Register of Deeds Stamp & File Number

4. Lot No. \_\_\_\_\_ Recorded Plat SECTION

5. Private Claims \_\_\_\_\_

I, James E. Kovas, in a field survey on 7-27, 99, do hereby certify that under requirements of P.A. 74, Michigan P.A. of 1970, the corner points mentioned in lines 1 and 2 above were in conformance with regulations and rules therefore as required in the current manual of survey instructions of the United States Department of the Interior, Bureau of Land Management or by a decree of a Court of Law and/or that the corner points mentioned in lines 3, 4 and 5 above were in conformance with the rules of the Michigan Board of Land Surveyors or by a Decree of a Court of Law; established, re-established, monumented, re-monumented, recovered, found as expressed below:

NOTE: Not more than 4 corners, all in the same town and range, may be recorded on this certificate.

A. Description of original monument and accessories and/or subsequent restoration:

- A-5
- 1816 - G.L.O., Alex Holmes, D.S., post set
- 1994 - Wade-Trim (LCRC 1994 Genesee Remon corner) found 1/2" rerod for M5 Fenton, set 30" Bernsten steel tube with brass cap for Remon corner

- Distances:
- A-5 to A-4 = 2707.46' (Wade-Trim, 1999)
  - A-5 to A-6 = 2635.44' (Wade-Trim, 1999)
  - A-5 to A-6 = 2635.44' (McCoy, 1977)
  - A-5 to B-5 = 2725.47' (Wade-Trim, 1999)
  - A-5 to M-5 = 76.16' north

B. Description of corner evidence found and/or method applied in restoring or reestablishing corner:

A-5 No monument found at A-5.

A5 was searched for and not found.

This corner was re-set from irons found in Ray McCoy's land split. We found the northwest corner of Lot 1 (1" pipe) in the centeline intersection of Kurtz Road and Gage Road. We also found an iron at the northwest corner at the cul-de-sac of Lot 6. Using the established Fenton corners M5 and M6 we set A5, which falls 76.16' south of M5 (Fenton). This position and Mccoy's record distance was then used to reset A-6, which falls 38.09' south of M6 Fenton. This computed position of A6 falls in an old fenceline to the east. McCoy's corner for A6 was not found. This A6 corner as set was then checked against an iron found about 50' southeast of the center of cul-de-sac in McCoy's survey. By computation, our computed A6 agreed with this iron to within 3.17'. (46.83' versus 50')

We recommend that A5 and A6 as re-set from the McCoy survey be accepted.

C. Description of monument for corner and accessories established to perpetuate locating the position of the corner:

A-5 Set 5/8" rerod with Oakland County Remon disk.

- WIT:
- S 30 E 33.94' Set mag nail in West face 10" tree
  - N 20 E 52.85' Set mag nail in West face quad 8" tree
  - N 40 W 31.97' Set mag nail in NE face 4" Cluster
  - South 148.45' Set mag nail in West face 8" Oak tree

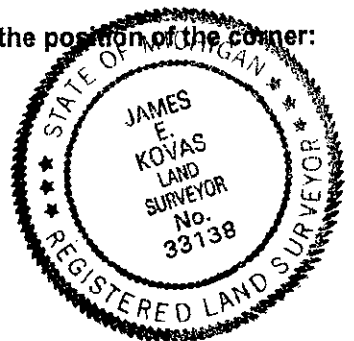

Signed by James E. Kovas Date 12/27/99

Surveyor's Michigan License No. 33138