

LAND CORNER RECORDATION CERTIFICATE
Filing Requirement of Act 74, Mich. P.A. 1970

1906

LIBER 20945 PAGE 501
\$7.00 MISC RECORDING
\$2.00 REMONUMENTATION
01/04/2000 07:37:46 A.M. RECEIPT# 342
PAID RECORDED - OAKLAND COUNTY
G. WILLIAM CADDELL, CLERK/REGISTER OF DEEDS

For corners in

Oakland Located In: Corner Code #
(county)
1. Public Land Survey T 5N R 7E A-11
T ___ R ___
T ___ R ___ SURVEY &
T ___ R ___ RE-ESTABLISHMENT
2. Property Controlling S ___ T ___ R ___
in Section S ___ T ___ R ___
3. Miscellaneous S ___ T ___ R ___
Property in Sec. S ___ T ___ R ___
MAR 21 2000

Compliance with
ACT 345, P.A. 1990
APPROVED ON: 8-4-99 JR
OAKLAND COUNTY REMONUMENTATION
PEER GROUP COMMITTEE
Register of Deeds Stamp & File Number

SECTION

4. Lot No. _____, Recorded Plat _____
5. Private Claims _____

I, James E. Kovas, in a field survey on December 17, 1999, do hereby certify that under requirements of P.A. 74, Michigan P.A. of 1970, the corner points mentioned in lines 1 and 2 above were in conformance with regulations and rules therefore as required in the current manual of survey instructions of the United States Department of the Interior, Bureau of Land Management or by a decree of a Court of Law and/or that the corner points mentioned in lines 3, 4 and 5 above were in conformance with the rules of the Michigan Board of Land Surveyors or by a Decree of a Court of Law; established, re-established, monumented, re-monumented, recovered, found as expressed below:

	A	B	C	D	E	F	G	H	I	J	K	L	M
2	6	5	4	3	2	1							
3													
4	7	8	9	10	11	12							
5													
6	13	14	15	16	17	18							
7													
8	19	20	21	22	23	24							
9													
10	25	26	27	28	29	30							
11													
12	31	32	33	34	35	36							
13													

NOTE: Not more than 4 corners, all in the same town and range, may be recorded on this certificate.

A. Description of original monument and accessories and/or subsequent restoration:

- A-11
1816 - G.L.O., Alex Holmes, D.S., post set
1950 - Miner Park Subdivision (Liber 61, Page 34) no monument described
1973 - John Albright #10057 (LCRC Liber 6373, Page 884) found 3/4" pipe
1994 - Wade-Trim (M-11 LCRC 1994 Genesee Remon corner) found P.K. nail per cornerstone survey; accepted by Genesee Peer Review and replaced with Genesee 30" tube and cap

Distances: A-11 to A-10 = 2639.64' (Wade-Trim, 1999)
A-11 to A-12 = 2674.53' (Wade-Trim, 1999)
A-11 to B-11 = 2618.21' (Wade-Trim, 1999)
A-11 to M-11 (Fenton) 16.11' south (Wade-Trim, 1999)

B. Description of corner evidence found and/or method applied in restoring or reestablishing corner:

A-11 Found 3/4" pipe in bituminous shoulder.

WITNESSES FOUND:

N 60 E 67.73' to power pole found 67.68'
South 40.32' to power pole found 40.30'
Distance from M -11 north to M-10 (A-10 common) 2655.76' found 2655.69'
Found iron at Southwest corner Lot 1 Miner Park 78.00' found 77.0'

As per Oakland Peer Review instructions, the section corner will be set on the Fenton Township line. This will place the new corner 0.82' east of the existing 3/4" pipe found in the bituminous shoulder. The existing 3/4" pipe now becomes a controlling property corner (CPC).

C. Description of monument for corner and accessories established to perpetuate locating the position of the corner:

A-11 Set 5/8" iron with remon cap in monument box at 0.83' East of controlling property corner.

WIT: N 15 W 67.73' P.K. w/tag #33138 36" Pine
N 45 E 68.41' P.K. w/tag #33138 power pole
S 1 W 40.40' P.K. w/tag #33138 light pole
N 50 W 34.90' P.K. w/tag #33138 18" Pine

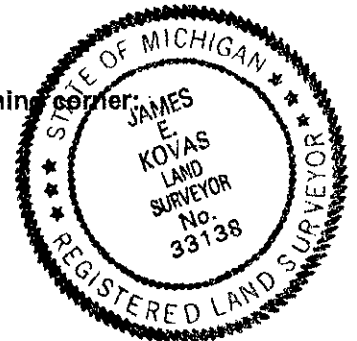

Signed by James E. Kovas Date 12/23/99

Surveyor's Michigan License No. 33138