

LIBER 20945 PAGE 535  
\$7.00 REC'D RECORDING  
\$2.00 REDEMPTION  
01/09/2000 07:37:46 A.M. RECEIPT# 342  
PAID RECORDED - DAN AND COUNTY  
G. WALLON CORP., CLERK/REGISTRAR OF DEEDS

LAND CORNER RECORDATION CERTIFICATE  
Filing Requirement of Act 74, Mich. P.A. 1970

For corners in

<u>Oakland</u> (county)	Located In:	Corner Code #
1. Public Land Survey	Holly Township T. <u>5N</u> R. <u>7E</u> _____ E-9	
	T. _____ R. _____	
	T. _____ R. _____	
	T. _____ R. _____	
2. Property Controlling S _____ in Section S _____	T. _____ R. _____	
3. Miscellaneous S _____ Property in Sec. S _____	T. _____ R. _____	

RECORDED  
9-23-98 JJ  
Register of Deeds Stamp & File Number

SECTION

4. Lot No. \_\_\_\_\_, Recorded Plat \_\_\_\_\_

5. Private Claims \_\_\_\_\_

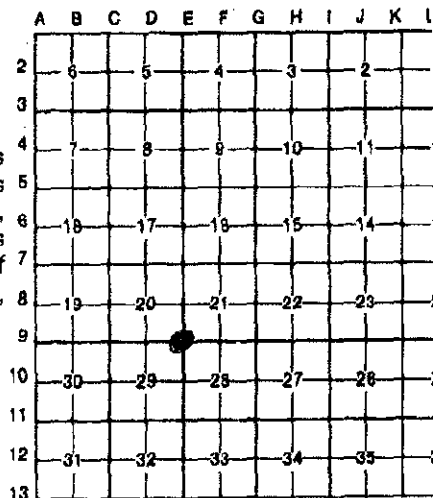

I, James E. Kovas, in a field survey on July 17, 1998, do hereby certify that under requirements of P.A. 74, Michigan P.A. of 1970, the corner points mentioned in lines 1 and 2 above were in conformance with regulations and rules therefore as required in the current manual of survey instructions of the United States Department of the Interior, Bureau of Land Management or by a decree of a Court of Law and/or that the corner points mentioned in lines 3, 4 and 5 above were in conformance with the rules of the Michigan Board of Land Surveyors or by a Decree of a Court of Law; established, re-established, monumented, re-monumented, recovered, found as expressed below:

NOTE: Not more than 4 corners, all in the same town and range, may be recorded on this certificate.

A. Description of original monument and accessories and/or subsequent restoration:

- E-9  
1816 - G.L.O., Alex Holmes, D.S., set post
- 1972 - John Albright #10057 (LCRC Liber 6002, Page 508) found monument box
- 1978 - John Albright #10057 (LCRC Liber 11533, Page 437 and Liber 11337, Page 232) found 1/2" iron monument box
- 1995 - Grant Ward #2245 (LCRC Liber 16476, Page 608) found iron rod in monument box

- Distances:
- E-9 to E-8 = 2627.91' (Wade-Trim, 1998)
  - E-9 to E-8 = 2627.61' (Newman, 1991)
  - E-9 to E-10 = 2645.11' (Wade-Trim, 1998)
  - E-9 to E-10 = 2645.08' (Newman, 1988)
  - E-9 to D-9 = 2636.18' (Wade-Trim, 1999)
  - E-9 to F-9 = 2628.44' (Wade-Trim, 1999)
  - E-9 to F-9 = 2630.20' (Albright, 1978)
  - E-9 to F-9 = 2630.20' (Newman, 1988)

B. Description of corner evidence found and/or method applied in restoring or reestablishing corner:

E-9 Found 1/2" iron in monument box.

WITNESSES FOUND:

- N 60 E 69.30' to power pole found 69.25'
- S 45 E 46.80' to fence corner post found 47.90'
- West 33.50' to fence corner post found 33.70'
- N 60 E 69.30' to power pole found 69.25'
- S 45 E 47.80' to fence corner post found 47.90'
- West 33.50' to fence corner post found 33.70'
- N 45 E 44.75' to Set P.K. and disc #22445 in SE face 14" Elm found 44.82'

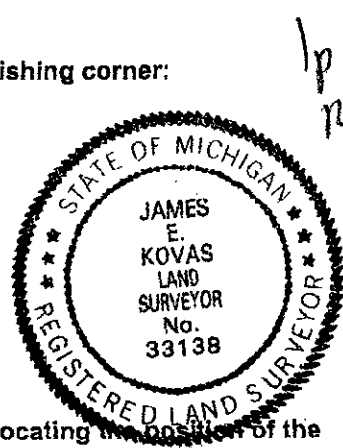

C. Description of monument for corner and accessories established to perpetuate locating the position of the corner:

E-9 Found 1/2" iron in monument box. Set cap #33138.

- WIT:
- N 53 E 44.70' Set P.K./tag #33138 South face 14" Elm
  - N 30 W 43.34' Set P.K./tag #33138 East face 6" Hickory
  - S 40 W 43.93' Set P.K./tag #33138 NW face 12" Maple
  - S 32 E 59.51' Set P.K./tag #33138 SW face 6" Elm

Signed by James E. Kovas Date 12/22/99

Surveyor's Michigan License No. 33138