

LAND CORNER RECORDATION CERTIFICATE
Filing Requirement of Act 74, Mich. P.A. 1970

1943

For corners in

Oakland Located In: Corner Code #
(county)

Holly Township
1. Public Land Survey T 5N R 7E E-12
T R
T R
T R SURVEY &
T R RE-ESTABLISHMENT
2. Property Controlling S T R
in Section S T R
3. Miscellaneous S T R
Property in Sec. S T R MAR 21 2000

LIBER 20945 PAGE 538
42.00 MISC RECORDING
32.00 REMONUMENTATION
01/04/2000 07:37:46 A.M. RECEIPT# 342
PAID RECORDED - OAKLAND COUNTY
G. WILLIAM CROWELL, CLERK/REGISTER OF DEEDS

10-28-98 53
REGISTER OF DEEDS

Register of Deeds Stamp & File Number

SECTION

4. Lot No. _____, Recorded Plat _____

5. Private Claims _____

I, James E. Kovas, in a field survey on July 16, 1998, do hereby certify that under requirements of P.A. 74, Michigan P.A. of 1970, the corner points mentioned in lines 1 and 2 above were in conformance with regulations and rules therefore as required in the current manual of survey instructions of the United States Department of the Interior, Bureau of Land Management or by a decree of a Court of Law and/or that the corner points mentioned in lines 3, 4 and 5 above were in conformance with the rules of the Michigan Board of Land Surveyors or by a Decree of a Court of Law; established, re-established, monumented, re-monumented, recovered, found as expressed below:

NOTE: Not more than 4 corners, all in the same town and range, may be recorded on this certificate.

A. Description of original monument and accessories and/or subsequent restoration:

- E-12
- 1816 - G.L.O., Alex Holmes, D.S., set post
- 1965 - Oakland County Road Commission (section ties) 1/2" iron pin
- 1979 - John Albright #10057 (LCRC Liber 7455, Page 860) found 1/2" rerod
- 1992 - Chris Newman #24607 (LCRC Liber 12501, Page 325) found 1/2" rerod in monument box

Distances: E-12 to E-11 = 2651.19' (Wade-Trim, 1999)
E-12 to E-13 = 2646.02' (Wade-Trim, 1998)
E-12 to E-13 = 2645.63' (Newman, 1991)

B. Description of corner evidence found and/or method applied in restoring or reestablishing corner:

E-12 Found 1/2" iron in monument box.

WITNESSES FOUND:

NE	55.41' to spike in DEP (may be same pole)	found	56.02'
N 45E	55.25' to PP	found	56.02'
S 25 W	58.75' to 15" Walnut	found	58.75'
N 20 W	76.58' to telephone pole	found	76.15'

C. Description of monument for corner and accessories established to perpetuate locating the position of the corner:

E-12 Found 1/2" iron in monument box. Set cap #33138.

WIT: N 45 E 55.98' Set P.K. w/Remon tag #33138 NW face power pole
S 46 E 64.72' Set P.K. w/Remon tag #33138 NE face
S 25 W 58.74' Set P.K. w/Remon tag #33138 East face 18" Walnut
N 20 W 76.28' Set P.K. w/Remon tag #33138 East face telephone pole

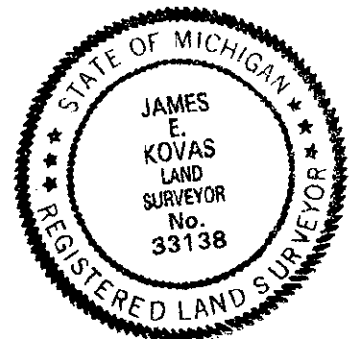

Signed by James E. Kovas

Date 12/22/99

Surveyor's Michigan License No. 33138

