

LAND CORNER RECORDATION CERTIFICATE
Filing Requirement of Act 74, Mich. P.A. 1970

1973

LIBER 20945 PAGE 568
\$7.00 MISC RECORDING
\$2.00 REMONUMENTATION
01/04/2000 07:37:46 A.M. RECEIPT# 341
PAID RECORDED - OAKLAND COUNTY
G. WILLIAM CADDELL, CLERK/REGISTER OF

For corners in

Oakland Located In: Holly Township Corner Code #
(county)
1. Public Land Survey T 5N R 7E I-6
T R
T R
T R
2. Property Controlling S T R
in Section S T R
3. Miscellaneous S T R
Property in Sec. S T R

Conformable with
ACT 74, P.A. 1990
9-23-98 53
APPROVED ON: 9-23-98 53
LAND COUNTY REMONUMENTATION
Register of Deeds Stamp & File Number

SECTION

4. Lot No. _____, Recorded Plat _____

5. Private Claims _____

	A	B	C	D	E	F	G	H	I	J	K
2	6	5	4	3	2						
3											
4	7	8	9	10	11						
5											
6	16	17	18	15	14						
7											
8	19	20	21	22	23						
9											
10	30	29	28	27	26						
11											
12	31	32	33	34	35						
13											

I, James E. Kovas, in a field survey on July 17, 1998, do hereby certify that under requirements of P.A. 74, Michigan P.A. of 1970, the corner points mentioned in lines 1 and 2 above were in conformance with regulations and rules therefore as required in the current manual of survey instructions of the United States Department of the Interior, Bureau of Land Management or by a decree of a Court of Law and/or that the corner points mentioned in lines 3, 4 and 5 above were in conformance with the rules of the Michigan Board of Land Surveyors or by a Decree of a Court of Law; established, re-established, monumented, re-monumented, recovered, found as expressed below:

NOTE: Not more than 4 corners, all in the same town and range, may be recorded on this certificate.

A. Description of original monument and accessories and/or subsequent restoration:

- I-6
- 1816 - G.L.O., Alex Holmes, D.S., set post
- 1973 - John Albright #10057 (LCRC Liber 6373, Page 884 and Survey Liber 6002, Page 493) found 5/8" rerod
- 1984 - Delton Lohff #13791, found 5/8" rerod
- 1988 - Chris Newman #24607 (Survey Liber 10519, Page 641) no monument described

Distances: I-6 to I-5 = 2635.57' (Wade-Trim, 1999)
I-6 to I-5 = 2633.16' (Newman, 1990)

I-6 to I-7 = 2647.94' (Wade-Trim, 1998)
I-6 to I-7 = 2648.77' (Newman, 1988)
I-6 to I-7 = 2648.77' (Albright, 1973)

B. Description of corner evidence found and/or method applied in restoring or reestablishing corner:

I-6 Found 5/8" iron.

East	33.00'	to 1/2" rerod	found	33.04'
S 20 W	29.3'	to 30" Oak	found	29.28'
West	33.0'	to 1/2" rerod	found	33.06'
N 25 W	58.35'	to 36" Oak	found	58.30'
East	33.0'	to 1/2" rerod	found	33.04'
West	33.0'	to 1/2" rerod	found	33.06'
S 20 W	29.3'	to 30" Oak	found	29.28'

C. Description of monument for corner and accessories established to perpetuate locating the position of the corner:

I-6 Found 5/8" iron. Set remon cap #33138.

WIT: N 11 W 58.28' Set P.K./tag #33138 East face 42" Oak
N 30 E 68.96' Set P.K./tag #33138 South face 10" Basswood
S 41 W 29.89' Set P.K./tag #33138 East face 32" Oak
S 23 E 45.90' Set P.K./tag #33138 NE face 14" Oak

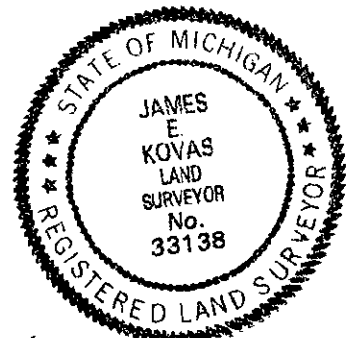

Signed by James E. Kovas Date 12/22/99

Surveyor's Michigan License No. 33138