

LAND CORNER RECORDATION CERTIFICATE  
Filing Requirement of Act 74, Mich. P.A. 1970

1975

For corners in

Oakland Located In: Holly Township Corner Code #  
(county)

1. Public Land Survey T 5N R 7E I-8  
T    R    SURVEY &  
T    R    RE-MONUMENTATION

2. Property Controlling S    T    R      
in Section S    T    R    MAR 21 2000

3. Miscellaneous S    T    R      
Property in Sec. S    T    R      
SECTION

LIBER 20945 PAGE 570  
\$7.00 MISC RECORDING  
\$2.00 REMONUMENTATION  
01/04/2000 07:37:46 A.M. RECEIPT# 342  
PAID RECORDED - OAKLAND COUNTY  
G. WILLIAM CADDELL, CLERK/REGISTER OF DEEDS

1-5-99 JS  
Register of Deeds Stamp & File Number

4. Lot No. \_\_\_\_\_, Recorded Plat \_\_\_\_\_  
5. Private Claims \_\_\_\_\_

A	B	C	D	E	F	G	H	I	J	K
2	6	5	4	3	2					
3										
4	7	8	9	10	11					
5										
6	16	17	18	15	14					
7										
8	19	20	21	22	23					
9										
10	30	29	28	27	26					
11										
12	31	32	33	34	35					
13										

I, James E. Kovas, in a field survey on December 11, 1998, do hereby certify that under requirements of P.A. 74, Michigan P.A. of 1970, the corner points mentioned in lines 1 and 2 above were in conformance with regulations and rules therefore as required in the current manual of survey instructions of the United States Department of the Interior, Bureau of Land Management or by a decree of a Court of Law and/or that the corner points mentioned in lines 3, 4 and 5 above were in conformance with the rules of the Michigan Board of Land Surveyors or by a Decree of a Court of Law; established, re-established, monumented, re-monumented, recovered, found as expressed below:

NOTE: Not more than 4 corners, all in the same town and range, may be recorded on this certificate.

A. Description of original monument and accessories and/or subsequent restoration:  
I-8  
1816 - G.L.O., Alex Holmes, D.S., set post  
1977 - John Albright #10057 (LCRC Liber 7077, Page 264) found 5/8" rerod  
1988 - Chris Newman #24607 (Liber 10519, Page 641) no monument described  
1995 - Grant Ward #22445 (LCRC Liber 15519, Page 23) found 5/8" iron rod

Distances: I-8 to I-9 = 2630.67' (Wade-Trim, 1998)  
I-8 to I-7 = 2641.24' (Wade-Trim, 1998)  
I-8 to I-7 = 2641.28' (Albright, 1988)  
I-8 to I-7 = 2641.24' (Tax map)

B. Description of corner evidence found and/or method applied in restoring or reestablishing corner:  
I-8 Found 5/8" iron.

East	33.00'	to 1/2" rerod	found	32.88'
West	67.29'	to power pole	found	67.35'
N 20 E	66.30'	to set P.K./disc #22445 in West face 8" Oak	found	66.31'
East	33.00'	to found 1/2" iron rod	found	32.88'
S 20 W	44.41'	to set P.K./disc #22445 in NW face 14" Maple	found	44.42'
West	67.29'	to found P.K. and Gould disc in East face utility pole	found	67.35'

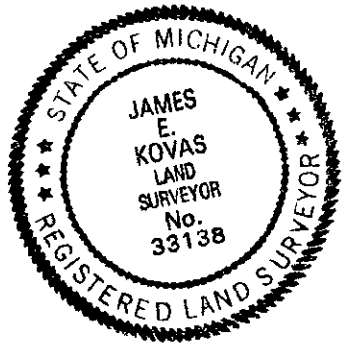

Signed by James E. Kovas Date 12/23/99

Surveyor's Michigan License No. 33138