

LAND CORNER RECORDATION CERTIFICATE
Filing Requirement of Act 74, Mich. P.A. 1970

2013

For corners in

Oakland Located in: Corner Code #
(county)

1. Public Land Survey T 5N R 7E M-9
T _____ R _____
T _____ R _____
T _____ R _____

2. Property Controlling S _____ T _____ R _____
in Section S _____ T _____ R _____

3. Miscellaneous S _____ T _____ R _____
Property in Sec. S _____ T _____ R _____

MAR 21 2000

LIBER 20945 PAGE 608
\$7.00 MISC RECORDING
\$2.00 REMONUMENTATION
01/04/2000 07:37:46 A.M. RECE
PAID RECORDED - OAKLAND COU
G. WILLIAM CADDELL, CLERK/REGI

3-3-99 JS
Register of Deeds Stamp & File Number

4. Lot No. _____, Recorded Plat _____ SECTION _____

5. Private Claims _____

A	B	C	D	E	F	G	H	I	J	K
2	6	5	4	3	2					
3										
4	7	8	9	10	11					
5										
6	18	17	16	15	14					
7										
8	19	20	21	22	23					
9										
10	30	29	28	27	26					
11										
12	31	32	33	34	35					
13										

I, James E. Kovas, In a field survey on September 16, 1998, do hereby certify that under requirements of P.A. 74, Michigan P.A. of 1970, the corner points mentioned in lines 1 and 2 above were in conformance with regulations and rules therefore as required in the current manual of survey instructions of the United States Department of the Interior, Bureau of Land Management or by a decree of a Court of Law and/or that the corner points mentioned in lines 3, 4 and 5 above were in conformance with the rules of the Michigan Board of Land Surveyors or by a Decree of a Court of Law; established, re-established, monumented, re-monumented, recovered, found as expressed below:

NOTE: Not more than 4 corners, all in the same town and range, may be recorded on this certificate.

A. Description of original monument and accessories and/or subsequent restoration:

- M-9
- 1816 - G.L.O., Alex Holmes, D.S., set post
- 1979 - Fred King #25852 (LCRC Liber 7542, Page 810) found 1" iron bar in monument box
- 1984 - Donald Bissell #18655 (LCRC Liber 8839, Page 257) found iron in monument box
- 1992 - Huston Kennedy #17623 (LCRC Liber 12773, Page 524) found railroad spike in monument box located in the shoulder of I-75 Northbound ramp

- Distances:
- M-9 to M-10 = 2617.07' (Wade-Trim, 1998)
 - M-9 to M-8 = 2690.44' (Wade-Trim, 1998)
 - M-9 to L-9 = 2675.84' (Wade-Trim, 1998)
 - M-9 to A-9 = (Groveland) 392.26' North (Wade-Trim/Kieft, 1998)
 - M-9 to A-9 = (Groveland) 392.39' North (Oakland Co. Road Comm., 1959)

B. Description of corner evidence found and/or method applied in restoring or reestablishing corner:

M-9 Found 1" iron in monument box.

WITNESSES FOUND:

- | | | | |
|---------------|--|-------|--------|
| N 20 E 94.71' | to 14" Oak | found | 94.53' |
| N 40 E 4.60' | edge of bituminous ramp | found | 4.60' |
| N 82 W 48.60' | to catchbasin | found | 48.60' |
| N 85 W 48.38' | to center of catchbasin rim | found | 48.50' |
| N 85 W 73.00' | to east edge of pavement-northbound lane | found | 73.00' |
| North 5.00' | to edge of pavement of ramp | found | 4.60' |

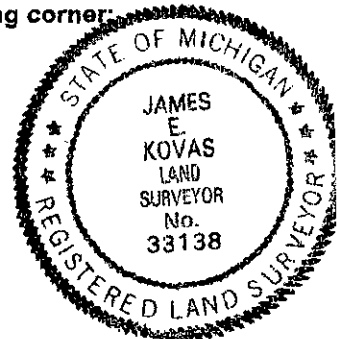

C. Description of monument for corner and accessories established to perpetuate locating the position of the corner:

M-9 Found 1" iron rod in monument box. Removed and replaced with 5/8" iron with cap #33138.

- WIT:
- N 20 E 94.73' Set nail w/tag #33138 16" Oak
 - S 80 E 165.22' Set nail w/tag #33138 West end guard post
 - S 30 E 116.95' Set nail w/tag #33138 6" Hemlock

Signed by James E. Kovas Date 12/23/99

Surveyor's Michigan License No. 33138