

LAND CORNER RECORDATION CERTIFICATE  
Filing Requirement of Act 74, Mich. P.A. 1970

2016

For corners in

Oakland Located In: Holly Township Corner Code #  
(county)

1. Public Land Survey T 5N R 7E M-12  
T R  
T R  
T R

2. Property Controlling S T R  
in Section S T R

3. Miscellaneous S T R  
Property in Sec. S T R

LIBER 20945 PAGE 611  
\$7.00 MISC RECORDING  
\$2.00 REMONUMENTATION  
01/04/2000 07:37:46 A.M. RECEIPT# 342  
PAID RECORDED - OAKLAND COUNTY  
S. WILLIAM CABDELL, CLERK/REGISTER OF DEEDS

Register of Deeds Stamp & File Number

4. Lot No. \_\_\_\_\_, Recorded Plat \_\_\_\_\_ SECTION  
5. Private Claims \_\_\_\_\_

A	B	C	D	E	F	G	H	I	J	K	L
2	6	5	4	3	2	1					
3											
4	7	8	9	10	11	12					
5											
6	16	17	18	19	20	21	22	23	24	25	26
7											
8	19	20	21	22	23	24	25	26	27	28	29
9											
10	30	29	28	27	26	25	24	23	22	21	20
11											
12	31	32	33	34	35	36					
13											

I, James E. Kovas, in a field survey on September 16, 1998, do hereby certify that under requirements of P.A. 74, Michigan P.A. of 1970, the corner points mentioned in lines 1 and 2 above were in conformance with regulations and rules therefore as required in the current manual of survey instructions of the United States Department of the Interior, Bureau of Land Management or by a decree of a Court of Law and/or that the corner points mentioned in lines 3, 4 and 5 above were in conformance with the rules of the Michigan Board of Land Surveyors or by a Decree of a Court of Law; established, re-established, monumented, re-monumented, recovered, found as expressed below:

NOTE: Not more than 4 corners, all in the same town and range, may be recorded on this certificate.

A. Description of original monument and accessories and/or subsequent restoration:

- M-12 1816 - G.L.O., Alex Holmes, D.S., set post
- 1972 - Gary Stonerock #13601 (LCRC Liber 5830, Page 549) found 1" pipe with cap
- 1984 - Donald Bissell #18655 (LCRC Liber 8839, Page 265) found 1" pipe with brass cap (set by D. Scott in 1962)
- 1991 - Huston Kennedy #17623 (LCRC Liber 12168, Page 645) found 1" iron pipe with 3" cap 300' east of Holly Road
- 1985 - Grant Ward #22445 (Survey Liber 9122, Page 752 and Liber 17074, Page 844) found 1" pipe and cap

- Distances:
- M-12 to M-13 = 2649.47' (Wade-Trim, 1998)
  - M-12 to M-13 = 2649.36' (Ward, 1997)
  - M-12 to M-13 = 2649.36' (Newman, 1993)
  - M-12 to M-11 = 2658.37' (Wade-Trim/Kieft, 1998)
  - M-12 to A-12 = (Groveland) 130.32' North (Kieft, 1998)

B. Description of corner evidence found and/or method applied in restoring or reestablishing corner:

M-12 Found 1" pipe with cap.

WITNESSES FOUND:

- S 50 E 7.01' to 4" Elm (cluster of Elms) found 9.02'
- East 6.93' to P.K./w in S face 32" Boxelder found 6.93'
- S 45 E 8.91' to P.K./w in SW face 8" Elm found 9.02'
- S 40 E 7.00' to n/w in SW face 5" Elm found 6.93'

lp  
R

C. Description of monument for corner and accessories established to perpetuate locating the position of the corner:

M-12 Found 1" iron pipe. Removed and replaced with concrete monument.

- WIT:
- South 21.83' Set nail w/tag #33138
  - S 60 E 9.05' Set nail w/tag #33138
  - N 40 E 90.08' Set nail w/tag #33138

NOTE: East edge of cattail swamp

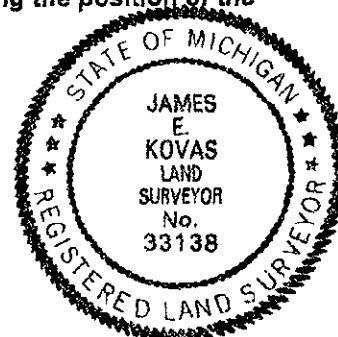

Signed by James E. Kovas

Date 12/23/99

Surveyor's Michigan License No. 33138