

MICHIGAN  
DEPARTMENT OF CONSERVATION  
FORESTRY DIVISION  
PARKS

LAND CORNER RECORD

T. 405 N.R. 708 E

Oakland COUNTY

DESCRIPTION OF CORNER Township Co Common to Holly, Rose, Grovesland, & Springfield Townships.

CORNER MONUMENT 1" Iron pipe 12" below Rd.

DATE MONUMENT PLACED AND WITNESSED 13 July 62

WITNESSES TO CORNER..... N 13° 30' W 90.0 ft 8" hickory

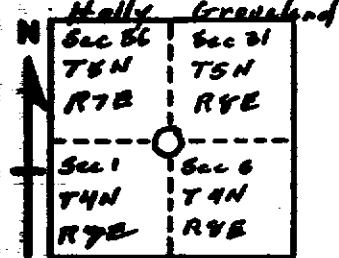

N 68° 00' E 53.83 ft 7" hickory

S 47° 30' E 41.48 ft 36" hickory

AND S 46° 30' W 42.18 ft 32" hickory

CIRCLE CORNER REGISTERED  
Rose Springfield

DESCRIPTION IN DETAIL AS TO HOW CORNER WAS LOCATED AND IDENTIFIED OR RESTORED.

*Recovered from witnesses furnished  
by Oakland Co. Rd. Comm.*

*All witnesses PK nails with Brass  
Tags stamped R.L.S 12029.*

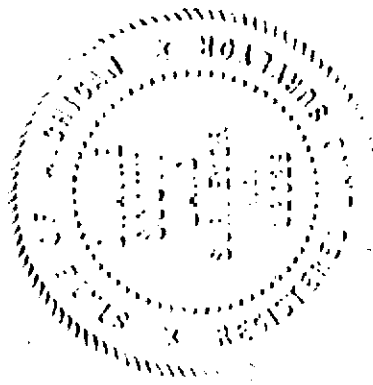

SURVEYOR'S SEAL

SIGNED *James H. Holtz* DATE 7-22-62  
REGISTERED LAND SURVEYOR