

MAR 21 2000

COPY

LIDER 21119 677

51725 SECTION

LAND CORNER RECORDATION CERTIFICATE
Filing Requirement of Act 74, Mich. P.A.

LIDER 21119 PAGE 677
MISC RECORDING 97.00
REMONUMENTATION 1870
02/18/2000 02:36:29 P.M. RECEIPT# 14203
PAID RECORDED - OAKLAND COUNTY
G. WILLIAM CADDELL, CLERK/REGISTER OF DEEDS

For corners in Oakland (County) Located In: GROVELAND Corner Code # _____

1. Public Land Survey	T	<u>5N</u>	R	<u>8E</u>	<u>B-13</u>	
	T	_____	R	_____	_____	
	T	_____	R	_____	_____	
	T	_____	R	_____	_____	
2. Property Controlling in Section	S	_____	T	_____	R	_____
	S	_____	T	_____	R	_____
3. Miscellaneous Property in Section	S	_____	T	_____	R	_____
	S	_____	T	_____	R	_____

4. Lot No. _____, Recorded Plat _____
5. Private Claims _____

1-27-99 JA

Register of Deeds Stamp & File Number

	A	B	C	D	E	F	G	H	I	J	K	L	M
2	6			5				4			3		2
3													
4	7								10			11	12
5													
6	18			17				16			15		14
7													
8	19								20			21	22
9													
10	30										28		27
11													
12	31											35	
13													

I, Timothy J. Hart, in a field survey on 2-12, 19 98, do hereby certify that under requirements of P.A. 74, Michigan P.A. of 1970, the corner points mentioned in lines 1 and 2 above were in conformance with regulations and rules therefore as required in the current manual of survey instructions of the United States Department of the Interior, Bureau of Land Management or by a decree of a Court of Law and/or that the corner points mentioned in lines 3, 4 and 5 above were in conformance with the rules of the Michigan Board of Professional Surveyors or by a Decree of a Court of Law; established, re-established, monumented, re-monumented, recovered, found as expressed below:

NOTE: Not more than 4 corners, all in the same town and range, may be recorded on this certificate.

A. Description of original monument and accessories and/or subsequent restoration:

Post set in 1815 G.L.O. survey; 12" W. Oak S 66°E 49 lks; 12" W. Oak N 58°E 88 lks
LCRC, L6002, P518, Albright, 1972, Fd 5/8" rered
*N 60°E 74.2' 24" Maple
*S 60°W 58.6' 24" Cherry
*N 60°W 76.8' Centerline hwy. marker
*West 97.76' 5/8" rered @ N 1/4 corner Sec. 6, T4N, R8E

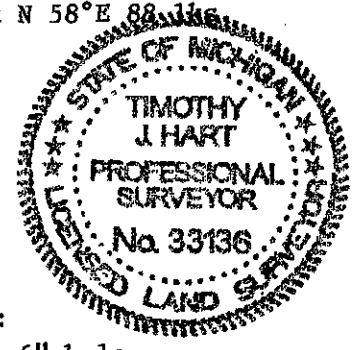

B. Description of corner evidence found and/or method applied in restoring or reestablishing corner:

Recovered 5/8" rered with Oakland County remonumentation cap #22445, 6" below grade in the centerline of Tucker Road. A tree/fence line runs north from the corner. Another iron and remonumentation cap were recovered West 97.53 feet from the N 1/4 corner of Section 6 (B-1, Springfield).

Witnesses Recovered
N 02°E 90.50' Nail/remon tag 22445 W. MBT pole *N 70°W 77.03' Centerline hwy. marker
N 60°E 75.00' Nail/remon tag 22445 S. 30" Maple *West 97.53' 5/8" rered w/OC brass remon cap 22445
*N 60°E 74.01' PK nail S. 30" Maple
*S 64°W 58.13' Nail/remon tag 22445 N. 24" Cherry
S 70°W 81.73' Nail/remon tag 22445 S. 8" Cherry *Confirms LCRC

C. Description of monument for corner and accessories established to perpetuate locating the position of the corner:

Accepted 5/8" rered with O.C. remonumentation cap #22445.
N 02°E 90.50' Nail/remon tag 22445 W. MBT pole
N 60°E 75.00' Nail/remon tag 22445 S. 30" Maple
S 64°W 58.13' Nail/remon tag 22445 N. 24" Cherry
S 70°W 81.73' Nail/remon tag 22445 S. 8" Cherry

State Plane Coordinates
N 469918.4954
E 13340263.1909

The selected location is accepted by the Contractor and is generally accepted by professional surveyors as the best available evidence of the position of the original corner. This corner was also accepted by the Oakland County Peer Group as established under Act 345 of P.A. 1990.

Signed by Timothy J. Hart Date 12-22-98
Surveyor's Michigan License No. 33136