

MAR 21 2000

COPY

LIBER 19758/424

SECTION

LAND CORNER RECORDATION CERTIFICATE

106238

Filing Requirement of Act 74, Mich. P.A. 1970

LIBER 19758 PAGE 424
\$7.00 MISC RECORDING
\$2.00 REMONUMENTATION
03/30/1999 01:03:21 P.M. RECEIPT# 12968
PAID RECORDED - OAKLAND COUNTY
G. WILLIAM CADDELL, CLERK/REGISTER OF DEED

For corners in
Oakland
(County)

Located In: Corner Code #

1. Public Land Survey	T	5N	R	8E	C-1
	T		R		
	T		R		
	T		R		
2. Property Controlling in Section	S	T	R		
	S	T	R		
3. Miscellaneous Property in Section	S	T	R		
	S	T	R		

Compliance with
ACT 345, P.A. 1990

APPROVED ON: 3-10-99 JS
OAKLAND COUNTY REMONUMENTATION
PEER GROUP COMMITTEE

Register of Deeds Stamp & File Number

4. Lot No. _____, Recorded Plat _____
5. Private Claims _____

I, Timothy J. Hart, in a field survey on 2-15, 19 99, do hereby certify that under requirements of P.A. 74, Michigan P.A. of 1970, the corner points mentioned in lines 1 and 2 above were in conformance with regulations and rules therefore as required in the current manual of survey instructions of the United States Department of the Interior, Bureau of Land Management or by a decree of a Court of Law and/or that the corner points mentioned in lines 3, 4 and 5 above were in conformance with the rules of the Michigan Board of Professional Surveyors or by a Decree of a Court of Law; established, re-established, monumented, re-monumented, recovered, found as expressed below:

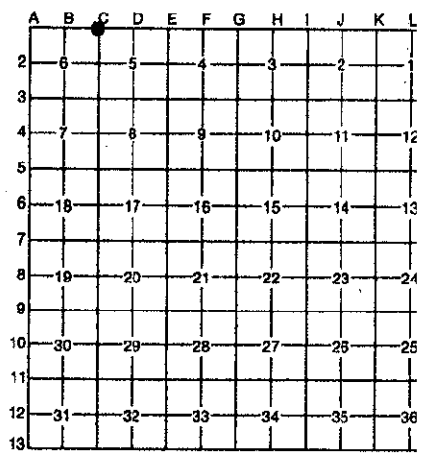

NOTE: Not more than 4 corners, all in the same town and range, may be recorded on this certificate.

A. Description of original monument and accessories and/or subsequent restoration:

Post set in 1823 G.L.O. survey 3 chains (198 ft east of C-13 Atlas Twp);
12" B. Oak S 30°W 1.55 Ch; 8" W. Oak N 49°W 93 lks
LCRC, L6716, P750, Albright, 1974, fd 1/2" rerod
*N 45°E 2.20' 10" Walnut
South 8.05' Fence post
*West 16:20' 8" Walnut

B. Description of corner evidence found and/or method applied in restoring or reestablishing corner:

Recovered a 1/2" rerod 0.50 ft north of an east-west fence. A tree/fence line runs south from the corner. Also recovered a 1/2" rerod 210.89 ft west, monumenting corner C-13 in Atlas Township.

Witnesses Recovered

*North 2.09' Nail/tag W. 16" Walnut
West 210.89' 1/2" rerod (C-13, Atlas Twp)
West 27.50' Nail/tag S. 16" Walnut
*N 85°W 16.20' Nail/tag NE 16" Walnut

*Confirms LCRC

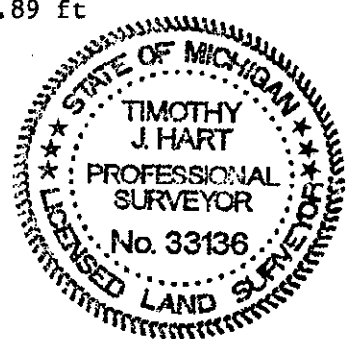

C. Description of monument for corner and accessories established to perpetuate locating the position of the corner:

Set concrete monument with O.C. remonumentation brass cap 0.21 ft south of recovered 1/2" rerod on Township line.
North 2.33' PK/remon tag W. 16" Walnut
East 19.95' PK/remon tag N. 14" Walnut
South 18.13' PK/remon tag W. 6" Walnut
West 27.37' PK/remon tag S. 16" Walnut

State Plane Coordinates
N 501834.6593
E 13341913.0809

The selected location is accepted by the Contractor and is generally accepted by professional surveyors as the best available evidence of the position of the original corner. This corner was also accepted by the Oakland County Peer Group as established under Act 345 of P.A. 1990.

Signed by Timothy J. Hart
Surveyor's Michigan License No. 33136

Date 3-5-99