

COPY

LIBER 197581482

LAND CORNER RECORDATION CERTIFICATE
Filing Requirement of Act 74, Mich. P.A. 1970

106296

For corners in

Oakland Located In: Corner Code #
(County)

1. Public Land Survey T5N R8E H-11
T R
T R
T R

2. Property Controlling S T R SURVEY & RE-ESTABLISHMENT
in Section S T R
3. Miscellaneous S T R
Property in Sec. S T R MAR 21 2000

LIBER 19758 PAGE 482
\$7.00 MISC RECORDING
\$2.00 REMONUMENTATION
03/30/1999 01:03:22 P.M. RECEIPT# 12968
PAID RECORDED - OAKLAND COUNTY
G. WILLIAM CADDELL, CLERK/REGISTER OF DEEDS

Compliance with
ACT 345, P.A. 1990

APPROVED ON: 1-27-99 JS
OAKLAND COUNTY REMONUMENTATION
PEER GROUP COMMITTEE
Register of Deeds Stamp & File Number

4. Lot No. _____, Recorded Plat _____ SECTION
5. Private Claims _____

I, Timothy J. Hart, in a field survey on 5-23, 1998 do hereby state that under requirements of P.A. 74, Michigan P.A. of 1970, the corner points mentioned in lines 1 and 2 above were in conformance with regulations and rules therefore as required in the current manual of survey instructions of the United States Department of the Interior, Bureau of Land Management or by a decree of a Court of Law and /or that the corner points mentioned in lines 3, 4 and 5 above were in conformance with the rules of the Michigan Board of Land Surveyors or by a Decree of a Court of Law, established, re-established, monumented, recovered, found as expressed below:

NOTE: Not more than 2 corners, all in the same town and range, may be recorded on this certificate.

A	B	C	D	E	F	G	H	I	J	K	L
1											
2	6		5		4		3		2		1
3											
4	7		8		9		10		11		12
5											
6	18		17		16		15		14		13
7											
8	19		20		21		22		23		24
9											
10	30		29		28		27		26		25
11											
12	31		32		33		34		35		36
13											

A. Description of original monument and accessories and/or subsequent restoration:

Post set in 1823 G.L.O. survey; 8" W. Oak S 27°E 25 lks, 12" W. Oak N 16°W 44 lks.

- A) LCRC, L6002, P512, Albright, 1972, fd 1/2" rerod (1)
- B) Survey, L6359, P401, Carlson, 1973, no reference (1)
- C) Survey, L7593, P328, Smith, 1977, fd 1/2" rerod (2)
- D) Survey, No recording data, Ward, 1995, fd 1/2" pipe (5)

(n) indicates number of witnesses confirmed

B. Description of corner evidence found and/or method applied in restoring or reestablishing corner:

Recovered 1/2" rerod in the centerline of Bald Eagle Lake Road. Tree/fence rows run north and south from the corner.

Witnesses Recovered

- N 05°W 20.05' Nail/tag 22445 E. 20" Maple (D)
- N 05°E 23.84' Nail/tag 17623 W. 26" Cherry
- S 50°E 25.65' Nail/tag 22445 N. 14" Oak (D)
- S 20°E 25.30' Nail/tag 22445 NE 28" Cherry (D)
- S 10°W 24.05' Nail/tag 22445 W. 14" Oak (A,C,D)
- West 2617.48' to Corner G-11 (D)
- East 2669.78' to Corner I-11 (B,C)

(1) indicates LCRC or survey confirmed.

C. Description of monument for corner and accessories established to perpetuate locating the position of the corner:

Set 5/8" rerod with O.C. remonumentation brass cap, replacing 1/2" rerod

- N 40°W 27.62' PK/remon tag E. 12" Maple
- N 05°W 20.00' PK/remon tag E. 20" Maple
- S 50°E 25.55' PK/remon tag N. 14" Oak
- S 20°E 25.25' PK/remon tag E. 28" Cherry
- S 10°W 24.00' PK/remon tag W. 14" Oak

State Plane Coordinates
N 475923.4686
E 13355911.2654

The selected location is accepted by the Contractor and is generally accepted by professional surveyors as the best available evidence of the position of the original corner. This corner was also accepted by the Oakland County Peer Group as established under Act 345 of P.A. 1990.

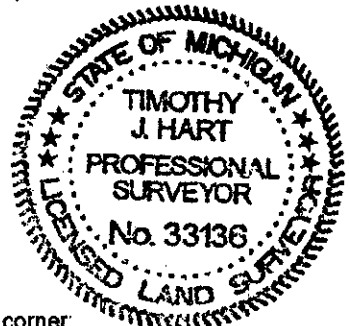

Signed by Timothy J. Hart
Surveyor's Michigan License No. 33136

Date 1-23-99