

**SURVEY &
REMONUMENTATION**

LIBER **14833** PG **120**

94 **193364**

MAY - 1 1995

LAND CORNER RECORDATION CERTIFICATE
Filing Requirement of Act 74, Mich. P.A. 1970

For corners in
Oakland

COMMISSION

OK - T. SMITH

	Located In:		Corner Code #
	5N	11E	
1. Public Land Survey	T _____	R _____	K-2
	T _____	R _____	
	T _____	R _____	
	T _____	R _____	
2. Property Controlling in Section	S _____	T _____	R _____
	S _____	T _____	R _____
3. Miscellaneous Property in Sec.	S _____	T _____	R _____
	S _____	T _____	R _____

\$ 7.00 MISCELLANEOUS RECORDING
\$ 2.00 REMONUMENTATION
15 JUL 94 7:28 A.M. RECEIPT# 1A
PAID RECORDED - OAKLAND COUNTY
LYNN D. ALLEN, CLERK OF DEEDS
ACT 74, P.A. 1970

APPROVED ON: 2-2-94
OAKLAND COUNTY REMONUMENTATION
PEER GROUP COMMITTEE
Register of Deeds Stamp & File Number

4. Lot No. _____, Recorded Plat _____
5. Private Claims _____

	A	B	C	D	E	F	G	H	I	J	K	L
2	6	5	4	3	2	1						
3												
4	7	8	9	10	11	12						
5												
6	18	17	16	15	14	13						
7												
8	19	20	21	22	23	24						
9												
10	30	29	28	27	26	25						
11												
12	31	32	33	34	35	36						
13												

Bruce Antcliff November 9 93

I, _____, in a field survey on _____, 19 _____, do hereby certify that under requirements of P.A. 74, Michigan P.A. of 1970, the corner points mentioned in lines 1 and 2 above were in conformance with regulations and rules therefore as required in the current manual of survey instructions of the United States Department of the Interior, Bureau of Land Management or by a decree of a Court of Law and/or that the corner points mentioned in lines 3, 4 and 5 above were in conformance with the rules of the Michigan Board of Land Surveyors or by a Decree of a Court of Law; established, re-established, monumented, re-monumented, recovered, found as expressed below:

NOTE: Not more than 4 corners, all in the same town and range, may be recorded on this certificate.

A. Description of original monument and accessories and/or subsequent restoration:

K-2 GLO Post	L.C.R.C. L. 6663, P. 651 (1976) 3/4" Iron Pipe West 6.06' PK Nail 6" Elm North 22.48' PK Nail 5" Elm East 72.00' PK Nail 6" Elm	Survey L. 9783, P. 359 (2/27/87) Fnd 3/4" Pipe West 6.04' 12" Elm North 15° W 24.13' 10" Elm North 60° W 22.53' 6" Elm North 22.54' 10" Elm
--------------	---	--

B. Description of corner evidence found and/or method applied in restoring or reestablishing corner:

K-2 Found 3/4" pipe at fence line East and West. Checks the following witnesses:	PK Nail in 6" Elm West 6.06' Pk Nail in 5" Elm North 22.48'	Survey L. 9783, P. 359 (2/27/87) Fnd 3/4" Pipe West 6.04' 12" Elm North 15° W 24.13' 10" Elm North 60° W 22.53' 6" Elm North 22.54' 10" Elm
---	--	--

C. Description of monument for corner and accessories established to perpetuate locating the position of the corner:

K-2 The selected location is accepted by the Contractor and is generally accepted by professional surveyors as the best available evidence of the position of the original corner.

Set concrete monument with standard Oakland County cap.

P.K. Nail and Brass Tag in E Face 12" Elm - North - 22.42'
P.K. Nail and Brass Tag in W Face 12" Elm - N 15° W - 24.14'
P.K. Nail and Brass Tag in SW Face 10" Elm - N 60° W - 22.40'
P.K. Nail and Brass Tag in N Face 12" Elm - West - 5.84'

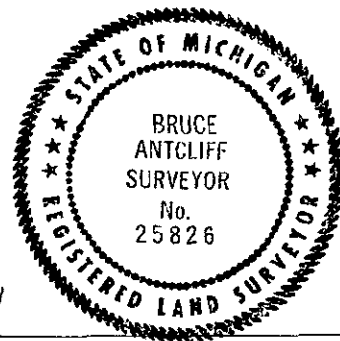

Signed by Bruce Antcliff
Surveyor's Michigan License No. 25826

Date 7-11-94