

Oceana County Remonumentation
 Survey Group Reviewed & Approved
 Date: 9-14-93

OCEANA COUNTY REMONUMENTATION

100540

STATE OF MICHIGAN
 COUNTY OF OCEANA
 RECEIVED FOR RECORD

JRH
 Randolph Hepworth
 Oceana County Surveyor
 for corners in

LAND CORNER RECORDATION CERTIFICATE
 Filing Requirement of Act 74, Mich. P.A. 1970

<u>OCEANA</u> (County)	Located In:	Corner Code #:
Public Land Survey	T <u>13N</u> R <u>18W</u>	<u>J-1</u>
	T _____ R _____	
	T _____ R _____	
	T _____ R _____	
Property Controlling in Section	S _____ T _____ R _____	
Miscellaneous Property in Sec.	S _____ T _____ R _____	

'93 DEC 14 AIO:27

Joseph E. Martins
 REGISTER OF DEEDS

Register of Deeds Stamp & File Number

SURVEY & REMONUMENTATION

FEB 25 1994

Lot No. _____, Recorded Plat _____
 Private Claims _____

COMMISSION

J. Randolph Hepworth September 30, 1993
 in a field survey on _____, 19____
 hereby certify that under requirements of P.A. 74, Michigan P.A. of 1970, the corner points mentioned lines 1 and 2 above were in conformance with regulations and rules therefore as required in the present manual of survey instructions of the United States Department of the Interior, Bureau of Land Management or by a decree of a Court of Law and/or that the corner points mentioned in lines 3, 4 and 5 above were in conformance with the rules of the Michigan Board of Land Surveyors or by a Decree of a Court of Law; established, re-established, monumented, re-monumented, recovered, found as pressed below:

A	B	C	D	E	F	G	H	I	J	K	L	M
2	6	5	4	3	2	1						
3												
4	7	8	9	10	11	12						
5												
6	18	17	16	15	14	13						
7												
8	19	20	21	22	23	24						
9												
10	30	29	28	27	26	25						
11												
12	31	32	33	34	35	36						
13												

NOTE: Not more than 4 corners, all in the same town and range, may be recorded on this certificate.

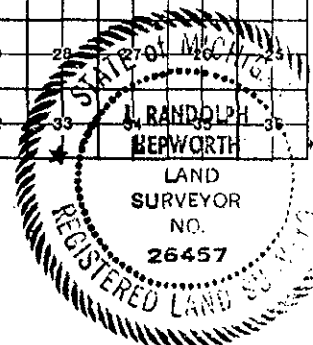

Description of original monument and accessories and/or subsequent restoration:

- A. J-1 N 1/4 CORNER SEC 2 T13N, R18W CLAYBANKS TOWNSHIP GLO did not set this corner.
- GLO SET a POST 6" BEECH N45°W 26.4' 5" BEECH N40°E 21.8' which is J-13 S 1/4 CORNER SECTION 35 BENONA TWP; T14N, R18W BOOK A-3 EDSON, 1880 SET REDDISH STONE 3X10X13 POINT UP WITH CHISELED 'X' AT GLO CORNER. The record states that he set this stone where Government post was. Edson mistakenly calls the Gov't corner the N 1/4 corner of Section 2 instead of the S 1/4 corner of Section 35 failing to account for double corners.
- BOOK A-224 HYDE, 1889 RED STONE PREVIOUSLY SET (IMPLIED TO BE COMMON WITH T13N & T14N)
- BOOK A-276 GRANT, 1891 STONE PREVIOUSLY SET AT GLO CORNER
- OCRC WITNESS: pre-1950 1" IRON T POLE N45°W 39.8 SE COR CULVERT HEADWALL 14.3 8" W BIRCH N30°E 49.0
- LCRC #100127 J NORDLUND, PS 16345; 1-18-73 SET PK NAIL FROM OCRC WITNESS J-1 N 1/4 COR, SEC 2, T13N, R18W GUY POLE NW 47.4 18" ASH NE 61.0 P POLE SW 54.5
- JKT 65 & 104: NORDLUND, 1973 Corner not described or witnessed.
- LCRC #100269 R HEPWORTH, PS 26457; 5-16-80 SET 1/2" IRON FROM NORDLUND SURVEY J-1 N 1/4 COR, SEC 2, T13N, R18W RD NAME SIGN N 16.5 PP SW 57.83 NW COR SCHOOL HSE SE 170.15 16" ASH SW 103.77

B. Description of corner evidence found and/or method applied in restoring or reestablishing corner

LCRC 100127, Nordlund, 1973, re-established this corner from OCRC witnesses which date about 1950. Road construction obliterated this corner prior to 1980. LCRC 100269, Hepworth, 1980, re-established Nordlund's corner from Nordlund measurement ties to I-1 and corners from Survey Jacket 65 & 104.

Grant, 1891, subdivided Sec. 35, T14N, R18W. Hyde, 1889, subdivided Sec. 2, T13N, R18W. Both used the same monuments as common along the common line, apparently disregarding double corners per GLO rules.

In retracing the Hyde, Grant & Edson surveys, I found the 1/2" iron per LCRC 100269 and determined that it is 2.7' from a single proportion between I-1 and K-1 corners. However, this iron is not at the Hyde, Grant & Edson position. The mile proportioned to the Grant & Hyde surveys measures excellent and fits 1/16 line occupation. The corner that Hyde, Grant & Edson monumented would be the T14N corner.

Therefore, I believe the Nordlund, 1973 and Hepworth, 1980 corner best fits the location of the North 1/4 corner for Section 2. Further search of the area failed to yield any evidence for a conflicting position for the corner; No documentation is available to lead me to believe that the corner would be at another location. This represents the best available evidence for the position of the corner AND IS ACCEPTED AS A CAREFUL AND FAITHFUL PERPETUATION OF THE POSITION OF THE ORIGINAL CORNER.

C. Description of monument for corner and accessories established to perpetuate locating the position of the corner.

J-1 N 1/4 CORNER SEC 2 T13N, R18W CLAYBANKS TOWNSHIP

SET "COUNTY SURVEYOR" HARRISON 4"X20" CAST IRON MONUMENT IN PLACE OF FOUND 1/2" IRON PER LCRC 100269.				
C/L E-W PAVEMENT; C/L GRAVEL ROAD TO SOUTH				
60d SPK E FACE	POWER POLE	S40°W	58.55	TAPE
60d SPK E FACE	16" ASH	S15°W	103.95	TAPE
W SIDE OF POST	STOP SIGN	S15°E	46.88	TAPE
16d SPK E FACE	GUY POLE	N60°W	48.59	TAPE
T14N CORNER	HARRISON MONUMENT	WEST	13.60	TAPE

DATE: Dec. 13, 1993

Surveyor's Michigan License No. J. Randolph Hepworth
 26457