

SURVEY & REMONUMENTATION

FEB 02 1998

100821 [REDACTED]

SECTION

LAND CORNER RECORDATION CERTIFICATE
Filing Requirement of Act 74, Mich. P.A. 1970

For corners in

<u>Oceana</u> (County)	Located in:	Corner Code #
1. Public Land Survey	T14n R 17W	M-10
	T14N R 16W	<u>A-10</u>
2. Property Controlling in Section	T ___ R ___	___
3. Miscellaneous Property in Sec.	S ___ T ___ R ___	___
	S ___ T ___ R ___	___
	S ___ T ___ R ___	___
	S ___ T ___ R ___	___

STATE OF MICHIGAN
COUNTY OF OCEANA
RECEIVED FOR RECORD
14 Jan 1998 9:36:30 AM
JOSEPH E. MERTEN
REGISTER OF DEEDS
Register of Deeds Stamp & File Number

4. Lot No. _____, Recorded Plat _____
5. Private Claims _____

J. Randolph Hepworth in a field survey on June 20, 1997, do hereby state that under requirements of P.A. 74, Michigan P.A. of 1970, the corner points mentioned in lines 1 and 2 above were in conformance with regulations and rules therefore as required in the current manual of survey instructions of the United States Department of the Interior, Bureau of Land Management or by a decree of a Court of Law and/or that the corner points mentioned in lines 3, 4 and 5 above were in conformance with the rules of the Michigan Board of Land Surveyors or by a Decree of a Court of Law; established, re-established, monumented, recovered, found as expressed below:

NOTE: Not more than 2 corners, all in the same town and range, may be recorded on this certificate.

A	B	C	D	E	F	G	H	I	J	K	L	M
1												
2	6		5		4		3		2		1	
3												
4	7		8		9		10		11		12	
5												
6	18		17		16		15		14		13	
7												
8	19		20		21		22		23		24	
9												
10	30		29		28		27		26		25	
11												
12	31		32		33		34		35		36	
13												

A. Description of original monument and accessories and/or subsequent restoration:

M-10 1/4 CORNER COMMON TO SECTION 25 T14N, R17W SHELBY TOWNSHIP
A-10 1/4 CORNER COMMON TO SECTION 30 T14N, R16W FERRY TOWNSHIP

GLO Set post 12" Beech S65°W 15.2' 6" Beech N50°W 31.7'
Book C, Pg 86; H. Salisbury, 1914; "Iron bar 1 1/2" by 1/2" by 2"
8" Oak S45°E 38.9' 10" Pine N85°E 9.6"
Book C, Pg 168; E. Hyde, date unknown; "Found iron and post fr wh 7" Pine N82°E 9.2"
OCRC WITNESS BOOK 1-8-62 Iron Bar 11" Maple N20°E 40.07'
11" Maple N53°E 29.40' 13" Maple S33°E 8.17'

Oceana County Remonumentation
Peer Group Reviewed & Approved
Date: 10-16-97
JRH
J. Randolph Hepworth
Oceana County Surveyor

B. Description of corner evidence found and/or method applied in restoring or reestablishing corner.

I found a 1/2" Iron and cap (HEI 14091) at the shore of a marshy lake to the East. Iron was found about 1' NW of a grader blade standing 3' high. Upon excavating a 2' dia circle around the HEI Iron and searching the immediate vicinity with the metal locator. I did not find the Salisbury, 1914. Iron With further search, I found 3 trees or stumps that fit the 1962 OCRC witnesses 1. 11" Maple Snag stump with blaze and 16d spk/MDSH tag at N20°E 40.1' 2. 12"-16" well-rotted stump at N50°E 29.5' 3. 14" m/l very well-rotted stump at S30°E 8.2'. 4. 24" m/l very well-rotted stump at S45°E 39'. I presume to be Salisbury, 1914 witness. I could not find the Hyde/Salisbury pine stump at 9.6' East. Corner falls on old plow row/occup hump to the West. No occupation is visible to the North or South

This represents the best available evidence for the position of the corner. This corner is accepted as a careful and faithful perpetuation of the position of the original corner. No evidence is known to me that would lead me to believe that the corner should be at another location. I placed a 4"x20" Harrison Cast Iron Monument stamped "County Surveyor" and "26457".

C. Description of monument for corner and accessories established to perpetuate locating the position of the corner.

M-10 1/4 CORNER COMMON TO SECTION 25 T14N, R17W SHELBY TOWNSHIP
A-10 1/4 CORNER COMMON TO SECTION 30 T14N, R16W FERRY TOWNSHIP

Set "County Surveyor" Harrison 4"x20" Cast Iron Monument

60d spk	N Face	11" R Oak	260°az	15.20
60d spk	E Face	18" Beech	180°az	17.36
60d spk	NE Face	4" Maple	122°az	7.48
60d spk	SW Face	24" Cherry	352°az	19.80

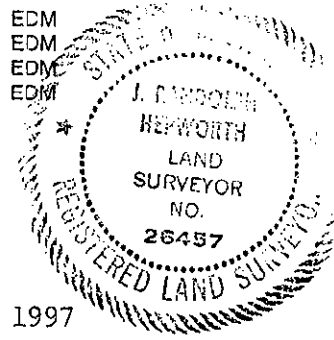

Signed by J. Randolph Hepworth
Surveyor's Michigan License No. 26457

Date November 29, 1997