

SURVEY & REMONUMENTATION

FEB 02 1998

100805

SECTION

LAND CORNER RECORDATION CERTIFICATE
Filing Requirement of Act 74, Mich. P.A. 1970

For corners in

<u>Oceana</u> (County)	Located In:	Corner Code #
1. Public Land Survey	T14N R17W	H-5
	T_____ R_____	_____
	T_____ R_____	_____
	T_____ R_____	_____
2. Property Controlling in Section	S_____ T_____ R_____	_____
	S_____ T_____ R_____	_____
3. Miscellaneous Property in Sec.	S_____ T_____ R_____	_____
	S_____ T_____ R_____	_____

STATE OF MICHIGAN
COUNTY OF OCEANA
RECEIVED FOR RECORD

14 Jan 1998 9:32:45 AM

JOSEPH E. MERTEN
REGISTER OF DEEDS

Register of Deeds Stamp & File Number

4. Lot No. _____, Recorded Plat _____
5. Private Claims _____

J. Randolph Hepworth June 27 97
I, _____, in a field survey on _____, 19____ do hereby state that under requirements of P.A. 74, Michigan P.A. of 1970, the corner points mentioned in lines 1 and 2 above were in conformance with regulations and rules therefore as required in the current manual of survey instructions of the United States Department of the Interior, Bureau of Land Management or by a decree of a Court of Law and/or that the corner points mentioned in lines 3, 4 and 5 above were in conformance with the rules of the Michigan Board of Land Surveyors or by a Decree of a Court of Law; established, re-established, monumented, recovered, found as expressed below:

NOTE: Not more than 2 corners, all in the same town and range, may be recorded on this certificate.

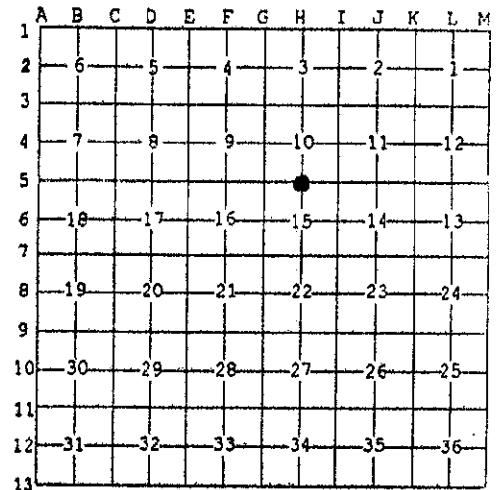

A. Description of original monument and accessories and/or subsequent restoration:

H-5 1/4 CORNER COMMON TO SECTIONS 10 & 15 T14N, R17W SHELBY TOWNSHIP

GLO Set post 10"Elm S35°E 4.6' 10"Sugar N61°W 12.5'
Book A, Pg 28; H. Hawley, 1876: "...quarter post...surrounded by pieces of stone and earthenware pieces in excavated hill..."
Book A, Pg 348; H. Salisbury, 1879: Corner not referenced.

Recorded Survey, JKT # 152, Rupert Jackson # 11362, 7/15/75, PK Nail
2" Tree 35.9' N S Edge Pvmnt 9.72' S 2" Mult tree 36.8' SE

Unrecorded Survey, K. Ross #17634, 10-17-77, Ex. 1/2" IR fence to N Rd C/L

Recorded Survey, JKT # 511, R. Hepworth # 26457, 11-30-92, Fd 1/2" IR
24" Elm 180°AZ 34.2' EDM 8"Elm 143°AZ 36.99' EDM
16" Poplar 358°AZ 41.25' EDM 12" Poplar 42°AZ 39.35' EDM

Oceana County Remonumentation
Peer Group Reviewed & Approved

Date: 10-16-97

JRH
J. Randolph Hepworth
Oceana County Surveyor

B. Description of corner evidence found and/or method applied in restoring or reestablishing corner.

I found a 1/2" Iron at the surface and in the centerline of E-W asphalt road and on occupation lines to the North and to the South. Corner falls in a hillside cut of about 8'-10'. Upon excavation and removal, I found it to be beside a 1 1/2"x2 1/2" cast Iron Bar at 8" deep. Upon removal of the bar and further excavation, I found many pieces of broken crockery beside the bar. It is my opinion that this material is the Hawley, 1876 corner.

This represents the best available evidence for the position of the corner. The found 1/2" iron beside the bar is accepted as a careful and faithful perpetuation of the position of the original corner. No evidence is known to me that would lead me to believe that the corner should be at another location. I placed a 4"x20" Harrison Cast Iron Monument stamped "County Surveyor" and "26457" at the position found and above the cast iron bar and beside the 1/2" Iron.

C. Description of monument for corner and accessories established to perpetuate locating the position of the corner.

H-5 1/4 CORNER COMMON TO SECTIONS 10 & 15 T14N, R17W SHELBY TOWNSHIP

"County Surveyor" Harrison 4"x20" Cast Iron Monument

centerline of E-W Pavement

60d spk	E Face	24" Poplar	358°az	40.93	EDM
60d spk	SE Face	20" Poplar	42°az	39.46	EDM
60d spk	SW Face	14" Elm	144°az	37.02	EDM
	west edge of Buried Cable Sign Post		199°az	35.63	EDM

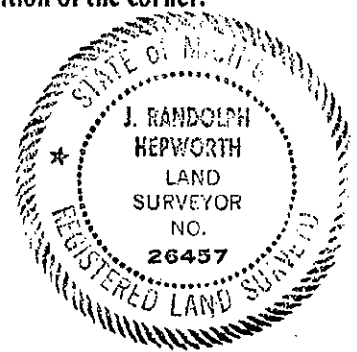

Signed by J. Randolph Hepworth
Surveyor's Michigan License No. 26457

Date November 29, 1997