

SURVEY & REMONUMENTATION

APR 25 1995

COMMISSION

LAND CORNER RECORDATION CERTIFICATE
Filing Requirement of Act 74, Mich. P.A. 1970

STATE OF MICHIGAN
COUNTY OF OCEANA
RECEIVED FOR RECORD
100599
'95 JAN -4 P 3:25

For corners in

Oceana
(County)

Located In:

Corner Code #

- | | | |
|------------------------------------|-----------------------------|------------|
| 1. Public Land Survey | T <u>14</u> N R <u>17</u> W | <u>H-7</u> |
| | T _____ R _____ | _____ |
| | T _____ R _____ | _____ |
| | T _____ R _____ | _____ |
| 2. Property Controlling In Section | S _____ T _____ R _____ | _____ |
| | S _____ T _____ R _____ | _____ |
| 3. Miscellaneous Property in Sec. | S _____ T _____ R _____ | _____ |
| | S _____ T _____ R _____ | _____ |

J. Randolph Hepworth
REGISTER OF DEEDS

Register of Deeds Stamp & File Number

4. Lot No. _____, Recorded Plat _____
5. Private Claims _____

	A	B	C	D	E	F	G	H	I	J	K	L	M
2	6	5	4	3	2	1							
3													
4	7	8	9	10	11	12							
5													
6	18	17	16	15	14	13							
7													
8	19	20	21	22	23	24							
9													
10	30	29	28	27	26	25							
11													
12	31	32	33	34	35	36							
13													

I, J. Randolph Hepworth, in a field survey on September 30, 1994, do hereby certify that under requirements of P.A. 74, Michigan P.A. of 1970, the corner points mentioned in lines 1 and 2 above were in conformance with regulations and rules therefore as required in the current manual of survey instructions of the United States Department of the Interior, Bureau of Land Management or by a decree of a Court of Law and/or that the corner points mentioned in lines 3, 4 and 5 above were in conformance with the rules of the Michigan Board of Land Surveyors or by a Decree of a Court of Law; established, re-established, monumented, re-monumented, recovered, found as expressed below:

NOTE: Not more than 4 corners, all in the same town and range, may be recorded on this certificate.

A. Description of original monument and accessories and/or subsequent restoration:
H-7 1/4 CORNER COMMON TO SECTIONS 15 AND 22 T14N, R17W SHELBY TOWNSHIP

- GLO SET POST 10" Birch N21°W 11.2' 10" Birch S15°E 7.3'
- Book A, Pg 28; H. Hawley, 1876; Stake in side of Hill Highway
- Book A, Pg 348; H. Salisbury, 1923; Crockery and stake 12" Elm N1°E 42.4 8" Elm S45°W 43.0
- OCRC WITNESS: Undated, Gass pipe
SE Corner of School House 56.6 12" Twin Elm S45°W 43.0 10" Hickory N45°W 43.75
- Hepworth, PS26457, unrecorded survey, Oct 1992; Found Engine Valve
SE Cor of Brick House (main line) NNW 57.06
10" Poplar NNE 63.23
6" Elm S 31.09
cp 6" Elm SSW 39.24

B. Description of corner evidence found and/or method applied in restoring or reestablishing corner
Schoolhouse of OCRC witness is still standing and measures to 0.4' of OCRC measurement. No other OCRC witnesses or Salisbury, 1923 witnesses are standing. I found an engine valve in the surface of the center of an east-west asphalt road, on a tree line to the south and on faint occupation line to the north (treeline begins 300' N).

Upon removal of the E Valve, I excavated to 18" and found it to be above a 3/4" Pipe with 1/4" hole in top surrounded by broken, white pottery. OCRC calls for a Gass (sic) pipe and Salisbury calls for the crockery.

Further search of the area failed to yield any other evidence for a conflicting position for the corner. This represents the best available evidence for the position of the corner. The Found engine valve above the 3/4" pipe IS ACCEPTED AS A CAREFUL AND FAITHFUL PERPETUATION OF THE POSITION OF THE ORIGINAL CORNER.

C. Description of monument for corner and accessories established to perpetuate locating the position of the corner.

- Set "County Surveyor" HARRISON 4"x20" cast iron monument in the surface of the asphalt above the 3/4" pipe
- 60d spk W Face 18" Maple 182°az 72.04 EDM
- 60d spk NW Face 4" Spruce 215°az 53.76 EDM
- 60d spk NW Face 8" Spruce 233°az 76.64 EDM
- 60d spk S Face 30" Maple 286°az 108.51 EDM
- SE cor Brick (School) house 331°az 57.04 EDM
- NE cor Brick (School) house 345°az 81.73 EDM
- PK Nail SE Face Power Pole 65°az 108.83 EDM

Oceana County Remonumentation
Peer Group Reviewed & Approved
Date: 12-1-94
JRH
J. Randolph Hepworth
Oceana County Surveyor

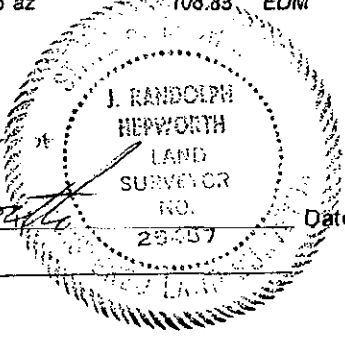

Signed by J. Randolph Hepworth Date December 28, 1994
Surveyor's Michigan License No. 26457