

SURVEY & REMONUMENTATION

FEB 02 1998

SECTION

100807

LAND CORNER RECORDATION CERTIFICATE
Filing Requirement of Act 74, Mich. P.A. 1970

For corners in
Oceana

(County)

Located In:

Corner Code #

1. Public Land Survey	T <u>14</u> N	R <u>17</u> W	I-6
	T	R	
	T	R	
	T	R	
2. Property Controlling In Section	S	T	R
	S	T	R
3. Miscellaneous Property in Sec.	S	T	R
	S	T	R

STATE OF MICHIGAN
COUNTY OF OCEANA
RECEIVED FOR RECORD

14 Jan 1998 9:33:14 AM

JOSEPH E. MERTEN
REGISTER OF DEEDS

Register of Deeds Stamp & File Number

4. Lot No. _____, Recorded Plat _____
5. Private Claims _____

J. Randolph Hepworth June 27 97
I, _____, in a field survey on _____, 19____ do hereby state that under requirements of P.A. 74, Michigan P.A. of 1970, the corner points mentioned in lines 1 and 2 above were in conformance with regulations and rules therefore as required in the current manual of survey instructions of the United States Department of the Interior, Bureau of Land Management or by a decree of a Court of Law and /or that the corner points mentioned in lines 3, 4 and 5 above were in conformance with the rules of the Michigan Board of Land Surveyors or by a Decree of a Court of Law; established, re-established, monumented, recovered, found as expressed below:

NOTE: Not more than 2 corners, all in the same town and range, may be recorded on this certificate.

A	B	C	D	E	F	G	H	I	J	K	L	M
1												
2	6	5	4	3	2	1						
3												
4	7	8	9	10	11	12						
5												
6	18	17	16	15	14	13						
7												
8	19	20	21	22	23	24						
9												
10	30	29	28	27	26	25						
11												
12	31	32	33	34	35	36						
13												

A. Description of original monument and accessories and/or subsequent restoration:

I-6 1/4 CORNER COMMON TO SECTIONS 14 & 15 T14N, R17W SHELBY TOWNSHIP

GLO Set Post 24"Beech S35°E 14.5' 18"Beech S68°W 31.7'
Book A, Pg 28; H. Hawley, 1876; Corner not described or witnessed.
Book A, Pg 348; H. Salisbury, 1879; Corner not described or witnessed
OCRC WITNESS BOOK 1964 Iron 6" by 6" cement mt. 25.15' west side of Rd.

Oceana County Remonumentation
Peer Group Reviewed & Approved

Date: 10-16-97

by cemetery J. Randolph Hepworth
Oceana County Surveyor

Unrecorded Survey, JR Hepworth #26457, 12/12/90, Fd 1" Pipe raised with Spike

Unrecorded Survey, JR Hepworth #26457, 10/29/92, Fd JRH spike over 1" pipe
36" Maple 327°AZ 89.39' 48" Maple 276°AZ 29.11'
36" Maple 142°AZ 43.62' 36" Maple 164°AZ 97.48'

B. Description of corner evidence found and/or method applied in restoring or reestablishing corner.

I found a 1" Pipe 6" below the surface and in the centerline of a N-S asphalt road and on occupation lines to east and to west. I could not find the 6x6 cement post described by OCRC. Upon excavation, I found the pipe to be 16" long and to be beside a large pointed stone of undetermined size and shape. It is my opinion that the stone is the Salisbury or Hawley corners described above.

This represents the best available evidence for the position of the corner. The found 1" Pipe beside the stone is accepted as a careful and faithful perpetuation of the position of the original corner. No evidence is known to me that would lead me to believe that the corner should be at another location. I placed a 4"x20" Harrison Cast Iron Monument stamped "County Surveyor" and "26457" at the position found above the pipe which was driven down.

C. Description of monument for corner and accessories established to perpetuate locating the position of the corner.

I-6 1/4 CORNER COMMON TO SECTIONS 14 & 15 T14N, R17W SHELBY TOWNSHIP
"County Surveyor" Harrison 4"x20" Cast Iron Monument
centerline of road N-S

60d spk	S Face	48" Maple	276°az	29.11	tape
60d spk	NE Face	36" Maple	327°az	89.39	tape
60d spk	SW Face	36" Maple	142°az	43.62	tape
60d spk	NE Face	36" Maple	164°az	97.48	tape

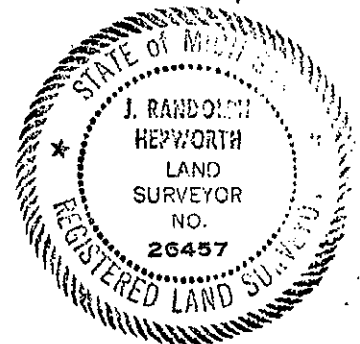

Signed by J. Randolph Hepworth
Surveyor's Michigan License No. 26457

Date November 29, 1997