

SURVEY & REMONUMENTATION

STATE OF MICHIGAN
COUNTY OF OCEANA
RECEIVED FOR RECORD

APR 25 1995

LAND CORNER RECORDATION CERTIFICATE
Filing Requirement of Act 74, Mich. P.A. 1970

100604
95 JAN -4 P3:26

For corners in
Oceana

COMMISSION

Located In:

Corner Code #

- | | | |
|------------------------------------|---------------------------|------------|
| 1. Public Land Survey | T <u>14N</u> R <u>17W</u> | <u>M-7</u> |
| | T _____ R _____ | _____ |
| | T _____ R _____ | _____ |
| | T _____ R _____ | _____ |
| 2. Property Controlling in Section | S _____ T _____ R _____ | _____ |
| | S _____ T _____ R _____ | _____ |
| 3. Miscellaneous Property in Sec. | S _____ T _____ R _____ | _____ |
| | S _____ T _____ R _____ | _____ |

Joseph E. McArthur
REGISTER OF DEEDS

Register of Deeds Stamp & File Number

4. Lot No. _____, Recorded Plat _____
5. Private Claims _____

	A	B	C	D	E	F	G	H	I	J	K	L	M
2	6		5		4		3		2				
3													
4	7		8		9		10		11		12		
5													
6	18		17		16		15		14		13		
7													
8	19		20		21		22		23		24		
9													
10	30		29		28		27		26		25		
11													
12	31		32		33		34		35		36		
13													

I, J. Randolph Hepworth a field survey on December 4, 19 94, do hereby certify that under requirements of P.A. 74, Michigan P.A. of 1970, the corner points mentioned in lines 1 and 2 above were in conformance with regulations and rules therefore as required in the current manual of survey instructions of the United States Department of the Interior, Bureau of Land Management or by a decree of a Court of Law and/or that the corner points mentioned in lines 3, 4 and 5 above were in conformance with the rules of the Michigan Board of Land Surveyors or by a Decree of a Court of Law; established, re-established, monumented, re-monumented, recovered, found as expressed below:

NOTE: Not more than 4 corners, all in the same town and range, may be recorded on this certificate.

A. Description of original monument and accessories and/or subsequent restoration:
M-7 CORNER COMMON TO SECTIONS 13 AND 24 T14N, R17W SHELBY TOWNSHIP
A-7 CORNER COMMON TO SECTIONS 18 AND 19 T14N, R16W FERRY TOWNSHIP

GLO SET POST 12" Beech S42° W 19.8' 10" Beech N48° W 19.1'

Book C, Pg 84; H. Salisbury, 1914; Set post 4" Oak S45° E 2.6' 5" Oak N43° E 21.1'

Book C, Pg 134; H. Salisbury, Undated; "Set iron plow colter at corner, on testimony of A. Dean"
4" Oak S45° E 6.6' 5" Oak N43° E 21.1'

LCRC 100195; J Clapp, 14091, May 6, 1976; Found Iron Fence Post
8" Oak N 19.61
8" Oak S23° W 12.97
8" Oak S64° E 15.56

Act 132; Jacket 173; J Clapp, 14091, 4-29-76; Found "T" Iron fence post witnesses same as above
Act 132; Jacket 296; J Clapp, 14091, 6-15-76; Found Iron witnesses same as above

B. Description of corner evidence found and/or method applied in restoring or reestablishing corner

I found a 1" T Iron beside a 6' tall steel T Fence Post at the western edge of a north-south dirt trail at the top of a 2' cut. Trail has been recently 5+ years bulldozed and whole area has been timbered. Two Clapp witnesses were found- the 8" Oak N at 19.61 is now a stump. No occupation exists in this area.

Further search of the area failed to yield any other evidence for a conflicting position for the corner. This represents the best available evidence for the position of the corner. The Found T Iron IS ACCEPTED AS A CAREFUL AND FAITHFUL PERPETUATION OF THE POSITION OF THE ORIGINAL CORNER.

C. Description of monument for corner and accessories established to perpetuate locating the position of the corner.

Set "County Surveyor" HARRISON 4"x20" Cast Iron Monument above the T Iron which was driven down

60d spk	S Face	6" Tw Beech	265°az	13.85	tape
60d spk	SE Face	8" R Oak	210°az	12.97	tape
60d spk	SE Face	24" R Oak	40°az	42.99	tape
60d spk	N Face	clip 3" Maple	120°az	33.48	tape

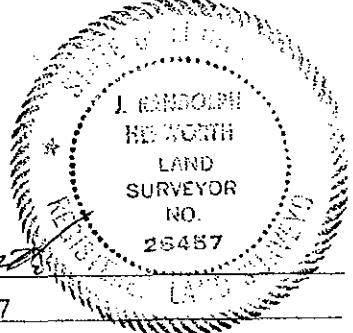

Oceana County Remonumentation
Peer Group Reviewed & Approved
Date: 12-1-94
JRH
J. Randolph Hepworth
Oceana County Surveyor

Signed by J. Randolph Hepworth Date December 28, 1994

Surveyor's Michigan License No. 26457