

3 DEC 1999 2:14:39 PM

LAND CORNER RECORDATION CERTIFICATE
 Filing Requirement of Act 74, Mich. P.A. 1970

JOSEPH E. MERTEN
 REGISTER OF DEEDS

100952

For corners in

Oceana
 (County)

Located in:

Corner Code #

1. Public Land Survey

T 15N R 17W K-9
 T R _____
 T R _____
 T R _____
 T R _____
 S T _____
 S T _____
 S T _____
 S T _____

2. Property Controlling
 in Section

3. Miscellaneous
 Property in Sec.

4. Lot No. _____, Recorded Plat _____
 5. Private Claims _____

Register of Deeds Stamp & File Number

I, J. Randolph Hepworth in a field survey on October 12, 1999 do hereby state that under requirements of P.A. 74, Michigan P.A. of 1970, the corner points mentioned in lines 1 and 2 above were in conformance with regulations and rules therefore as required in the current manual of survey instructions of the United States Department of the Interior, Bureau of Land Management or by a decree of a Court of Law and for that the corner points mentioned in lines 3, 4 and 5 above were in conformance with the rules of the Michigan Board of Land Surveyors or by a Decree of a Court of Law, established, re-established, monumented, recovered, found as expressed below.

	A	B	C	D	E	F	G	H	I	J	K	L	M
1													
2	6		5		4		3		2		1		
3													
4	7		8		9		10		11		12		
5													
6	18		17		16		15		14		13		
7													
8	19		20		21		22		23		24		
9													
10	30		29		28		27		26		25		
11													
12	31		32		33		34		35		36		
13													

NOTE: Not more than 2 corners, all in the same town and range, may be recorded on this certificate.

A. Description of original monument and accessories and/or subsequent restoration:

K-9 CORNER COMMON TO SECTIONS 23, 24, 25, AND 26 T15N, R17W HART TOWNSHIP

GLO J. Mullett 1838 SET POST 20" Beech N41°E (8 lks) 5.3' 16" Hemlock N42°W (14 lks) 9.2'
 Stream 10lks wide East 2ch (132')

Oceana County Remonumentation
 Peer Group Reviewed & Approved
 Date: 11-11-99

Book A, Pg. 176, EM Hyde, 1887; Corner not witnessed.
 Book A, Pg. 178, EM Hyde, 1887; "See Government field notes."
 Book A, Pg. 180, EM Hyde, 1887; "See Government field notes."
 Book C, Pg. 6, HC Salisbury, 1907; "Found post set in place of Government stake. Set 1-1/2" X 3' gas pipe
 Fr wh: 15" Hem. Stump S22°W 27.3' 18" Hem. Stump S36°E 6.8'

J. Randolph Hepworth
 Ocean County Surveyor

Consumer: Power Dwg No. S-F16758 Sheet 22 Corner not in position Reset from 1/16 cor & 1/4 cor to the East

Unrecorded Survey, S. Barnett #16023, 8/79 FD 1-1/2" Pipe 7' N of Trail Road (3) 12" S Pine S76°W 75.86'
 (1) 24" Beech N32°E 57.17' (2) 10" S Pine S20°W 38.00'

Unrecorded Survey, JR Hepworth #26457, 6/83 FD 1-1/4" pipe Same witnesses as S Barnett

B. Description of corner evidence found and/or method applied in restoring or reestablishing corner.

I found a 1-1/2" ID Pipe 9 feet north of centerline E-W dirt trail. Pipe is on trace of old fence lines (lying down) to the south and to the north. Both Salisbury stump witnesses would fall in the trail and are gone. Upon excavation, the pipe was found to be 1-1/2"x3.5' long. This corner is as described by Salisbury, 1907, who stated that he set the pipe at the gov't stake position. GLO calls for a stream crossing East at 2 chains (132'), but it actually measures 160' to the culvert crossing.

I accept the Pipe as the best available evidence of the position of the original corner. No evidence is known to me that would lead me to believe the corner should be at another location.

C. Description of monument for corner and accessories established to perpetuate locating the position of the corner:

Set 4"x20" Harrison Cast Iron Monument, stamped "County Surveyor" and "26457" in place of the pipe. The pipe was too brittle to drive down.

(1)	60d spk	W Face	26" Beech	32°az	57.32'	EDM
(2)	60d spk	NE Face	14" R Pine	206°az	37.68'	EDM
(3)	60d spk	SE Face	14" R Pine	254°az	75.82'	EDM
	60d spk	N Face	5" R Pine	316°az	31.70'	EDM

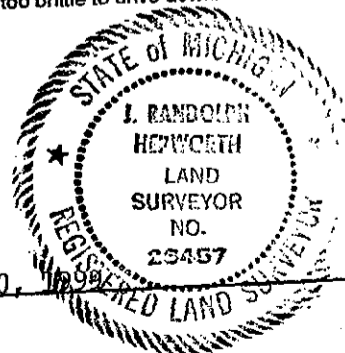

Signed by J. Randolph Hepworth
 Surveyor's Michigan License No. 26457

Date November 30, 1999