

APR 08 1999

Ogemaw County Remonumentation

LAND CORNER RECORDATION CERTIFICATE
Filing Requirement of Act 74, Mich. P.A. 1970

SECTION

3000193

Page: 1 of 1
04/06/1999 11:43A
L-3 P-224

For corners in

Ogemaw
(County)

Located in:

Corner Code #



1. Public Land Survey

T21N R01E A-13

T	R	_____
T	R	_____
T	R	_____
S	T	_____
S	T	_____
S	T	_____
S	T	_____

2. Property Controlling in Section

3. Miscellaneous Property in Sec.

Register of Deeds Stamp & File Number

4. Lot No. _____, Recorded Plat _____
5. Private Claims _____

I, Timothy L Lapham, in a field survey on September, 1998 do hereby state that under requirements of P.A. 74, Michigan P.A. of 1970, the corner points mention in lines 1 and 2 above were in conformance with regulations and rules therefore as required in the current manual of survey instructions of the United States Department of the Interior, Bureau of Land Management or by a decree of a Court of Law and/or that the corner points mentioned in lines 3, 4 and 5 above were in conformance with the rules of the Michigan Board of Land Surveyors or by a Decree of a Court of Law; established, re-established, monumented, recovered, found as expressed below:

NOTE: Not more than 2 corners, all in the same town and range, may be recorded on this certificate

A	B	C	D	E	F	G	H	I	J	K	L	M
1												
2	6		5		4		3		2		1	
3												
4	7		8		9		10		11		12	
5												
6	18		17		16		15		14		13	
7												
8	19		20		21		22		23		24	
9												
10	30		29		28		27		26		25	
11												
12	31		32		33		34		35		36	
13												

A. Description of original monument and accessories and/or subsequent restoration:

A-13: GLO 2/11/1837 J Brink set post
Hemlock 9 N65W 14
Hemlock 10 N87E 23

ESE 12.65' 10" Cedar (1)
SSW 18.20' 10" Cedar (2)
WSW 27.55' 24" N Pine (3)

GLO 1837 L Clason (S line 21N 1E)
same accessories as GLO-Brink

Survey Roscommon Co records 633-167
8/13/1992 J Meyers found old post, same
witnesses as Arieth survey

GLO 3/26/1837 J Brink found post
(S line 21N 1W) no additional accessories

Survey 8/27/1992 J Meyers, found 3/4x44" pipe,
same witnesses as Arieth survey

Survey circa 1950 R Ostling
Found original post, set 4x4 square post
S80W 26.9' 20" N Pine
S16W 13.2' 8" Cedar

Gladwin Co. LCRC 1-102 12/2/1996 M Robison
Set Gladwin Co. remonumentation monument
S15E 24" W Pine 40.70' (4)
N80E 24" W Oak 33.80' (5)
S45W 18" Oak 43.30' (6)
S85W 20" Pine stump (FSA cap) 27.55' (7)

Survey 4/29/1956 R Ostling
same as 1950 Ostling survey

Survey 8/8/1981 F Arieth
Found old post - set 3/4x44" pipe

Gladwin Co. LCRC 1-116 duplicate recording of
LCRC 1-102 information

Approved by Peer Review

12/15/98 TL
DATE INITIALS

B. Description of corner evidence found and/or method applied in restoring or reestablishing corner:

A-13: Found Gladwin County Remon iron and cap with PS No. 27458 and 9433. Iron at fences north, south, east, and west. Witnesses found: (3) and (7) are same witness, stump found; (4) found living tree; (5) found stub; and (6) found stump. Accepted found iron as reestablishment of original corner position.

C. Description of monument for corner and accessories established to perpetuate locating the position of the corner:

A-13: Gladwin County Remon iron and Cap
witnesses:

- S19E 40.70' NAIL IN 24" W. PINE (OBT)
- S47W 43.29' NAIL IN 18" OAK (OBT)
- N72E 33.88' NAIL IN 24" OAK STUB (OBT)
- S88W 27.45' NAIL IN 24" STUMP (OBT)
- S78W 43.14' NAIL IN 8" MAPLE

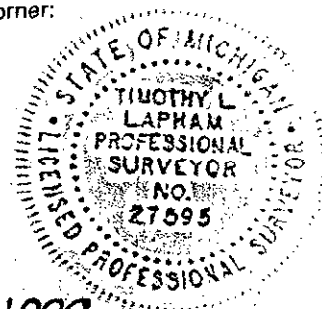

Signed by

Timothy L. Lapham

Date

4/6/1999

Surveyor's Michigan License No.

27595