

SURVEY &
REMONUMENTATION

SEP 28 1998

LAND CORNER RECORDATION CERTIFICATE
Filing Requirement of Act 74, Mich. P.A. 1970

For corners in SECTION

Ogemaw
(County)

Located In:

Corner Code #

LIBER 3 PAGE 175

STATE OF MICHIGAN
OGEMAW COUNTY
RECORDED

7/14/1998 9:26:45 AM

WANDA NUZIK
REGISTER OF DEEDS

Register of Deeds Stamp & File Number

1. Public Land Survey	T <u>22N</u> R <u>1E</u>	<u>A-6</u>
	T _____ R _____	_____
	T _____ R _____	_____
	T _____ R _____	_____
2. Property Controlling in Section	S _____ T _____ R _____	_____
	S _____ T _____ R _____	_____
3. Miscellaneous Property in Sec.	S _____ T _____ R _____	_____
	S _____ T _____ R _____	_____

4. Lot No. _____, Recorded Plat _____
5. Private Claims _____

I, Marvin E. Myers, in a field survey on 4-23, 1998, do hereby state that under requirements of P.A. 74, Michigan P.A. of 1970, the corner points mentioned in lines 1 and 2 above were in conformance with regulations and rules therefore as required in the current manual of survey instructions of the United States Department of the Interior, Bureau of Land Management or by a decree of a Court of Law and /or that the corner points mentioned in lines 3, 4 and 5 above were in conformance with the rules of the Michigan Board of Land Surveyors or by a Decree of a Court of Law; established, re-established, monumented, recovered, found as expressed below:

1	A	B	C	D	E	F	G	H	I	J	K	L	M
2	6		5		4		3		2		1		
3													
4	7		8		9		10		11		12		
5													
6	18		17		16		15		14		13		
7													
8	19		20		21		22		23		24		
9													
10	30		29		28		27		26		25		
11													
12	31		32		33		34		35		36		
13													

NOTE: Not more than 2 corners, all in the same town and range, may be recorded on this certificate.

A. Description of original monument and accessories and/or subsequent restoration:

A-6 GLO - 1937 John Brink, D.S.
Mon. - Post
10" Black Oak S43°W 32 lks.
11" Y. Pine N20°W 57 lks.

L. 1, Pg. 117 (Norman C. Caldwell,
P.S. # 12018 4-18-1966)
Mon. - Found remains of 3"x3" stake 1' East of N-S fence. Set 2" bar.
13" Oak S35°E 23.70'
16" Oak N50°E 47.45'
15" Oak S39°W 67.17'
11" W. Oak N39°W 37.69'

L. 1, Pg. 35 (Larry L. Cavanagh
P.S. #17614 April 3, 1973)
Mon. - Found 5/8" bar
12" B. Oak S25°E 23.68'
12" B. Oak N50°E 47.47'
8" W. Oak N23°W 37.66'

L. 2, Pg. 156
Mon. - 2" bar
13" Oak S35°E 23.70'
16" Oak N50°E 47.45'
15" Oak S39°W 67.17'
11" W. Oak N39°W 37.69'

L3, Pg. 357 (R. L. Higgins, P.S. 21570
April 27, 1982)
Mon - Not given.
Wit: None given.

B. Description of corner evidence found and/or method applied in restoring or reestablishing corner:

Found 5/8" iron inside of 2" Pipe, 0.5' East of North-South fence, and in center of old North-South road corridor. Accepted as the best available evidence of the position of the Original Government Corner. Replaced 5/8" iron with Standard County Monument.

C. Description of monument for corner and accessories established to perpetuate locating the position of the corner:

Mon.- Standard Roscommon County Monument.
Set nail in the NE. side of a 18" White Oak N39°W 38.02'
Set nail in the N. side of a 10" White Oak N76°W 30.00'
Set nail in the S. side of a 14" White Oak S67°E 26.63'
Set nail in the S. side of a 14" Black Oak N80°E 37.18'

Approved by Peer Review
6/2/1998 WU
DATE INITIALS

Signed by Marvin E. Myers
Surveyor's Michigan License No. 31600

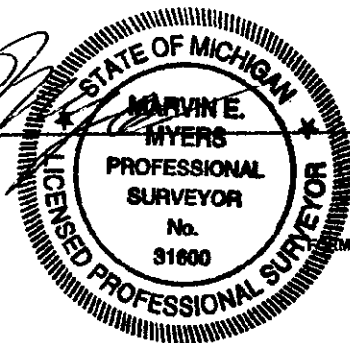

Date June 4th 1998