

**SURVEY &
REMONUMENTATION**

DEC 13 2000

LAND CORNER RECORDATION CERTIFICATE

FILING REQUIREMENT OF ACT 74, Mich. P.A. 1970

SECTION

For corners in <u>Osceola</u>	Located in:	Corner Code#
1. Public Land Survey	<u>T 17 N</u>	<u>R 7 W</u> <u>C-9</u>
	<u>T</u>	<u>R</u>
	<u>T</u>	<u>R</u>
	<u>T</u>	<u>R</u>
2. Property Controlling S in Section	<u>T</u>	<u>R</u>
	<u>S</u>	<u>T</u> <u>R</u>
3. Miscellaneous Property in Sec.	<u>S</u>	<u>T</u> <u>R</u>
	<u>S</u>	<u>T</u> <u>R</u>
4. Lot No. _____ Recorded Plat _____		
5. Private Claims _____		

OSCEOLA COUNTY
REGISTER OF DEEDS

00 OCT 11 AM 9:48

Register of Deeds Stamp & File Number

I, Robert L. Wetherell, in a field survey on May 31, 2000, do hereby certify that under requirements of P.A. 74, Michigan P.A. of 1970, the corner points mentioned in lines 1 and 2 above were in conformance with regulations and rules therefore as required in the current manual of survey instructions of the United States Department of the Interior, Bureau of Land Management or by decree of a Court of Law and/or that the corner points mentioned in lines 3, 4, and 5 above were in conformance with the rules of the Michigan Board of Land Surveyors or by a Decree Of a Court of Law; established, re-established, monumented, re-monumented, recovered, found as expressed below:

	A	B	C	D	E	F	G	H	I	J	K	L	M
1													
2	6	5	4	3	2	1							
3													
4	7	8	9	10	11	12							
5													
6	18	17	16	15	14	13							
7													
8	19	20	21	22	23	24							
9													
10	30	29	28	27	26	25							
11													
12	31	32	33	34	35	36							
13													

C-9 - Section corner common to Sections 19, 20, 29 & 30, T17N, R7W

A. Description of original monument and accessories and/or subsequent restoration:

1848 - O. Lyon, G.L.O.
#1 - 14" Hemlock S43°E 14 Links
#2 - 12" W. Ash N15°W 37 Links

1993 - R.L. Wetherell, LS 24624
L.C.R.C. - Liber 03, Pg. 76
Established by using 1/16 line fences both North and South and the respective 1/4 corner North and South.
#5 - 14" Elm S16°W 147.12'
#6 - 18" Maple S2°E 226.62'
#7 - P. Pole N14°W 117.88'
#8 - 1 1/4' Pipe (W. 1/4 Sec. 29) South 2641.55'

1891-1904 - F. Trumbull
"Identified by Stake"
Set 3" Clay Tile
#3 - 30" Pine Stub S57°W 171 Links
#4 - 4" Aspen S31°E 89 1/4 Links

B. Description of corner evidence found and/or method applied in restoring of reestablishing corner:

I found the 1/2" Capped I set in 1993. I made an extensive dig searching for the clay tile but was unable to locate it. I believe the tile was destroyed by road construction. I measured 2640.11 feet North to the 1/4 corner and 2641.55 feet South to the 1/4 corner. Corner is in the centerline of road North and South.

Condition of the accessories are as follows: #1 Gone, #2 Gone, #3 Gone, #4 Gone, #5 Found dead, #6 Found in good condition, #7 Found in good condition.

C. Description of monument for corner and accessories established to perpetuate locating the position of the corner:

I replaced the 1/2" Rod with a 1" x 18" Pipe with Osceola County Remon Cap, and is accepted as a careful and faithful reestablishment of the position of the original corner.

21" Maple S2°E 226.62' (60d spike in W. side) #6
P. Pole N14°W 117.88' (60d spike in W. side) #7
22" Apple S17°W 268.28' (60d spike in E. side)
S.W. Corner Polc Building N59°E 228.22'

APPROVED LAND CORNER
P.A. 345 OF 1990
Osceola County
R L W
8-17-2000

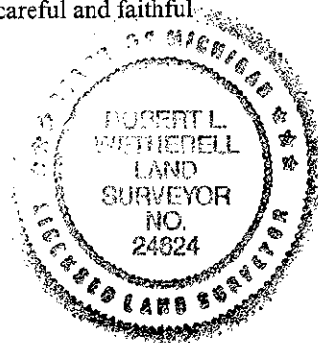

Signed by Robert L. Wetherell
Surveyor's Michigan License No. 24624

Date August 22, 2000