

SURVEY & REMONUMENTATION

NOV 01 1999

SECTION

LAND CORNER RECORDATION CERTIFICATE
Filing Requirement of Act 74, Mich. P.A. 1970

For corners in Osceola Located in: 17N 7W Corner Code # G-2
(County)

1. Public Land Survey
T R
T R
T R
T R

2. Property Controlling in Section
S T R
S T R
S T R
S T R

4. Lot No. , Recorded Plat
5. Private Claims

Register of Deeds Stamp & File Number

1	A	B	C	D	E	F	G	H	I	J	K	L	M
2		6		5		4	●	3		2		1	
3													
4		7		8		9		10		11		12	
5													
6		18		17		16		15		14		13	
7													
8		19		20		21		22		23		24	
9													
10		30		29		28		27		26		25	
11													
12		31		32		33		34		35		36	
13													

I, Robert L. Wetherell, in a field survey on Aug 7, 1998 hereby state that under requirements of P.A. 74, Michigan P.A. of 1970, the corner points mentioned in lines 1 and 2 above were in conformance with regulations and rules therefore as required in the current manual of survey instructions of the United States Department of the Interior, Bureau of Land Management or by a decree of a Court of Law and/or that the corner points mentioned in lines 3, 4 and 5 above were in conformance with the rules of the Michigan Board of Land Surveyors or by a Decree of a Court of Law, established, re-established, monumented, recovered, found as expressed below:

NOTE: Not more than 2 corners, all in the same town and range, may be recorded on this certificate.

E-1 - E. 1/4 Corner of Section 4, T17N, R7W

A. Description of original monument and accessories and/or subsequent restoration:

1848 - O. Lyon

- #1 - 8" Beech N55E 5 Links
- #2 - 20" Sugar S48 1/2W 20 Links

1891 - 1904 - A. Temple/F. Trumbull

- Remonumentation of T17N, R7W
- Set 3" Clay Tiles
- "Stake"
- #3 - 8" Fe Post N89 1/2W 44 1/2" Lks
- #4 - 10" Gate Post S64E 50Lks.

(SEE OVER FOR CONTINUATION OF "A")

B. Description of corner evidence found and/or method applied in restoring or reestablishing corner:

I found the R/R spike. I set in 1998 in C/L of M-66 and in line with old fence to West. Distance to Sec. Corner North is 2664.13' and distance to Sec. Corner South is 2637.68'. The gov't distance for the mile was 5306.40'. This position also fits Lapham's iron on the 1/4 line to the East

Condition of the accessories are as follows: #1 Gone, #2 Gone, #3 Gone, #4 Gone, #5 Found in good condition, #6 Found in good condition, #7 Found in good condition and #8 Bearing N25W Found in good condition.

C. Description of monument for corner and accessories established to perpetuate locating the position of the corner:

I accepted Rail Road Spike as a substantial marker for the corner and is accepted as a careful and faithful monument of the position of the original corner.

- P. Pole S79E 55.28' (Found nail in N. side) #5
- R/W Monument S29W 154.08' (Center) #6
- Cor. Fence Post N85W 61.96' (Found nail in S. side) #7
- 10" Cherry S25W 137.35' (Found nail in SW side) #8

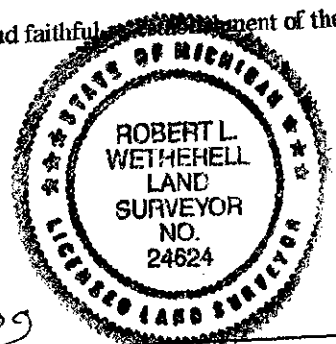

Signed by Robert L. Wetherell Date 8-26-99
Surveyor's Michigan License No. 24624

APPROVED LAND CORNER
P.A. 345 OF 1990
Osceola County

8-26-99
R.L.W.

CONTINUATION OF DESCRIPTION OF ORIGINAL MONUMENT AND ACCESSORIES AND/OR SUBSEQUENT RETORATION.

1978 - P. Lapham LS 9433

Survey Record

L. 358, Pg. 223

Shows iron set on E & W ¼ Line of Sec. 3

1998 - M. McClung LS 13037

2637.86' from SE Cor. Of Sec 4.

(Calculated position, no monument set)

1998- R. Wetherell LS 24624

Unrecorded Survey

Set. RR spike in C/L of M-66 and at a position
N & S by prorating G.L.O. distance.

#5 - P. Pole (Found nail in N. side) S79E 55.28'

#6 - R/W (Center) S29W 154.08'

#7 - Cor. Fence Post (Found nail in S. side) N85W 61.96'

#8 - 10" Cherry (Found nail in SW side) S25E 137.35'

1999 Wetherell LS 24624

Survey Record

L 663, Pg. 238

"Same witnesses as 1998"

Wayne Daugherty
99 SEP - 3 AM 11:48
OSCEOLA COUNTY
REGISTER OF DEEDS

SURVEY &
REMONUMENTATION

NOV 01 1999

SECTION