

**SURVEY &  
REMONUMENTATION**

NOV 01 1999

**LAND CORNER RECORDATION CERTIFICATE  
Filing Requirement of Act 74, Mich. P.A. 1970**

**SECTION**

For corners in  
Osceola

Located In: \_\_\_\_\_ Corner Code # \_\_\_\_\_

(County)

- |                                    |                          |       |
|------------------------------------|--------------------------|-------|
| 1. Public Land Survey              | T <u>17</u> N <u>7</u> W | I-4   |
|                                    | T _____ R _____          | _____ |
|                                    | T _____ R _____          | _____ |
|                                    | T _____ R _____          | _____ |
| 2. Property Controlling in Section | S _____ T _____ R _____  | _____ |
|                                    | S _____ T _____ R _____  | _____ |
| 3. Miscellaneous Property in Sec.  | S _____ T _____ R _____  | _____ |
|                                    | S _____ T _____ R _____  | _____ |

Register of Deeds Stamp & File Number

4. Lot No. \_\_\_\_\_, Recorded Plat \_\_\_\_\_  
5. Private Claims \_\_\_\_\_

I, Robert L. Wetherell, in a field survey on Aug 9, 1999 do hereby state that under requirements of P.A. 74, Michigan P.A. of 1970, the corner points mentioned in lines 1 and 2 above were in conformance with regulations and rules therefore as required in the current manual of survey instructions of the United States Department of the Interior, Bureau of Land Management or by a decree of a Court of Law and /or that the corner points mentioned in lines 3, 4 and 5 above were in conformance with the rules of the Michigan Board of Land Surveyors or by a Decree of a Court of Law, established, re-established, monumented, recovered, found as expressed below:

NOTE: Not more than 2 corners, all in the same town and range, may be recorded on this certificate.

1	A	B	C	D	E	F	G	H	I	J	K	L	M
2		6		5		4		3		2		1	
3													
4		7		8		9		10		11		12	
5													
6		10		17		16		15		14		13	
7													
8		19		20		21		22		23		24	
9													
10		30		29		28		27		26		25	
11													
12		31		32		33		34		35		36	
13													

**I-4 - E 1/4 Corner of Section 10, T17N, R7W**

A. Description of original monument and accessories and/or subsequent restoration:

**1848 - O. Lyon**

- #1 - 16" Sugar S33W 12 Links
- #2 - 20" Hemlock N65W 30 Links

**1891 - 1904 - A. Temple/F. Trumbull**

- Remonumentation of T17N, R7W
- Set 3" Clay Tiles
- "Stake"
- #3- 24" Hemlock stump S58 1/2 E 74 Links.
- #4- 22" Hemlock stump S9 1/2 W 59 Links

**(SEE OVER FOR CONTINUATION OF "A")**

B. Description of corner evidence found and/or method applied in restoring or reestablishing corner:

I found an Osceola County Monument in center of 2-track road North and South and in fence line East & West. I also found 1/2" capped iron (24624) 9.4' West of County monument. I accepted the County Monument as correct and removed my 1/2" iron.

Condition of the accessories are as follows: #1 Gone, #2 Gone, #3 Gone, #4 Gone, #5 Found in good condition, #6 Found in good condition, #7 Found in good condition and #8 Found in good condition. Also, #9 Found in good condition, #10 Found in good condition, #11 Found in good condition and #12 Found in good condition.

C. Description of monument for corner and accessories established to perpetuate locating the position of the corner:

I accept the Osceola County Monument (1 1/2' Pipe with Osceola County Remon Cap), as a substantial marker for the corner and is accepted as a careful and faithful perpetuation of the position of the original corner.

- 55" Oak (with nail side) N40W 28.70' #9
- 38" Oak (with nail SE side) N28E 84.31' #10
- 10" Oak (with nail SW side) S76E 34.80' #11
- 24" Oak (with nail SE side) S80W 39.30' #12

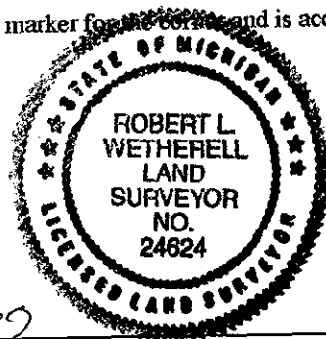

Signed by Robert L. Wetherell  
Surveyor's Michigan License No. 24624

Date 8-26-99

APPROVED LAND CORNER  
P.A. 345 OF 1990  
Osceola County

8-26-99  
R.L.W.

FORM APPROVED BY MICHIGAN STATE BOARD OF PROFESSIONAL SURVEYORS, JAN. 28, 1971  
REVISED MAY 14, 1975  
REVISED JAN., 1983  
REVISED OCT., 1986

CONTINUATION OF DESCRIPTION OF ORIGINAL MONUMENT AND ACCESSORIES AND/OR SUBSEQUENT RETORATION.

1973 - Verba RL 13603

LCRC  
L. 1, Pg 214  
Survey record  
L. 302, Pg 618  
Set Re-bar  
#5 - 36" Oak (nail & tag SE side) Az 35d. 89.54'  
#6 - 8" Oak (nail & tag S. side) Az 250d. 39.92'  
#7 - 40" Oak (nail & tag SW side) Az. 337d 24.57'

1994 Wetherell LS 24624

Survey Records  
L 573, Pg. 329  
Fd. 1/2" iron by Verba  
Added Cap marked LS 24624  
#5 - 34" Oak N42E 89.95'  
#7 - 52" Oak N13W 25.05'  
#6 - 18" Oak S81W 39.99'  
#8 - 7" Oak S82E 43.80'

1998 McClung LS 13037

Survey Records  
L 645, pg. 114  
Fd. Tile and I&C 24624, which was 9.4' West of tile.  
Set Osceola Co. Monument in place of tile  
# 9 - 55" Oak N40W 28.75'  
# 10 - 38" Oak N28E 84.45'  
# 11 - 10" Oak S76E 34.8'  
# 12 - 24" Oak S80W 49.3'

*Yancy Campbell*  
99 SEP -3 AM 11:48  
OSCEOLA COUNTY  
REGISTER OF DEEDS

SURVEY &  
REMONUMENTATION

NOV 01 1999

SECTION