

**SURVEY &
REMONUMENTATION**

DEC 13 2000

LAND CORNER RECORDATION CERTIFICATE

FILING REQUIREMENT OF ACT 74, Mich. P.A. 1970

SECTION

For corners in

| | | |
|--------------------------------------|---------------|--------------|
| Osceola | Located in: | Corner Code# |
| 1. Public Land Survey | T 18 N R 10 W | M-13 |
| | T N R W | |
| | T N R W | |
| | T N R W | |
| 2. Property Controlling in Section | S T R | |
| | S T R | |
| 3. Miscellaneous Property in Sec. | S T R | |
| | S T R | |
| 4. Lot No. _____ Recorded Plat _____ | | |
| 5. Private Claims _____ | | |

OSCEOLA COUNTY
 REGISTER OF DEEDS
 00 NOV - 2 PM 4: 12
Hayes Campbell

Register of Deeds Stamp & File Number

I, Robert L. Wetherell, in a field survey on October 20, 2000, do hereby certify that under requirements of P.A. 74, Michigan P.A. of 1970, the corner points mentioned in lines 1 and 2 above were in conformance with regulations and rules therefore as required in the current manual of survey instructions of the United States Department of the Interior, Bureau of Land Management or by decree of a Court of Law and/or that the corner points mentioned in lines 3, 4, and 5 above were in conformance with the rules of the Michigan Board of Land Surveyors or by a Decree Of a Court of Law; established, re-established, monumented, re-monumented, recovered, found as expressed below:

| | A | B | C | D | E | F | G | H | I | J | K | L | M |
|----|----|----|----|----|----|----|---|---|---|---|---|---|---|
| 1 | | | | | | | | | | | | | |
| 2 | 6 | 5 | 4 | 3 | 2 | 1 | | | | | | | |
| 3 | | | | | | | | | | | | | |
| 4 | 7 | 8 | 9 | 10 | 11 | 12 | | | | | | | |
| 5 | | | | | | | | | | | | | |
| 6 | 18 | 17 | 16 | 15 | 14 | 13 | | | | | | | |
| 7 | | | | | | | | | | | | | |
| 8 | 19 | 20 | 21 | 22 | 23 | 24 | | | | | | | |
| 9 | | | | | | | | | | | | | |
| 10 | 30 | 29 | 28 | 27 | 26 | 25 | | | | | | | |
| 11 | | | | | | | | | | | | | |
| 12 | 31 | 32 | 33 | 34 | 35 | 36 | | | | | | | |
| 13 | | | | | | | | | | | | | |

M-13 - S.W. corner Sec. 36, T18N, R10W

Township corner common to Townships T17N, R10W; T17N R9W; T18N R10W; T 18N R9W

A. Description of original monument and accessories and/or subsequent restoration:

1838 - J. Hodgson, G.L.O.

- #1 - 10" Beech N55°W 33 Links
- #2 - 18" Pine S19°E 16 Links

1891-1904 - Temple/Trumbull

Remonumented T17N R9W,
with 3" Clay Tiles

1977 - James Nordland, LS 16345

Survey recorded L. 338, Pg. 99.
Positioned corner (paper only) by double proportionate method by using corners two miles west, 2 miles South, 1 mile north and 1 mile east.

1988 - R. Hayes - LS 25847

Nordland and Associates
L.C.R.C. - Liber 2, Pg. 284.
Survey recorded Liber 483, Pg. 505.
Set corner at position according to 1977 James Nordland.
#3 - 10" Oak N10°E 25.85'
#4 - 11" Oak S80°E 20.06'
#5 - 5" Poplar S2°W 10.14'
#6 - Pine Stump N60°W 24.68'

B. Description of corner evidence found and/or method applied in restoring or reestablishing corner:

I found R. Hayes ½" capped iron 30 feet South of a old East-West fence (down) and 33 feet more or less West of an old fence running North and South. I disregarded this corner because it was set improperly; surveyor Hayes used the wrong corners in all four directions. In 1997, Matt McClung, Co. Sur., found a ½" rod (standing well above the ground level) next to a fence post 30 feet North of Hayes's corner. He thought the position of this ½" rod should be held for the corner (there was traces of an old fence running South from this ½" rod). I visited the site with Mr. McClung at that time (by his request) and we decided further investigation into the North-South fence, which is 33 feet East of this found ½" rod, should be done. On October 20, 2000, I took a front-end loader and backhoe and excavated the entire area looking for the 3" Clay Tile, which I did not recover. The fence line, 33 feet East of the ½" Iron McClung found, runs for a mile South and a mile North. The ¼ corner and Section corner (both recovered tiles) South of this corner position are both in this old fence line. The ¼ corner North of this position is also in this fence line. I set the corner in this fence line and in line with the old fence to the West. This position fits well with 1/16 line occupation (fence line) to the North. I firmly believe the traces of fence line, which are 33 feet West was a right of way fence.

Condition of the accessories are as follows: #1 Gone, #2 Gone, #3 Found in good condition, #4 Found in good condition, #5 Gone, #6 Found in good condition.

C. Description of monument for corner and accessories established to perpetuate locating the position of the corner:

I set a 1" x 18" pipe with Osceola County Remon Cap, and is accepted as a careful and faithful reestablishment of the position of the original corner.

- 7" R. Oak N7°E 32.32' (60d spike W. side)
- 8" R. Oak N84°E 11.33' (60d spike S. side)
- 14" R. Oak S12°E 13.70' (60d spike E. side)
- 10" R. Oak N79°W 15.03' (60d spike S. side)

APPROVED LAND CORNER
P.A. 345 OF 1990
Osceola County

R. L. W.
10-31-00

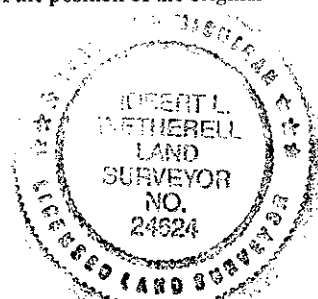

Signed by Robert L. Wetherell
Surveyor's Michigan License No. 24624

Date November 1, 2000

FORM APPROVED BY MICHIGAN STATE BOARD OF LAND SURVEYORS, JAN. 28, 1971
REVISED MAY 14, 1975
REVISED JAN. 1983
ADAPTED FOR WORD PROCESSING JANUARY, 1999