

SURVEY & REMONUMENTATION

DEC 13 2000

SECTION

LAND CORNER RECORDATION CERTIFICATE

FILING REQUIREMENT OF ACT 74, Mich. P.A. 1970

For corners in Osceola Located in: Corner Code#

1. Public Land Survey T 19 N R 9 W K-5
 T R
 T R
 T R

2. Property Controlling in Section S T R
 S T R

3. Miscellaneous Property in Sec. S T R
 S T R

4. Lot No. _____ Recorded Plat _____

5. Private Claims _____

OSCEOLA COUNTY REGISTERED SURVEYOR
 00 OCT 11 AM 9:50
 Register of Deeds Stamp & File Number

I, Robert L. Wetherell, in a field survey on April 10, 2000, do hereby certify that under requirements of P.A. 74, Michigan P.A. of 1970, the corner points mentioned in lines 1 and 2 above were in conformance with regulations and rules therefore as required in the current manual of survey instructions of the United States Department of the Interior, Bureau of Land Management or by decree of a Court of Law and/or that the corner points mentioned in lines 3, 4, and 5 above were in conformance with the rules of the Michigan Board of Land Surveyors or by a Decree Of a Court of Law; established, re-established, monumented, re-monumented, recovered, found as expressed below:

	A	B	C	D	E	F	G	H	I	J	K	L	M
1													
2	6	5	4	3	2	1							
3													
4	7	8	9	10	11	12							
5													
6	18	17	16	15	14	13							
7													
8	19	20	21	22	23	24							
9													
10	30	29	28	27	26	25							
11													
12	31	32	33	34	35	36							
13													

K-5 - Section Corner common to Sections 11, 12, 13 & 14, T19N, R9W

A. Description of original monument and accessories and/or subsequent restoration:

1838 - S. Sibley, G.L.O. #1 - 16" Hemlock N44°E 34 Links #2 - 9" Hemlock N33°E 24 Links	Undated Co. Sur. Twp. Notes "Iron" #6 - W. Ash S80°W 166.2' #7 - P. Pole S12°W 131.2' #8 - Distance West = 2604.7' #9 - Distance North = 2616.8'
1892 - A.O. Temple Co. Sur. Remonumentation of T19N, R9W "Found both Gov't witness trees". Set 3" Clay Tile. #3 - 16" Hemlock S70°E 6 Links #4 - 8" Maple N70°W 16 Links	1953 - G. Blass, LS 5489 Found 3" Clay Tile - Raised with 3/4" iron #13 - 6" Beech N62°E 85.70' #14 - 8" Ash N24°W 86.05' #10 - 6" Birch S55°E 62.50'
1904 - From Co. Sur. Twp. Notes #5 - Distance East 37.06 Chains (2446')	1984 - M. McClung, LS 13037 L.C.R.C. - Liber 02, Pg. 236. "Found Tile and Rod". #6 - W. Ash S80°W 166.20' #7 - P. Pole S12°W 131.50'

1988 - R.L. Wetherell, LS 24624

L.C.R.C. - Liber 02, Pg. 306.
Found 5/8" Iron
#10 - 8" W. Birch S63°E 63.12'
#11 - 10" Maple N3°E 39.17'
#12 - T. Pole S59°W 64.68'

1993 - R.L. Wetherell, LS 24624

Surveys recorded in Liber 567, Pg. 18 and Liber 567, Pg. 21.
Same accessories as 1988.

B. Description of corner evidence found and/or method applied in restoring of reestablishing corner:

I found a 5/8" Sucker Rod directly over the 1/2" rod in 3" Clay Tile (approximately 36" deep) in the centerline of roads East, West and South.

Condition of the accessories are as follows: #1 Gone, #2 Gone, #3 Gone, #4 Gone, #5 Measured 2457.29', #6 Found in good condition, #7 Gone (new pole), #8 Measured 2604.75', #9 Measured 2617.62', #10 Found in good condition, #11 Found in good condition, #12 Found in good condition, #13, Found in good condition, #14 Found in good condition.

C. Description of monument for corner and accessories established to perpetuate locating the position of the corner:

I replaced the 5/8" Sucker Rod with a 1" x 18" Iron Pipe with Osceola County Remon Cap, and is accepted as a careful and faithful perpetuation of the position of the original corner.

18" Beech N60°E 86.04' (60d spike S.E. side)
 7" W. Ash N60°W 54.99' (60d spike S.W. side)
 9" W. Birch S63°E 63.01' (60d spike S. side) #10
 12" Maple N3°E 38.95' (60d spike E. side) #11
 T. Pole S59°W 64.68' (60d spike S. side) #12

APPROVED LAND CORNER
 P.A. 345 OF 1990
 Osceola County
R.L.W.
8-17-00

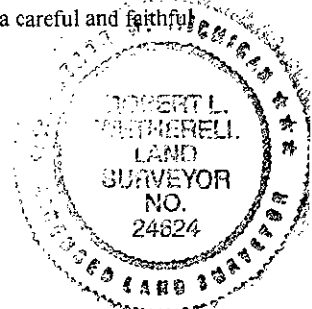

Signed by Robert L. Wetherell
 Surveyor's Michigan License No. 24624

Date August 22, 2000